

Hot Runner Systems

熱流道系統

Simple Solution

SHINI

Contents

02 System Selection Guide

系統選擇指南

04 Open System-SHS12

開放系統-SHS12

09 Open System-SHI12

開放系統-SHI12

14 Open System-SHO12

開放系統-SHO12

17 Valve System-SHV12

針閥系統-SHV12

24 Manifold Block

分流板

26 Technical Specification













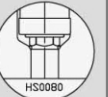
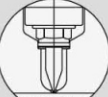

技術規範

System Selection Guide

系統選擇指南

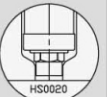
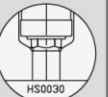
- 1** X12不可用
Not available in X12
- 2** X18不可用
Not available in X18
- 3** X25與X35不可用
Not available in X25 and X35

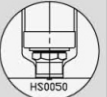
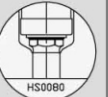
符号 Key	嘴型的适合性 Tip Suitability
✓	可用 Available
★★★★	非常可用 Highest rating
X	不可用 Not Available

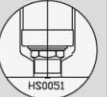
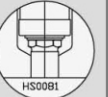
嘴尖 TIPS	級別 Grades			嘴尖類型 Nut Style			可用性 Features		塑料(見3頁) Plastic (Refer to page 3)			
	G1	G4	G5	ONT	BN BE	SN SX / SL	產品質量 Gate Quality	流動性 Flow Rate	容易 Easy	普通 Medium	困難 Difficult	
普遍選型 Thermal Gate	S 多孔嘴尖 Multi Hole Torpedo Tip	✓	✓	✓				★★★★	★★	★★★★★	★★★★★	★★★★★
	S+5 加長嘴尖 Extended Torpedo Tip	✓	✓	X	 3	X	X	★★★★	★★	★★★★★	★★	X
	S+10 加長嘴尖 Extended Torpedo Tip	✓	✓	X		X	X	★★★★	★	★★★★★	★	
	I 單孔嘴尖 Single Hole Torpedo Tip	✓	✓	✓				★★★★	★★	★★★★★	★★★★★	★★★★
	I+5 加長嘴尖 Extended Torpedo Tip	✓	✓	X	 3	X	X	★★★★	★★	★★★★★	★★	X
	I+10 加長嘴尖 Extended Torpedo Tip	✓	✓	X		X	X	★★★★	★	★★★★★	★	X
	O 開放嘴尖 Open Tip	✓	X	✓				★★	★★★★	★★★★★	★★★★	★
針閥選型 Valve Gate	V 針閥嘴尖 Torpedo Tip	✓	X	X	 1	 1	 1	★★★★★	★★★★★	★★★★★	★★★★	★
	VV 開放嘴尖 Open Tip	✓	X	✓	 2	 1	 1	★★★★★	★★★★★	★★★★★	★★★★	★

Some Nozzle Types Selection

部分嘴型的選擇

- 1** G5不可用
Not available in G5
- 2** G2祇在某些產品可用
Only available in G2

符號 Key	嘴型的適合性 Tip Suitability
✓	合適 Suitable
G5	非常適合G5嘴型 Very suitable with Grade 5 tips only
⊙	指定嘴型 Application dependant
G5	Appl指定嘴型與G5嘴型 Application dependant and Grade 5 tip only
X	不合適 Not suitable

原料種類 Material Category		噴嘴系列與嘴型 Nozzle Series and Tip							
		12		18		25		35	
		S I	O VV	S I V ¹	O VV	S I V ¹	O VV	S I V ¹	O VV
容易 Easy	PP	✓	✓	✓	✓	✓	✓	✓	✓
	PE	✓	✓	✓	✓	✓	✓	✓	✓
	PS	✓	✓	✓	✓	✓	✓	✓	✓
	SB	✓	✓	✓	✓	✓	✓	✓	✓
	EVA	✓	✓	✓	✓	✓	✓	✓	✓
普通 Medium	ABS	✓	✓	✓	✓	✓	✓	✓	✓
	AS	✓	✓	✓	✓	✓	✓	✓	✓
	POM	✓	✓	✓	✓	✓	✓	✓	✓
	SAN	✓	✓	✓	✓	✓	✓	✓	✓
	PA6	✓	X	✓	X	✓	X	✓	X
	PMMA	✓	⊙	✓	✓	✓	✓	✓	✓
	ASA	✓	⊙	✓	✓	✓	✓	✓	✓
	TPE	✓	⊙	✓	✓	✓	✓	✓	✓
困難 Difficult	PA66	✓	X	✓	X	✓	X	✓	X
	PBT	✓	X	✓	X	✓	X	✓	X
	PC	✓	⊙	✓	⊙	✓	⊙	✓	⊙
	PPS	✓	⊙	✓	⊙	✓	⊙	✓	⊙
	PPE	✓	⊙	✓	⊙	✓	⊙	✓	⊙
	PPU	✓	⊙	✓	⊙	✓	⊙	✓	⊙
	PET	✓	⊙	✓	⊙	✓	⊙	✓	⊙
	PES	✓	⊙	✓	⊙	✓	⊙	✓	⊙
	PPO	✓	⊙	✓	⊙	✓	⊙	✓	⊙
	LCP	✓	⊙	✓	⊙	✓	⊙	✓	⊙
	PEI	✓	⊙	✓	⊙	✓	⊙	✓	⊙
	PP + FILL	X	X	G5	X	G5	G5	G5	G5
	PA + FILL	X	X	G5	X	G5	X	G5	X
	SAN + FILL	X	X	G5	X	G5	G5	G5	G5
	PA66+FILL	X	X	G5	X	G5	X	G5	X
	PBT + FILL	X	X	G5	X	G5	G5	G5	G5
	PC + FILL	X	X	G5	X	G5	G5	G5	G5
	PPS + FILL	X	X	G5	X	G5	G5	G5	G5
	PPE + FILL	X	X	G5	X	G5	G5	G5	G5
	PPU + FILL	X	X	G5	X	G5	G5	G5	G5
PET + FILL	X	X	G5	X	G5	G5	G5	G5	

SHS12-I TYPE "S" $\phi 12$ mm

<p>編碼原則</p> <p>S H SL 12</p> <p>單嘴/多嘴 S/M Nozzle 咀身長度 Nozzle length 咀身大小 Nozzle size 表示嘴尖類型 Topless tip 熱流道 Hot runner 信舟 SHINZO</p>			<p>● 單嘴用 S S For single nozzle</p>	<p>● 多嘴用 M M For multi nozzle</p>																	
<p>電熱與感溫 HEATER AND THERMOCOUPLE</p> <table border="1"> <tr> <td>電熱 HEATER</td> <td>褐色/黑色 BROWN/BLACK</td> <td>輸出電壓 220V</td> </tr> <tr> <td rowspan="2">感溫 THERMO COUPLE</td> <td>紅色/黑色 RED/BLACK</td> <td>TC+</td> </tr> <tr> <td>藍色/白色 BLUE/WHITE</td> <td>TC-</td> </tr> </table>			電熱 HEATER	褐色/黑色 BROWN/BLACK	輸出電壓 220V	感溫 THERMO COUPLE	紅色/黑色 RED/BLACK	TC+	藍色/白色 BLUE/WHITE	TC-	<p>標準規格R=21.0mm, 其他規格由客戶提供. Standard specification is 21.0mm and other specifications are provided by the clients.</p>	<p>熱嘴需加OR-806"O"形環 O-RING OR-806 Required</p>									
電熱 HEATER	褐色/黑色 BROWN/BLACK	輸出電壓 220V																			
感溫 THERMO COUPLE	紅色/黑色 RED/BLACK	TC+																			
	藍色/白色 BLUE/WHITE	TC-																			
			<p>可互換密封套 TRANSFER SEAL #</p>	<p>可互換嘴型 TRANSFER TIP #</p>																	
			<table border="1"> <tr> <td>密封套A SEAL A</td> <td>澆口 GATE <input type="checkbox"/></td> <td>密封套B SEAL B</td> <td>澆口 GATE <input type="checkbox"/></td> </tr> <tr> <td>HS0060</td> <td>0.8-1.5</td> <td>HS0070</td> <td>1.0-1.5</td> </tr> </table>	密封套A SEAL A	澆口 GATE <input type="checkbox"/>	密封套B SEAL B	澆口 GATE <input type="checkbox"/>	HS0060	0.8-1.5	HS0070	1.0-1.5	<table border="1"> <tr> <td>SEAL A</td> <td>SEAL B</td> <td>SEAL C</td> </tr> <tr> <td></td> <td></td> <td></td> </tr> <tr> <td>HS0060</td> <td>HS0070</td> <td>HS0080</td> </tr> </table>	SEAL A	SEAL B	SEAL C				HS0060	HS0070	HS0080
密封套A SEAL A	澆口 GATE <input type="checkbox"/>	密封套B SEAL B	澆口 GATE <input type="checkbox"/>																		
HS0060	0.8-1.5	HS0070	1.0-1.5																		
SEAL A	SEAL B	SEAL C																			
HS0060	HS0070	HS0080																			

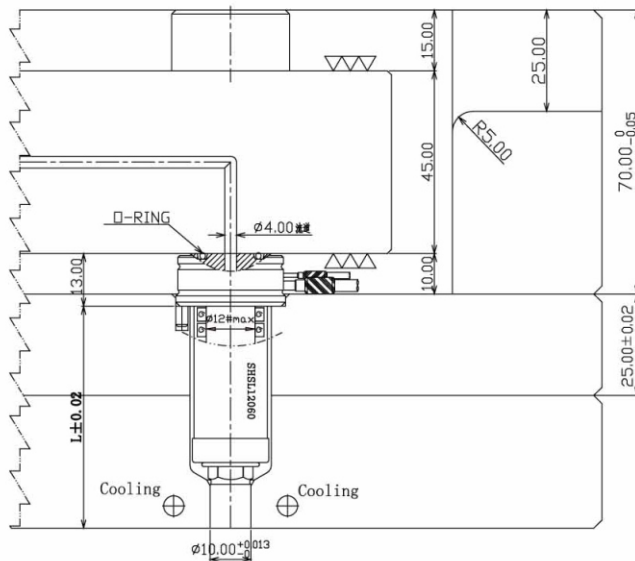

熱咀最小間距
Minimum Nozzle Pitch.

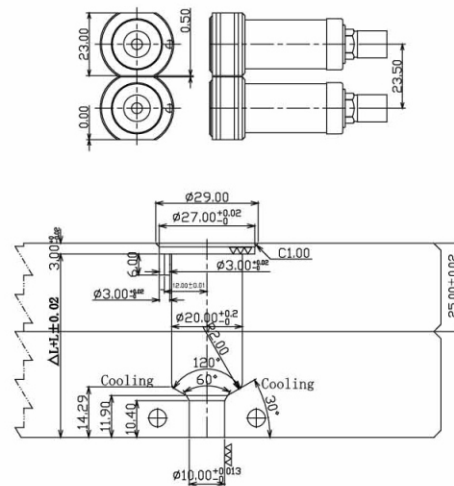

熱咀長度與功率的選擇/NOZZLE LENGTH AND POWER SELECTION							加熱至所需溫度(ΔL) 膨脹量計算公式 THERMAL EXPANSION CALCULATION
NOZZLE#	L	POWER @220V(WATT)	T/C (J/K)	NOZZLE#	L	POWER @220V(WATT)	T/C (J/K)
SHSL12060	60	CH12050140W	SHT10100J/K	SHSL12140	140	CH18137440W	SHT10150J/K
SHSL12080	80	CH12070200W	SHT10100J/K				
SHSL12100	100	CH12090280W	SHT10100J/K				
SHSL12120	120	CH12110340W	SHT10120J/K				

說明: TE=膨脹量
THERMAL EXPANSION(mm)
T=熱嘴溫度 減 一般室溫
T-NOZZLE TEMP-ROOM TEMP
Z=膨脹係數
EXPANSION COEFFICIENT

$$L1=L+TE TE=LxTxZ Z=13.2x10^{-6}$$

SHS12-I TYPE "S" $\phi 12$ mm

<p>編碼原則</p> <p>S H S5 12</p> <p>● 單嘴用 S S For single nozzle</p> <p>● 多嘴用 M M For multi nozzle</p> <p>標準規格R=21.0mm, 其他規格由客戶提供。 Standard specification is 21.0mm and other specifications are provided by the clients.</p> <p>熱嘴需加OR-806"O"形環 O-RING OR-806 Required</p>									
<p>單嘴/多嘴 S/M Nozzle</p> <p>阻身長度 Nozzle length</p> <p>阻身大小 Nozzle size</p> <p>表示嘴尖類型 Tipless tip</p> <p>熱流道 Hot runner</p> <p>信舟 SHINZO</p>									
<p>電熱與感溫 HEATER AND THERMOCOUPLE</p> <table border="1"> <tr> <td>電熱 HEATER</td> <td>褐色/黑色 BROWN/BLACK</td> <td>輸出電壓 220V</td> </tr> <tr> <td rowspan="2">感溫 THERMO COUPLE</td> <td>紅色/黑色 RED/BLACK</td> <td>TC+</td> </tr> <tr> <td>藍色/白色 BLUE/WHITE</td> <td>TC-</td> </tr> </table>		電熱 HEATER	褐色/黑色 BROWN/BLACK	輸出電壓 220V	感溫 THERMO COUPLE	紅色/黑色 RED/BLACK	TC+	藍色/白色 BLUE/WHITE	TC-
電熱 HEATER	褐色/黑色 BROWN/BLACK	輸出電壓 220V							
感溫 THERMO COUPLE	紅色/黑色 RED/BLACK	TC+							
	藍色/白色 BLUE/WHITE	TC-							
<p>可互換密封套 TRANSFER SEAL #</p> <table border="1"> <tr> <td>密封套A SEAL A</td> <td>澆口 GATE</td> </tr> <tr> <td>HS0061</td> <td>0.8-1.5</td> </tr> </table>		密封套A SEAL A	澆口 GATE	HS0061	0.8-1.5				
密封套A SEAL A	澆口 GATE								
HS0061	0.8-1.5								
<p>SEAL A</p>									

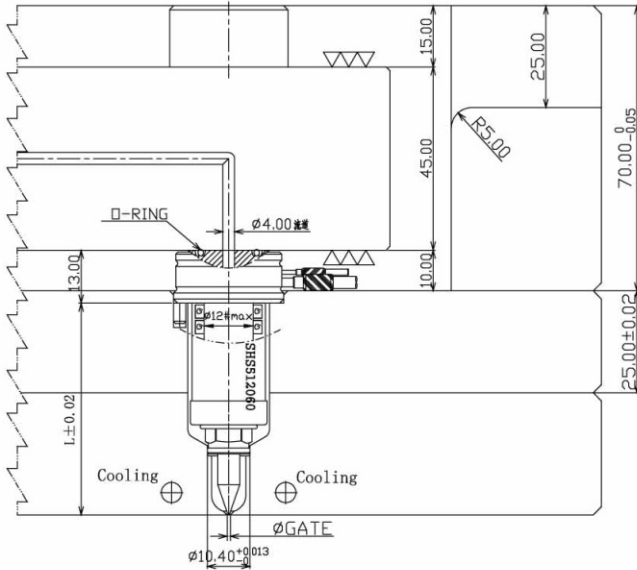

熱阻最小間距
Minimum Nozzle Pitch.

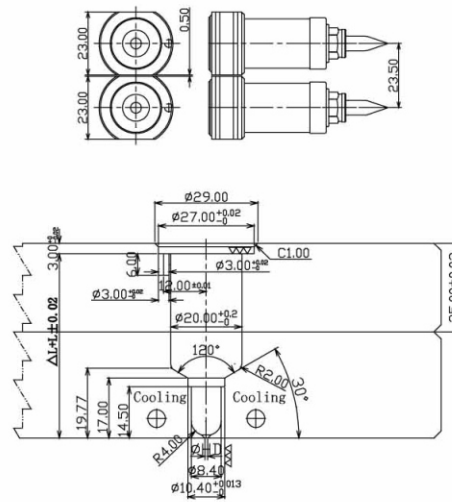

熱阻長度與功率的選擇/NOZZLE LENGTH AND POWER SELECTION				加熱至所需溫度(ΔL) 膨脹量計算公式 THERMAL EXPANSION CALCULATION			
NOZZLE#	L	POWER @220V(WATT)	T/C (J/K)	NOZZLE#	L	POWER @220V(WATT)	T/C (J/K)
SHS512060	60	CH12050140W	SHT10100J/K	SHS12140	140	CH18137440W	SHT10150J/K
SHS512080	80	CH12070200W	SHT10100J/K				
SHS512100	100	CH12090270W	SHT10100J/K				
SHS512120	120	CH12110340W	SHT10120J/K				

說明: TE=膨脹量
THERMAL EXPANSION(mm)
T=熱嘴溫度 減 一般室溫
T=NOZZLE TEMP-ROOM TEMP
Z=膨脹係數
EXPANSION COEFFICIENT

SHI12-I TYPE "I" $\phi 12$ mm

編碼原則

S H IS 12

單嘴/多嘴
S/M Nozzle
咀身長度
Nozzle length
咀身大小
Nozzle size
表示嘴尖類型
Topless tip
熱流道
Hot runner
信舟
SHINZO

**電熱與感溫
HEATER AND THERMOCOUPLE**

電熱 HEATER	褐色/黑色 BROWN/BLACK	輸出電壓 220V
感溫 THERMO COUPLE	紅色/黑色 RED/BLACK	TC+
	藍色/白色 BLUE/WHITE	TC-

**可互換密封套
TRANSFER SEAL #**

密封套A SEAL A	澆口 GATE	密封套B SEAL B	澆口 GATE
HS0063	0.8-1.5	HS0072	1.0-1.5

**可互換嘴型
TRANSFER TIP #**

SEAL A	SEAL B	SEAL C
HS0063	HS0072	HS0082

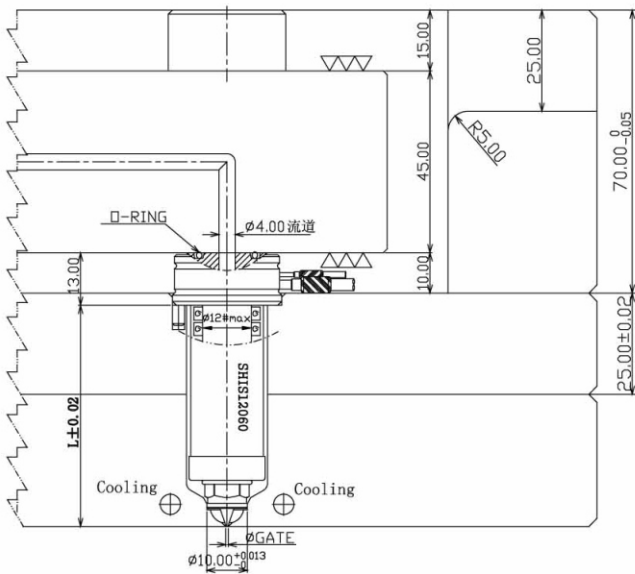

**熱咀最小間距
Minimum Nozzle Pitch.**

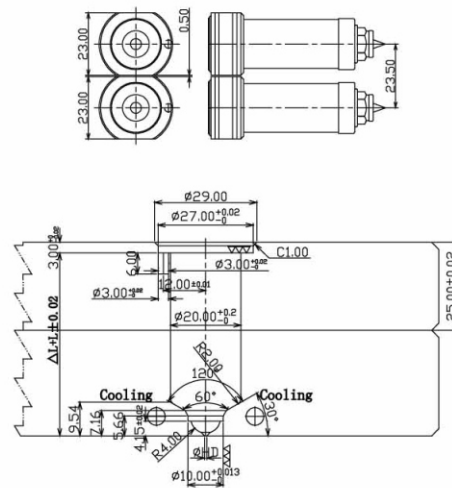

熱咀長度與功率的選擇/ NOZZLE LENGTH AND POWER SELECTION							加熱至所需溫度(ΔL) 膨脹量計算公式 THERMAL EXPANSION CALCULATION
NOZZLE#	L	POWER @220V(WATT)	T/C (J/K)	NOZZLE#	L	POWER @220V(WATT)	T/C (J/K)
SHIS12060	60	CH12050180W	SHT10100J/K	SHIS12140	140	CH18137460W	SHT10150J/K
SHIS12080	80	CH12070250W	SHT10100J/K				
SHIS12100	100	CH12090320W	SHT10100J/K				
SHIS12120	120	CH12110380W	SHT10120J/K				

說明: TE=膨脹量
THERMAL EXPANSION(mm)
T=熱咀溫度 減 一般室溫
T=NOZZLE TEMP-ROOM TEMP
Z=膨脹係數
EXPANSION COEFFICIENT

$L1=L+TE=L+L \times T \times Z=13.2 \times 10^{-6}$

SHI12-I TYPE "I" $\phi 12$ mm

編碼原則

S H IL 12

● 單嘴用 S
S For single nozzle

● 多嘴用 M
M For multi nozzle

標準規格R=21.0mm。其他規格由客戶提供。
Standard specification is 21.0mm and other specifications are provided by the clients.

熱嘴需加OR-806"O"形環
O-RING OR-806 Required

電熱與感溫
HEATER AND THERMOCOUPLE

電熱 HEATER	褐色/黑色 BROWN/BLACK	輸出電壓 220V
感溫 THERMO COUPLE	紅色/黑色 RED/BLACK	TC+
	藍色/白色 BLUE/WHITE	TC-

單嘴/多嘴
S/M Nozzle
咀身長度
Nozzle length
咀身大小
Nozzle size
表示嘴尖類型
Topless tip
熱流道
Hot runner
信舟
SHINZO

可互換密封套
TRANSFER SEAL #

密封套A SEAL A	澆口 GATE	密封套B SEAL B	澆口 GATE
HS0063	0.8-1.5	HS0072	1.0-1.5

可互換嘴型
TRANSFER TIP #

SEAL A	SEAL B	SEAL C
HS0063	HS0072	HS0082

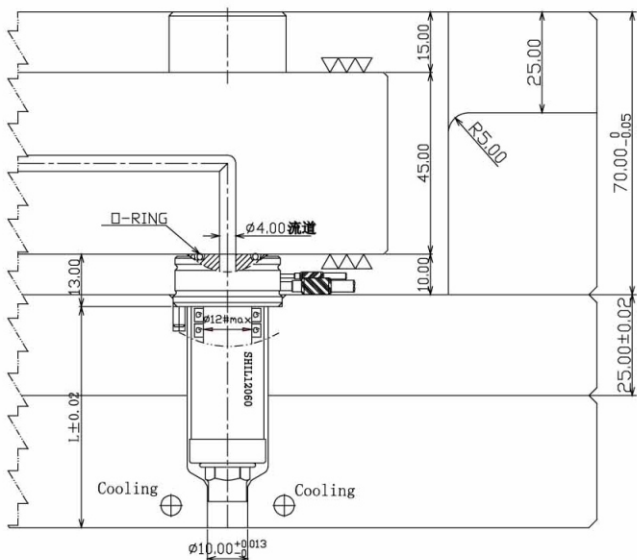

熱咀最小間距 Minimum Nozzle Pitch.

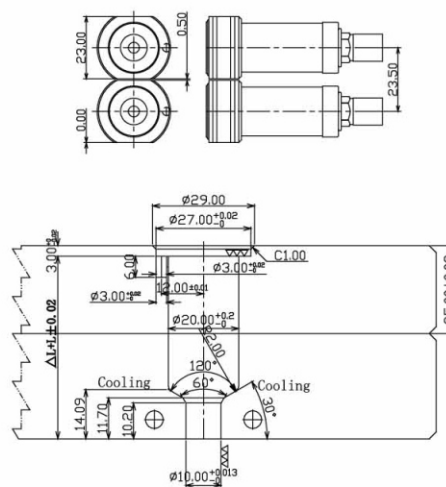

熱咀長度與功率的選擇 / NOZZLE LENGTH AND POWER SELECTION							加熱至所需溫度(ΔL) 膨脹量計算公式 THERMAL EXPANSION CALCULATION	
NOZZLE#	L	POWER @220V(WATT)	T/C (J/K)	NOZZLE#	L	POWER @220V(WATT)	T/C (J/K)	$L1=L+TE TE=LxTxZ=13.2x10^{-6}$ 說明: TE=膨脹量 THERMAL EXPANSION(mm) T=熱咀溫度 減 一檢室溫 T=NOZZLE TEMP-ROOM TEMP Z=膨脹係數 EXPANSION COEFFICIENT
SHIL12060	60	CH12050200W	SHT10100J/K	SHIL12140	140	CH18137440W	SHT10150J/K	
SHIL12080	80	CH12070250W	SHT10100J/K					
SHIL12100	100	CH12090300W	SHT10100J/K					
SHIL12120	120	CH12110360W	SHT10120J/K					

MVG Valve Gate System

氣缸特徵 MVG FEATURES

模具設計

Mould Design

- 使用Mx和BX噴嘴
Available for Mx AND BX Nozzles
- 最小俯仰為75mm可修改為58mm俯仰
Minimal pitching is 75mm-can be modified to fir 58mm pitching
- 易于加工的口徑
Easy machining of the pockets
- 氣動迴路与頂板集成
Pneumatic circuit integrated with the backplate

成型好處

Moulding Benefits

- 部分質量改進
Improved part quality
- 降低注塑壓力
Reduced moulding pressure
- 增加成型窗口
Increased moulding window
- 在下模部分質量較好填充
壓力的結果 Lower mould filling stress results in better part quality
- 減少澆口冷卻要求
Reduced gate cooling requirements
- 在下模部分質量較好填充
壓力的結果 Lower mould filling stress results in better part quality

安裝和維護

Installation and maintenance

- 易于加工和安裝
Easy machining and installation
- 易銷調整和密封更換模具組裝時仍
Easy pin adjustment and seal replacement while the mould remains assemble

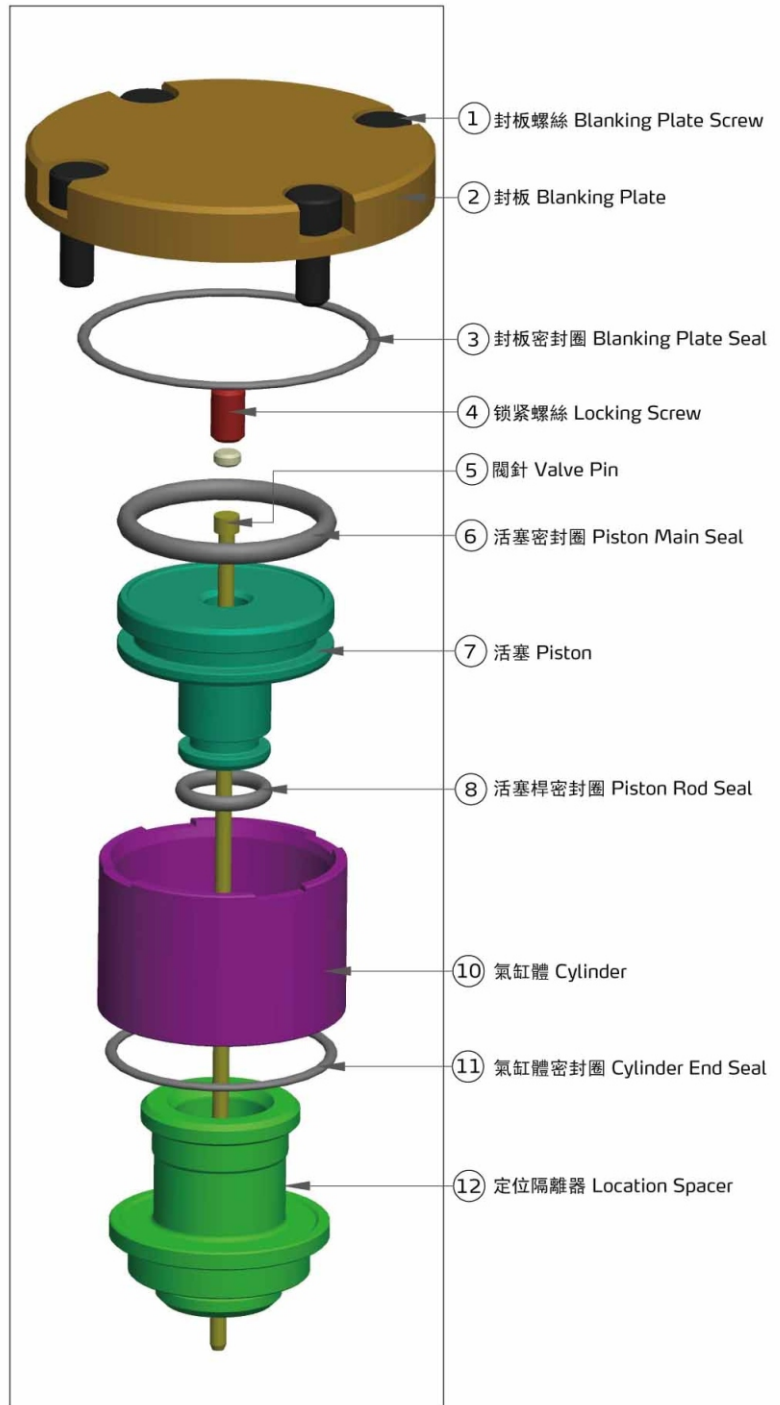

SHML-1 TYPE "I"

編碼原則 	電熱與感溫 HEATER AND THERMOCOUPLE		加熱至所需溫度(ΔL) 膨脹量計算公式 THERMAL EXPANSION CALCULATION
			$L1=L+TE$ $TE=LxTxZ$ $Z=13.2x10^{-6}$
	電熱 HEATER	褐色/黑色 BROWN/BLACK	輸出電壓 220V
	感溫 THERMO COUPLE	紅色/黑色 RED/BLACK 藍色/白色 BLUE/WHITE	TC+ TC-

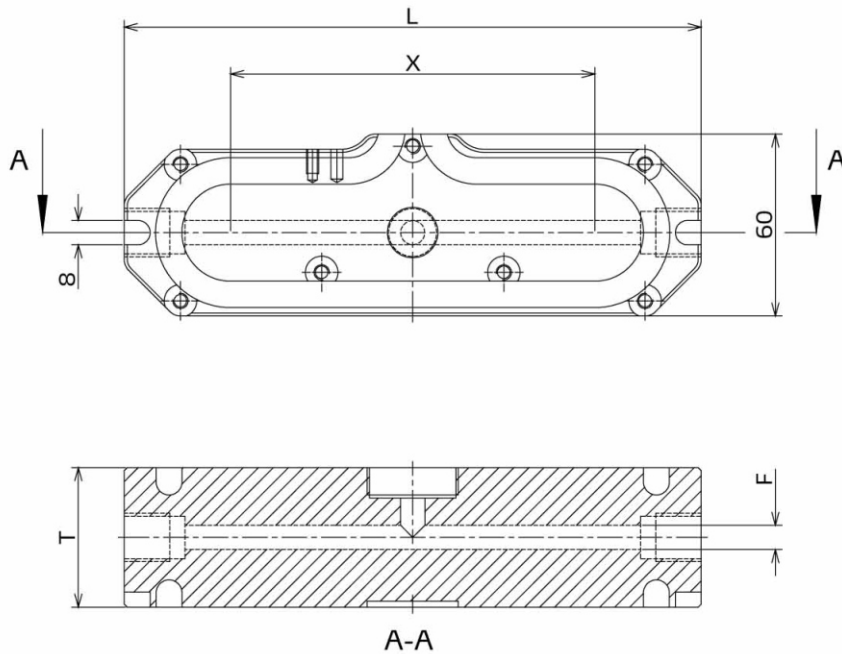

材料 Material 420H/S136H/P20/2316

單位:毫米(mm)

产品代码 Part No.	厚度 T	流道直徑 F(Φ)	L=130 X	L=150 X	L=170 X	L=190 X	L=210 X	L=230 X	L=250 X	L=270 X	L=290 X	L=310 X	L=330 X	L=350 X	L=370 X
ML/3506	35	6	60	80	100	120	140		160	200		240		280	
ML/4508	45	8	60	80	100	120	140		160	200		240		280	
ML/4510	45	10	60	80	100	120	140		160	200		240		280	
ML/5512	55	12			80	100	120	140			200		240		280
ML/5514	55	14			80	100	120	140			200		240		280
ML/5516	55	16			80	100	120	140			200		240		280

備註: X為每兩點間最大距離。
 Note: X is Max.distance between every drop.

Manifold Block 分流板

SHMN-1 TYPE "X"

編碼原則 	電熱與感溫 HEATER AND THERMOCOUPLE		加熱至所需溫度(ΔL) 膨脹量計算公式 THERMAL EXPANSION CALCULATION							
			$L1=L+TE \quad TE=LxTxZ \quad Z=13.2x10^{-6}$							
	<table border="1"> <tr> <td>電熱 HEATER</td> <td>褐色/黑色 BROWN/BLACK</td> <td>輸出電壓 220V</td> </tr> <tr> <td rowspan="2">感溫 THERMO COUPLE</td> <td>紅色/黑色 RED/BLACK</td> <td>TC+</td> </tr> <tr> <td>藍色/白色 BLUE/WHITE</td> <td>TC-</td> </tr> </table>	電熱 HEATER	褐色/黑色 BROWN/BLACK	輸出電壓 220V	感溫 THERMO COUPLE	紅色/黑色 RED/BLACK	TC+	藍色/白色 BLUE/WHITE	TC-	說明: TE=膨脹量 THERMAL EXPANSION(mm) T=熱嘴溫度 減 一般室溫 T=NOZZLE TEMP-ROOM TEMP Z=膨脹係數 EXPANSION COEFFICIENT
電熱 HEATER	褐色/黑色 BROWN/BLACK	輸出電壓 220V								
感溫 THERMO COUPLE	紅色/黑色 RED/BLACK	TC+								
	藍色/白色 BLUE/WHITE	TC-								

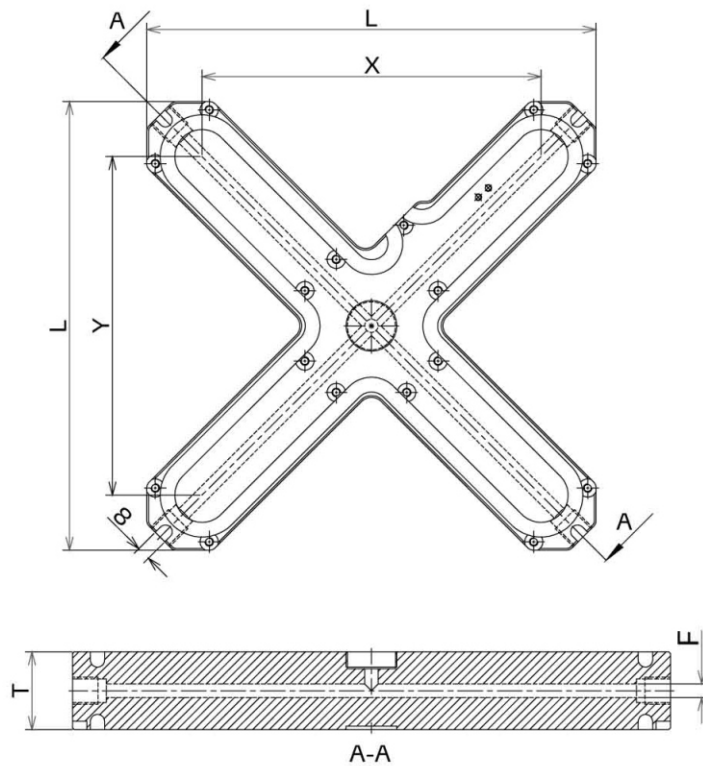

材料 Material 420H/S136H/P20/2316

單位: 毫米(mm)

产品代码 Part No.	厚度 T	流道直徑 F(Φ)	L=125 X/Y	L=145 X/Y	L=165 X/Y	L=185 X/Y	L=205 X/Y	L=225 X/Y	L=245 X/Y	L=265 X/Y	L=285 X/Y	L=305 X/Y	L=325 X/Y
MN/3506	35	6	60	80	100	120	140	160		200		240	
MN/4508	45	8	60	80	100	120	140	160		200		240	
MN/4510	45	10	60	80	100	120	140	160		200		240	
MN/5512	55	12					120	140	160		200		240
MN/5514	55	14					120	140	160		200		240
MN/5516	55	16					120	140	160		200		240

備註: X,Y為每兩點間最大距離。
 Note: X,Y is Max.distance between every drop.

電話 Tel:(86) 0769-8111 5788
傳真 Fax:(86) 0769-8111 5755

網址 URL: <http://www.shini.com>
電郵 Email: alex.liu@cn.shini.com

系統報價申請表

Heatlock Moulding System Quote Request Form

客戶報價號: Customer Quote No:	日期: Date:
公司名稱: Company:	聯繫人: Contact:
公司地址: Address:	
電話: Tel:	傳真: Fax:
電郵: E-mail:	

請提供以下產品資料，以便報價

產品名稱: Product Description:		
膠料 Material: <input type="checkbox"/> 加玻璃纖維 Glass Filled: ____ % <input type="checkbox"/> 防火料 Frame Retardant	<input type="checkbox"/> PP <input type="checkbox"/> PE <input type="checkbox"/> PS <input type="checkbox"/> SB <input type="checkbox"/> EVA <input type="checkbox"/> ABS <input type="checkbox"/> POM <input type="checkbox"/> SAN <input type="checkbox"/> PA6 <input type="checkbox"/> PMMA <input type="checkbox"/> ASA <input type="checkbox"/> CAB <input type="checkbox"/> PBT <input type="checkbox"/> PA66 <input type="checkbox"/> PC <input type="checkbox"/> PC/ABS <input type="checkbox"/> PPS <input type="checkbox"/> PET <input type="checkbox"/> PES <input type="checkbox"/> PPO <input type="checkbox"/> PSU <input type="checkbox"/> PEEK <input type="checkbox"/> LCP <input type="checkbox"/> PEI <input type="checkbox"/> PVC S/H	
單一產品重量: Product Description:	模腔數量: No.Of Cavities:	
單一產品澆口(入水)量: No.Of Gates Per Product:	產品之外型尺寸(長*寬*高): Size Of Product(L * W * H):	產品壁厚: Wall Thickness:
澆口(入水)種類: Description Of Gate Finish:	<input type="checkbox"/> 大水口 Sprue-gate <input type="checkbox"/> 點澆口 Point-gate <input type="checkbox"/> 針閥式 Valve-gate	
產品顏色: <input type="checkbox"/> 透明 Colour: <input type="checkbox"/> Transparency	須經常轉換顏色及膠料: Colour or Material Change Necessary: <input type="checkbox"/> Yse <input type="checkbox"/> No	溫控箱: <input type="checkbox"/> 是 <input type="checkbox"/> 否 Controller: <input type="checkbox"/> Yse <input type="checkbox"/> No
熱上模: <input type="checkbox"/> 是 Hot Half: <input type="checkbox"/> Yse	隔熱板: <input type="checkbox"/> 是 Insulation Plate: <input type="checkbox"/> Yse	操作手冊: <input type="checkbox"/> 中文 <input type="checkbox"/> 英文 Project Book: <input type="checkbox"/> Chinese <input type="checkbox"/> English

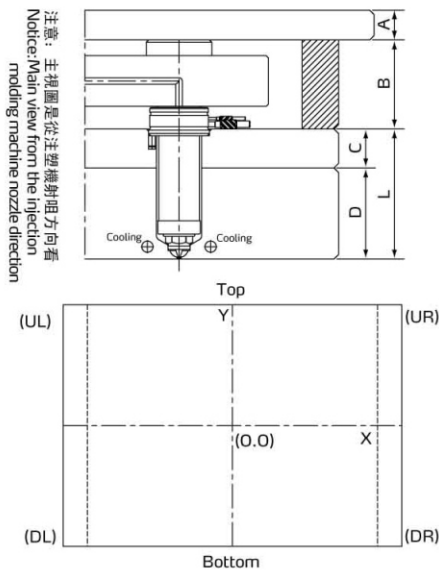

入水數量 No.Of Gates	L (C+D)	位置 Place X	位置 Place Y
G1			
G2			
G3			
G4			
G5			
G6			
G7			
G8			
其它數據 Other Data	A	B	C
	D	E	SR

備註 Remark

制圖/日期 Drawing/date	審核/日期 Audit/date	出貨日期 Shipment/date
制表 Dabulator	銷售工程師 Sales Engineer	交貨日期 Delivery/date

東莞信舟熱流道系統有限公司

地址: 東莞市大朗鎮水口村金朗南路160號

電話: +86(0)769 8111 5788

傳真: +86(0)769 8111 5755

Email: shini@shini.com

Shinzo Hot Runner Systems, Inc

Addr: 160Jinlang South Rd, Dalang, Dongguang

Tel: +86(0)769 8111 5788

Fax: +86(0)769 8111 5755

Email: shini@shini.com

2013-04-15-04 版權所有 翻版必究

www.shini.com