

Robot Selection Guide

■ Traverse Robot

Suitable for pick-up function as well as inserting, stacking and other purpose.

Model: S T □ - □ □ □ □ - □ □ □ □ - □ - □ - □ □ □ □ - □ □ □ □ - □
⑨③ ① ② ⑥ ⑦ ③ ⑤ ②④ ⑧ ⑩

Selection Process

① Y-axis displacement:

Y-axis displacement can be calculated through the equation below with unit of mm. Select a model that satisfy the required displacement. Please refer to robot selection form for meanings of parameters.

$Y_{req} = B + C + \text{thickness of the product}$

② Single or double arms:

Empty: Single arm, suitable for 2-plate-mold or hot runner mold; D: Double arms suitable for 3-plate-mold.

③ Number of servo axis and cycle time:

1: Single axis, for CT > 8 sec; 3: Three axes, for CT > 6 sec; 5: Five axes, double arm, for CT > 6 sec; H at the end: ST3 high speed, CT > 4 sec.

④ Telescopic arm:

Selection based on the height of ceiling. Large and medium robots only have telescopic arm. Empty: Normal arm; T: Telescopic arm, reduce overall height.

⑤ Model and payload:

M: Medium, for payload < 20kg; L: Large, for payload < 30kg; Empty: Small models.

⑥ Design and control:

Empty: Europeanised; S: Standard.

⑦ Options:

M: Middle mold detector.

⑧ Robot-IMM interface:

Empty: Standard; EM12: Euromap 12; EM67: Euromap 67.

⑨ Longitudinal robot:

Traverse robot can be modified to Longitudinal by replace T to L.

⑩ Products to be placed at IMM (___ side)

N: Non-operation side. Empty: Operation side

Transitional Plate of Robots Mounting

Transitional Plate of Robots Mounting

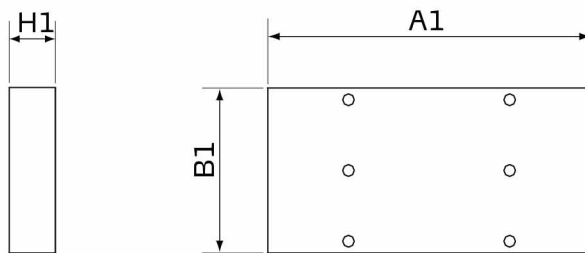

Picture 1

Name	H1 (mm)	A1 (mm)	B1 (mm)	Type of Robots
Transitional Base	30	350	150	Standard Swing-arm

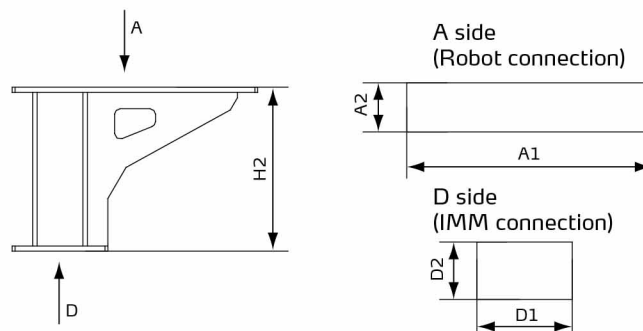

Three/Five Axes Servo Driven Robot adaptor

Picture 2

Name	H2(mm)	Robot Connection		IMM Connection		Type
		A1(mm)	A2(mm)	D1(mm)	D2(mm)	
Transitional Base	550	900	180	350	160	Small-size Five Axes Servo Driven Robot
	600	900	180	350	160	
	650	900	180	350	160	
	700	1500	180	700	180	
	750	1500	180	700	180	Small-size Three Axes Servo Driven Robot

Robot Selection Form

Dear Customers:

To ensure optical use of our equipment, please fill in the form carefully before purchasing our robot. So that we can choose the most suitable product for you. Thank you!

Customer Info.	Company Name		Final Selection	
	Contact	Mobile Phone		

IMM Info.	IMM Manufacturer		Clamping Force	
	IMM Model		IMM Signal	<input type="checkbox"/> Standard <input type="checkbox"/> EM12 <input type="checkbox"/> EM67
	Direction of Placing	<input type="checkbox"/> Operation Side <input type="checkbox"/> Non-operation Side		

Mold Info.	Mold Type	<input type="checkbox"/> 2-plate <input type="checkbox"/> 3-plate <input type="checkbox"/> Hot Runner		
	Mold Displacement		Cavities Number	
	Min. Cycle Time		Suction Surface Dimension	
	Ejection Position	<input type="checkbox"/> Movable Plate <input type="checkbox"/> Fixed Plate		

Robot Installation Surface

IMM Sectional View

Installation Dimension

Type Code	Dimensions
A	
B	
C	
D	
E	
F	
G	
G1	
H	
H1	
I	
J	
K	
L	
M	
N	
O	
P	
Q (Distance between two machines)	
Product Thickness	

Recorder:
Remarks: