

**Technical requirements:**

1. Trimming and deburring;
2. Dimensional tolerances not specified shall be in accordance with GB/T1804-2000 Tolerances for linear and angular dimensions without specified tolerances The M-level regulations.

2	STM-607W-D-B-ALL	internal structure		1	
1	STM-910W-D-A-ALL	External sheet metal		1	
序号	代号	名称	材料	数量	备注

					制图		版号	A	标题	STM-607W-D	图号	STM-607W-D-ALL-ZP	比例	1:10	数量	1
					设计		核		总装图				⊕	材质	/	
	Ver G	Ver H		2024.0222	校对		准		<b>信易電熱機械股份有限公司</b> Shini Plastics Technologies, Inc.	表面要求	/					
标记	更改前	更改后	更改人	日期	审核		日期	20221222		物料号	/					

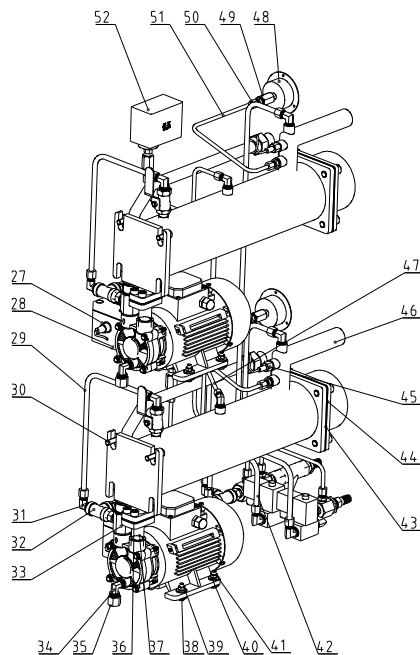
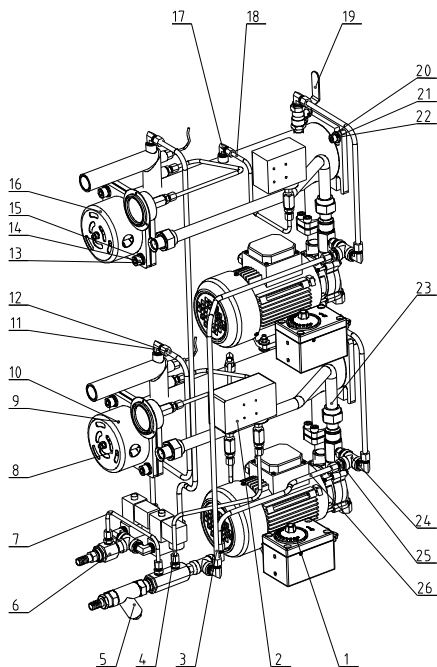

52	YE90000800000	Low pressure switch controller	PVC	1	0-8KG/Auto
51	STM-910W-D-B-04	Pressure gauge pipe	SUS304	2	Borrowed
50	YW05061400000	Sleeve connector		7	6MMX1/4"PT(H59)
49	S-199	H to PT connector	H58	5	1/4"H to 1/4"PT female thread
48	YW85001000100	Pressure gauge		2	0~10MPa Range
47	STM-910W-D-B-03	High pressure pipe 1	SUS304	1	Borrowed
序号	代号	名称	材料	数量	备注

46	STM-607W-D-B-02	Heating Tank		2	Welding parts
45	BE90340200050	Thermocouple	SUS304	2	2M
44	YW66061300000	Flat washer A grade 6	Q235A	2	
43	YR20121200000	Flexible graphite pad	ISO-68	2	120x120x2.0
42	STM-910W-D-B-13	Solenoid valve drainage pipe 2	SUS304	1	Borrowed
41	YW64000600300	Hexagon nut M6	Q235A	10	GB/T6170
40	YW65060000000	Standard spring washer 6	65Mn	8	GB/T93
39	YW66061800000	Large washer A grade	Q235A	16	GB/T96.1(6x18x1.5)
38	YW60062500000	Hexagon screw bolt M6x25	4.8	8	GB/T5781
37	STM-607W-D-B-01	Pump connector		2	Welding parts
36	YR10551500000	Graphite gasket	ISO-68	2	for MP-55
35	S-171	Teflon plug	H58	2	3/8"H plug
34	YW04030800400	Tonflon connector	H58	2	1/4"PTx3/8"H L
33	S-118	Copper joint 1/2PT x 3/4H + 1/4 middle hole 2	H62	2	3/4"H/1/2" PT external tooth 1/4" PT internal tooth
32	YW52030800000	3/8" Stainless steel three-way	SUS304	2	
31	YW05083800100	Sleeve connector		4	8MMX3/8"PT L-type (H59)
30	YW61083000000	Inner hexagon cylindrical screw M8x30	12.9	2	GB/T70.1
29	STM-607W-D-B-04	Hot water bypass	SUS304	2	
28	YW62051000100	Cross socket flat-head screw M5x10	Q235A	4	JIS1111
27	BH90115000050	High-temp. tester		2	EGO
26	STM-607W-D-B-05	Cooling water inlet pipe 1	SUS304	1	
25	YW05083800000	Sleeve connector		2	8MMX3/8"PT (H59)
24	S-50	Copper connector	H58	2	3/8"PTx1/4"PT
23	STM-607W-D-B-03	Return water pipe		2	welding parts
22	YW66081900000	Flat washer 8	Q235A	4	8x19x2.0
21	YW65008000100	Standard spring washer 8	65Mn	4	GB/T93
20	YW61082001200	Inner hexagon cylindrical screw M8x20	12.9	10	GB/T70.1
19	YW50030800900	Ball valve	H58	2	3/8"
18	STM-910W-D-B-05	High pressure pipe 2	SUS304	1	Borrowed
17	YW05061400100	Sleeve connector		2	6MMX1/4"PT L-type(H59)
16	S-190	Heating tube cover	SPCC10	2	
15	YW66102000100	Flat washer A grade 10	Q235A	8	GB/T97.1 (11x20x2)
14	YW61102500000	Inner hexagon cylindrical screw M10x25	12.9	8	GB/T70.1
13	YW65010000000	Standard spring washer 10	65Mn	8	GB/T93
12	STM-910W-D-B-12	Solenoid valve drainage pipe 1	SUS304	1	Borrowed
11	YW05081400000	Sleeve connector		2	8MMX1/4"PT L-type(H59)
10	YW64000600000	Hexagon nut M5	Q235A	22	GB/T6172.1
9	YW66051300000	Flat washer A grade 5	Q235A	12	GB/T97.1 (5.5x10x1)
8	STM-607W-F-ALL	Heating tube assembly		2	welding parts Borrowed
7	STM-910W-D-B-01	Cold water bypass	SUS304	1	Borrowed
6	STM-910W-D-A-09	Cooling water outlet assembly		1	Borrowed
5	STM-910W-D-A-10	Cooling water inlet assembly		1	Borrowed
4	STM-910W-D-B-02	Low pressure pipe	SUS304	1	Borrowed
3	STM-607W-D-B-06	Cooling water inlet pipe 2	SUS304	1	
2	YE90832500000	High and low pressure switch	2024	1	HLP830HME
1	TP-55	TP-55 pump		2	0.55KW 27L/min 3.8bar Anbo
序号	代号	名称	材料	数量	备注

Technical requirements:  
 1. Remove burrs and burrs, and blunt edges;  
 2. Dimensional tolerances not specified should comply with Requirements of GB/T1804-m.

制图	版号	标题	STM-607W-D	图号	STM-607W-D-B-ALL	比例	1:8	数量	1
设计	核准	内部结构						材质	
校对	日期	SHINI		信易塑料机械股份有限公司 Shini Plastics Technologies, Inc.		表面要求			
审核	日期	物料号							
标记	更改前	更改后	更改人	日期	审核				

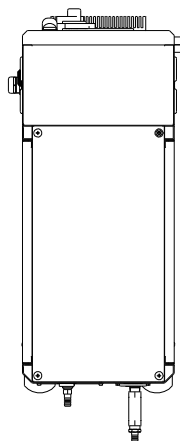
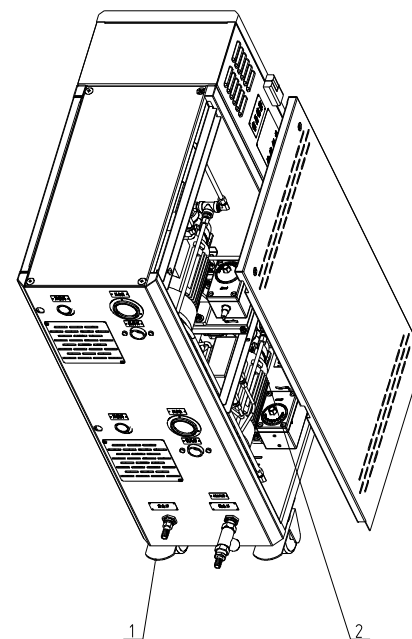
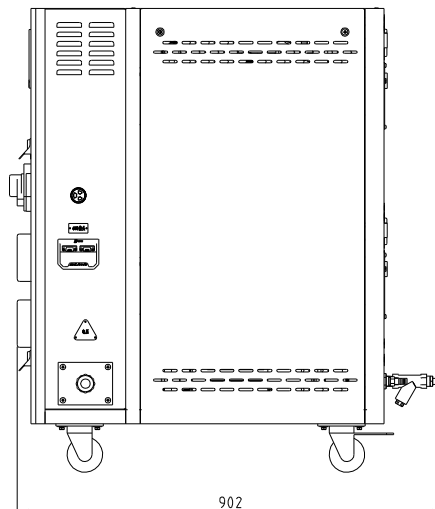
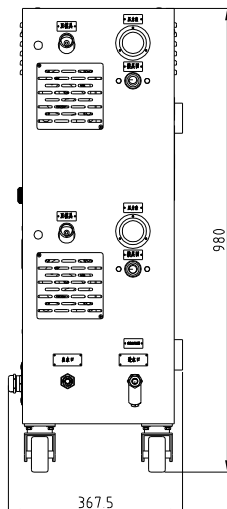

**Technical requirements:**

1. Trimming and deburring;
2. Dimensional tolerances not specified shall be in accordance with GB/T1804-2000 Tolerances for linear and angular dimensions without specified tolerances The M-level regulations.

2	STM-910W-D-B-ALL	Internal structure		1	Structure parts
1	STM-910W-D-A-ALL	External sheet metal		1	
序号	代号	名称	材料	数量	备注

					制图		版号	A	标题	STM-910W-D	图号	STM-910W-D-ALL	比例	1:10	数量	1
					设计		核		组	装					材	/
					校		准								质	/
	Ver G	Ver H		2024.0222	对								表		面	/
标记	更改前	更改后	更改人	日期	审		日	20211216	<b>SHINI</b>	信易电热机械股份有限公司 Shini Plastics Technologies, Inc.		物		料		/

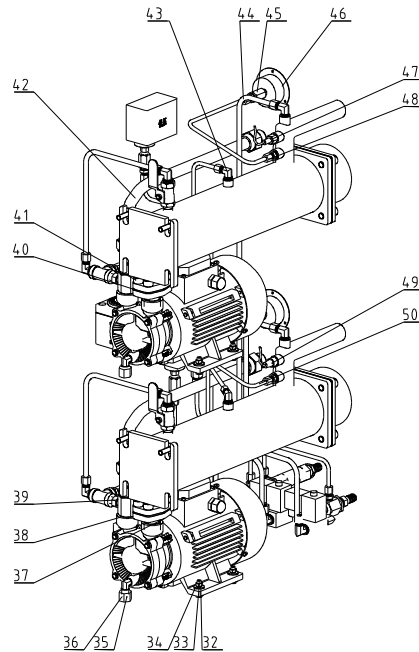
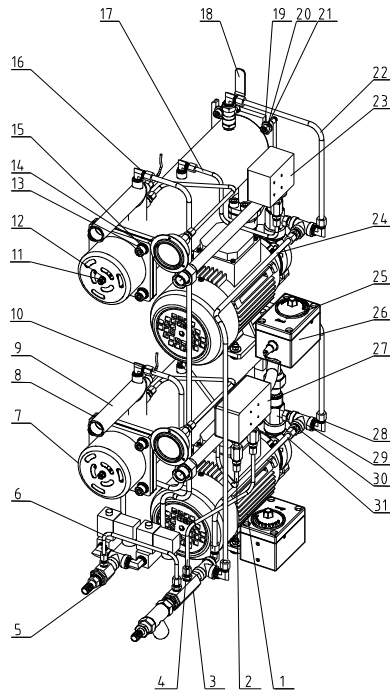

50	STM-910W-D-B-04	Pressure gauge pipe	SUS304	2	Borrowed
49	BE90340200050	Thermocouple	SUS304	1	2M
48	YW05061400000	Sleeve connector		7	6MMX1/4"PT(H59)
47	BE90342500050	Thermocouple	SUS304	1	2.5M
序号	代号	名称	材料	数量	备注

46	YW85001000100	Pressure gauge		2	0-1.0MPa Range
45	S-199	H to PT connector	H58	5	1/4"H to 1/4"PT female thread
44	STM-910W-D-B-13	Solenoid valve drainage pipe 2	SUS304	1	Borrowed
43	YW05061400100	Sleeve connector		2	6MMX1/4"PT L-type (H59)
42	STM-910W-D-B-08	Return water pipe		2	
41	YW60102000000	Inner hexagon cylindrical screw M10x20	12 9	8	GB/T70.1
40	YR10110000000	MP-100 Graphite gasket	ISO-68	2	has mould
39	S-50	Copper connector	H58	2	3/8"PTx1/4"PT
38	S-89	Copper connector (3/4PTx3/4H+1/4 middle hole)	H62	2	3/4"H, 3/4" PT external teeth 1/4"PT internal teeth
37	STM-910W-D-B-07	Pump connector		2	welding parts
36	S-171	Teflon plug	H58	2	3/8"H plug
35	YW04030800200	Tonflon pipe male thread connector	H58	2	3/8Hx1/4PT L-type
34	YW66061800000	Large washer A grade	Q235A	16	GB/T96.1(6x18x15)
33	YW60062500000	Hexagon screw bolt M6x25	4 8	8	GB/T5781
32	YW65060000000	Standard spring washer 6	65Mn	10	GB/T93
31	STM-910W-D-B-10	Water supply pipe 1	SUS304	1	
30	YW05083800000	Sleeve connector		2	8MMX3/8"PT (H59)
29	YW52030800000	3/8" Stainless steel three-way	SUS304	2	
28	YW05083800100	Sleeve connector		4	8MMX3/8"PT L-type (H59)
27	YE90832500000	High and low pressure switch	2024	1	HLP830HME
26	YW62051000100	Cross socket flat-head screw M5x10	Q235A	4	JIS1111
25	BH90115000050	High-temp. tester		2	EGO
24	STM-910W-D-B-09	Water supply pipe 2	SUS304	1	
23	YE90000800000	Low pressure switch controller	PVC	1	0-8KG/Auto
22	STM-910W-D-B-11	Hot water bypass	SUS304	2	
21	YW61083000000	Inner hexagon cylindrical screw M8x30	12 9	4	GB/T70.1
20	YW65008000100	Standard spring washer 8	65Mn	4	GB/T93
19	YW66081900000	Flat washer 8	Q235A	4	8x19x2.0
18	YW50030800900	Ball valve	H58	2	3/8" KITZ heat-resistant 180°
17	STM-910W-D-B-05	High pressure pipe 2	SUS304	1	Borrowed
16	YW05081400000	Sleeve connector		2	8MMX1/4"PT L-type (H59)
15	YW65010000000	Standard spring washer 10	65Mn	8	GB/T93
14	YW66102000100	Flat washer A grade 10	Q235A	8	GB/T97.1(11x20x2)
13	YW61102500000	Inner hexagon cylindrical screw M10x25	12 9	8	GB/T70.1
12	YW66061300000	Flat washer A grade 6	Q235A	2	
11	YW64000600300	Hexagon nut M6	Q235A	10	GB/T6170
10	STM-910W-D-B-12	Solenoid valve drainage pipe 1	SUS304	1	Borrowed
9	STM-910W-D-B-06	Heating Tank		2	welding parts
8	YR20121200000	Flexible graphite pad	ISO-68	2	120x120x2.0
7	S-190	Heating tube cover	SPCC10	2	
6	STM-910W-D-B-01	Cold water bypass	SUS304	1	Borrowed
5	STM-910W-D-A-09	Cooling water outlet assembly		1	Borrowed
4	STM-910W-D-B-02	Low pressure pipe	SUS304	1	Borrowed
3	STM-910W-D-A-10	Cooling water inlet assembly		1	Borrowed
2	STM-910W-D-B-03	High pressure pipe 1	SUS304	1	Borrowed
1	BM200075005050	TP-75 pump	Q235A	2	
序号	代号	名称	材料	数量	备注

Technical requirements:  
 1. Remove burrs and burrs;  
 2. Dimensional tolerances not specified should comply with Requirements of GB/T1804-m.

制图	版号	标题	STM-910W-D	图号	STM-910W-D-B-ALL	比例	数量
设计	核准	内部结构					材质
校对				信易塑料机械股份有限公司 Shini Plastics Technologies, Inc.		表面要求	
标记	更改前	更改后	更改人	日期	审核	日期	物料号

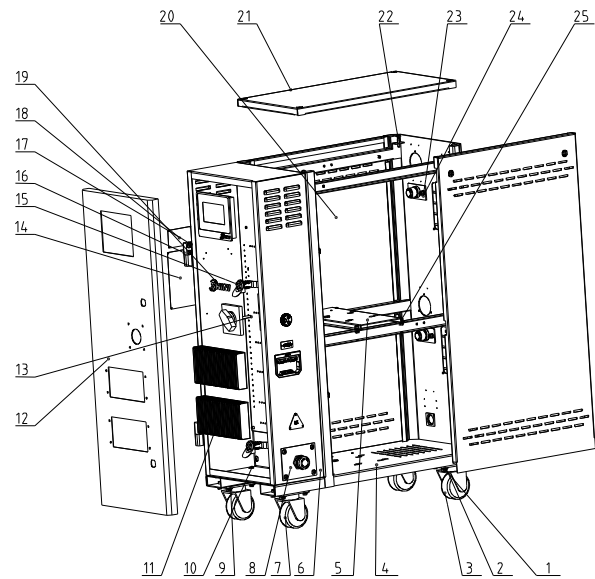
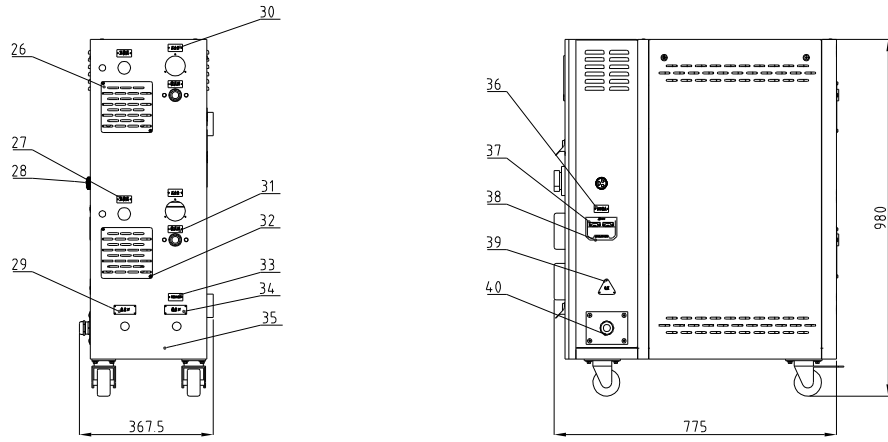

Technical requirements:  
 1. Trimming and deburring;  
 2. Dimensional tolerances not specified shall be in accordance with GB/T1804-2000  
 Tolerances for linear and angular dimensions without specified tolerances  
 The M-level regulations.

40	YE67321500100	Copper nickel plated cable connector	H62	1	
39	YP31051650000	Power aluminum plate label	2024	1	Power triangle 3-phase 400V
38	YR40048500000	Shell RS485		1	
37	YE90048501200	RS485 interface board		1	
36	YP30048500000	Aluminum label	2024	1	485 Communication connector
35	YP30429000000	Aluminum label	2024	1	Drain outlet
34	YP30431000000	Aluminum label	2024	1	Water inlet
33	YP31091040000	Aluminum label	2024	1	Regularly clean the filter
32	YW63040600000	Cross recessed pan head screw M4×6	Q235A	4	GB/T-823
31	YP30422000000	Aluminum label	2024	2	from mould
30	YP30425000000	Aluminum label	2024	2	Pressure gauge
29	YP30430000000	Aluminum label	2024	1	Water outlet
28	YE84003500600	buzzer PK-35A 24V	PVC	1	
27	YP30423000000	Aluminum label	2024	2	To mould
26	STM-910W-D-A-08	Rear panel small cover plate	SPCC15	2	
25	YW64000600300	Hexagon nut M6	Q235A	8	GB/T6170
24	S-66	Water flow distributor joint		2	Welding parts
23	YW66061300000	Flat washer A grade 6	Q235A	12	
22	YW62063000000	Large cross socket flat head screw M6×30	Q235A	8	JIS1111
21	STM-910W-D-A-07	Cover plate	SPCC12	1	
20	STM-910W-D-A-06	Side plate	SPCC12	2	
19	YP30802700000	Shini Trademark	合成纸	1	black
18	YP30437000000	Aluminum label	2024	1	SHINI Nameplate
17	YW62051000100	Large cross socket flat head screw M5×10	Q235A	12	JIS1111
16	YW06203100100	Hinge		2	CL203-1 (left) Shengjiu
15	YW00816100000	Door lock		2	MS816-1 With keys
14	YP31115800600	Aluminum label	2024	1	STM Maintenance
13	STM-910W-D-A-04	Base plate of control box		1	Welding parts
12	STM-910W-D-A-03	Door plank	SPCC15	1	
11	YW90120700000	Aluminum cooler	6061	2	
10	YW62061000000	Large cross socket flat head screw M6×10	Q235A	10	JIS1111
9	YW66061800000	Large washer A grade	Q235A	16	GB/T96 1(6×18×15)
8	SG-S-01	Wire fixture fixed plate	SPCC2.0	1	
7	YW03000300200	3" Without castor with brake	Q235A	2	
6	STM-910W-D-A-02	Control box	SPCC2.0	1	Borrowed
5	STM-910W-D-A-05	Support plate	SPCC2.0	1	
4	STM-910W-D-A-01	Rack		1	Welding parts
3	YW03000300000	3" With castor with brake	Q235A	2	
2	YW60061500100	Hexagon screw bolt M6x16	12.9	24	GB/T5783
1	YW65060000000	Standard spring washer 6	65Mn	24	GB/T93

序号	代号	名称	材料	数量	备注
A	标题	STM-910W-D	图号	STM-910W-D-A-ALL	比例 1:13 数量 1
		外部钣金			材质 /
		见本图	2024.02.22	校对	表面要求 /
标记	更改前	更改后	更改人	日期	审核
				日期	20211216



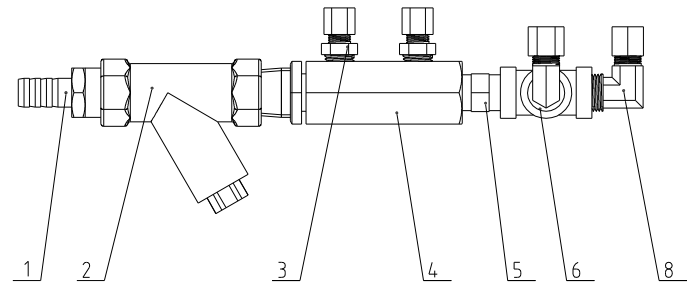
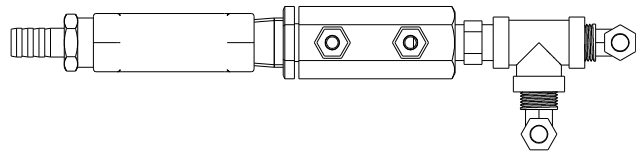
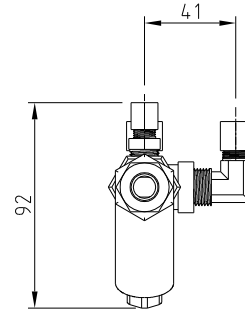
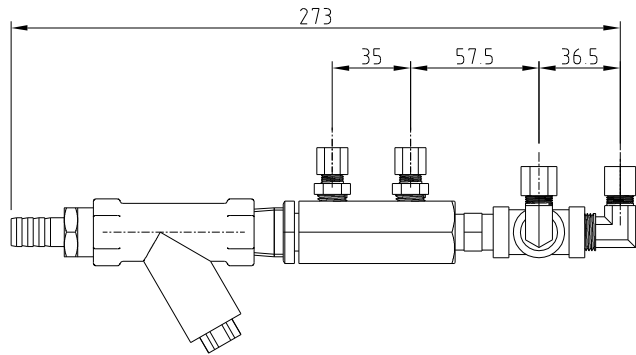

**Technical requirements:**

1. Remove burrs and burrs;
2. Dimensional tolerances not specified should comply with Requirements of GB/T1804-m.

8	YW05083800100	Sleeve connector		2	8MMX3/8"PT L-type (H59)
6	YW52030800000	3/8" stainless steel three-way	SUS304	1	
5	S-07	Copper pipe coupler	H58	1	3/8"PTx3/8"PT
4	S-137	First set of copper joints		1	2-1/4"PT
3	YW05061400000	Sleeve connector		2	6MMX1/4"PT(H59)
2	YW57010200000	Y Type Strainer	H62	1	1/2" PT 30-35 mesh
1	S-73	Copper joint	H62	1	M13x1/2"PT
序号	代 号	名 称	材 料	数 量	备 注

					制图		版号		标题	STM-910W-D	图号	STM-910W-D-A-10	比例		数量	
					设计		核		冷却水进水接口组合					材质		
					校对		准		信易電熱機械股份有限公司 Shini Plastics Technologies, Inc.		表面要求					
标记	更改前	更改后	更改人	日期	审核		日期						物料号			

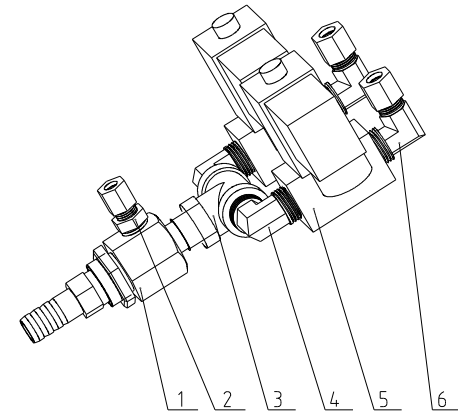
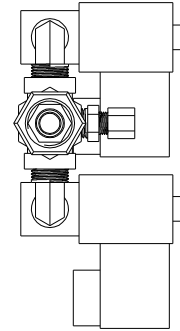
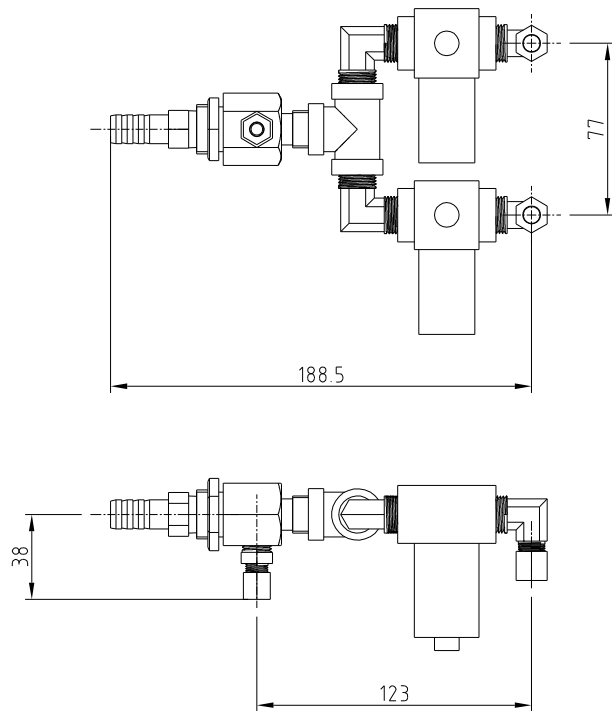

**Technical requirements:**

1. Remove burrs and burrs;
2. Dimensional tolerances not specified should comply with Requirements of GB/T1804-m.

6	YW05083800100	Sleeve connector		2	8MMX3/8"PT L-type (H59)
5	YE32203000900	Solenoid valve		2	3/8" Air TAC 24VAC
4	YW04030800100	Pipe coupler	H62	2	3/8"PT(L)
3	YW52030800000	3/8" stainless steel three-way	SUS304	1	
2	YW05061400000	Sleeve connector		1	6MMX1/4"PT(H59)
1	S-141	The third-set of the copper connector		1	
序号	代号	名称	材料	数量	备注

					制图		版号		标题	STM-910W-D	图号	STM-910W-D-A-09	比例		数量	
					设计		核准		冷却水出水接口组合					材质		
					校对				信易電熱機械股份有限公司 Shini Plastics Technologies, Inc.		表面要求					
标记	更改前	更改后	更改人	日期	审核	日期					物料号					

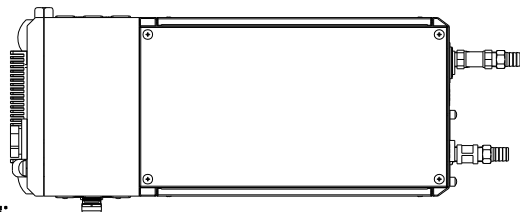
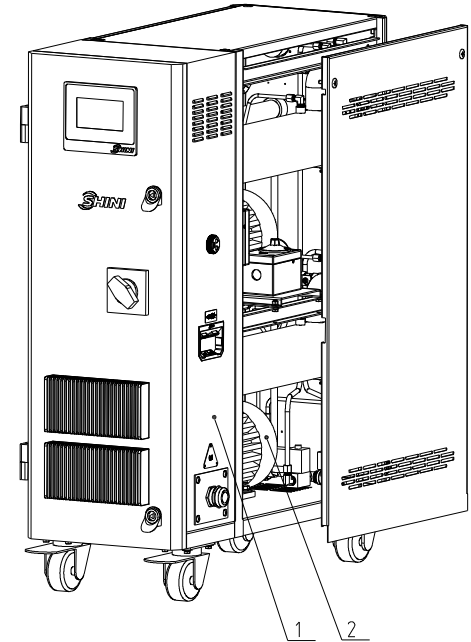
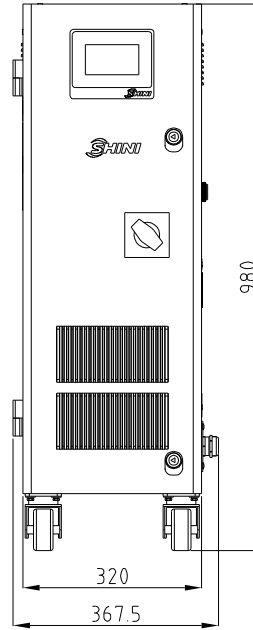
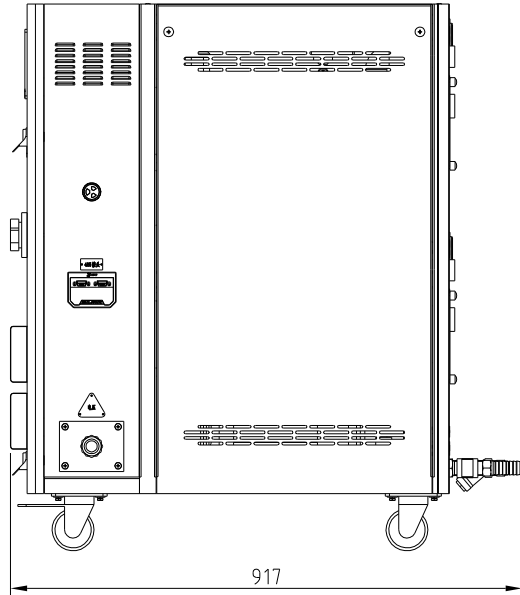

**Technical requirements:**

1. Unmarked dimensional tolerances shall be in accordance with the m-level provisions of GB/T1804-2000 "Tolerances for Linear and Angular Dimensions without Specified Tolerances".

2	STM-1220W-D-B-ALL	internal structure		1	Assembly
1	STM-1220W-D-A-ALL	Shell sheet metal		1	Assembly
序号	代号	名称	材料	数量	备注

					制图	版号	A	标题	STM-1220W-D	图号	STM-1220W-D-ALL-ZP	比例	1:12	数量	1
					设计	核准		双段水式模具控温机				表面要求		材质	/
		Ver.B		2024.0221	校对	核准		 信易電熱機械股份有限公司 Shini Plastics Technologies, Inc.				表面要求		物料号	/
标记	更改前	更改后	更改人	日期	审核	日期	20210714								



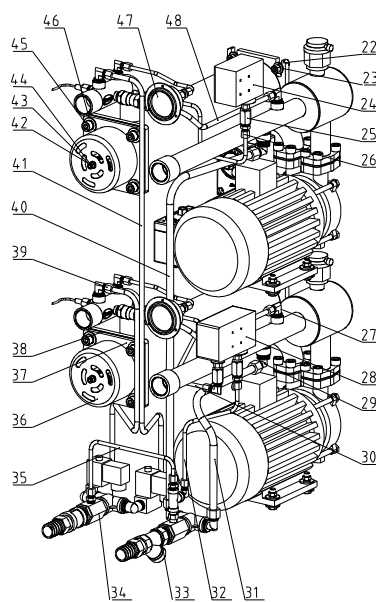
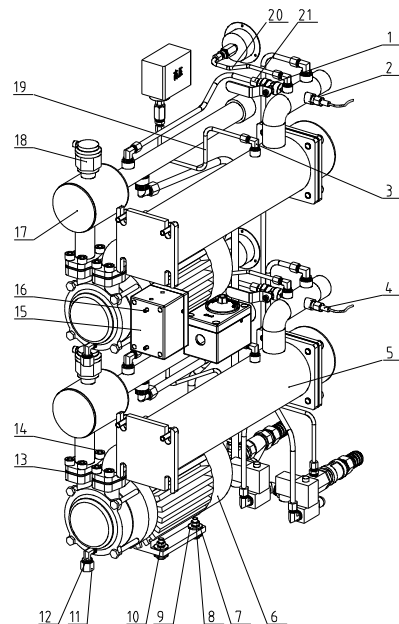
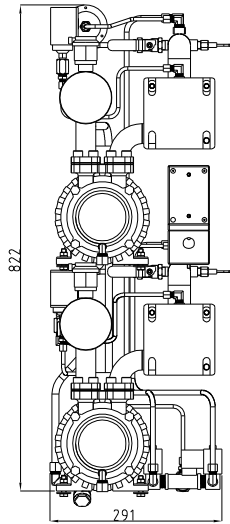
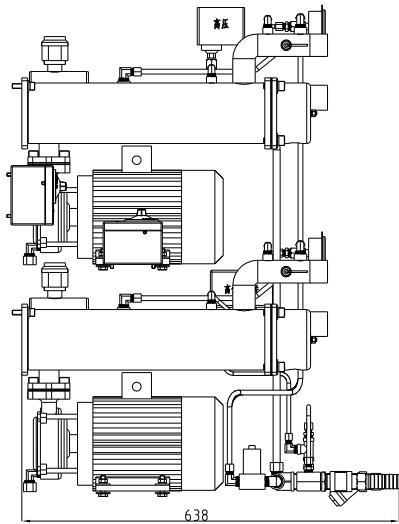

48	STM-1220W-D-B-10	Hot water bypass	SUS304	2	
47	YW85001000100	Pressure gauge		2	0~1.0MPa Range
46	YW66102500000	Flat washer 10x25x1.5	Q235A	8	
45	YW65010000000	Standard spring washer 10	65Mn	8	GB/T93
44	YW64000600300	Hexagon nut M6	Q235A	4	GB/T6170
43	YW65060000000	Standard spring washer 6	65Mn	2	GB/T93
42	YW66061300000	Flat washer A grade 6	Q235A	4	
41	STM-1220W-D-B-09	Air exhaust pipe 2	SUS304	1	
40	STM-1220W-D-B-07	Water inlet pipe 2	SUS304	1	
39	STM-1220W-D-B-08	Air exhaust pipe 1	SUS304	1	
38	YR20121200000	Flexible graphite pad	ISO-68	2	120x120x2.0
37	STM-1220W-F-ALL	Schematic diagram of electric heating tube welding		2	welding parts Borrowed
36	S-190	Heating tube cover	SPCC1.0	2	
35	STM-1220W-D-B-05	Cooling water bypass pipe	SUS304	1	
34	STM-1220W-D-B-04	Drainage joint component		1	Assembly
33	STM-1220W-D-B-03	Water inlet joint component		1	Assembly
32	STM-1220W-D-B-13	Low pressure pipe	SUS304	1	
31	STM-1220W-D-B-06	Water inlet pipe 1	SUS304	1	
30	STM-1220W-D-B-11	High pressure pipe 1	SUS304	1	
29	YW05121200100	Sleeve connector		2	12MMX1/2"PT L-type (H59)
28	YE90832500000	High and low pressure switch	2024	1	HLP830HME
27	YW05083800100	Sleeve connector		4	8MMX3/8"PT L-type (H59)
26	YW05061400000	Sleeve connector		4	6MMX1/4"PT (H59)
25	S-199	H to PT connector	H58	5	1/4"H to 1/4"PT female thread
24	YE90002000000	Pressure switch controller HLP520H	PVC	1	5~20KG self-recovery
23	YW61083000000	Inner hexagon cylindrical screw M8x30	12.9	4	GB/T770.1
22	YW66081900000	Flat washer 8	Q235A	4	8x19x2.0
21	YW05083800000	Sleeve connector		2	8MMX3/8"PT (H59)
20	STM-1220W-D-B-14	Pressure gauge pipe	SUS304	2	
19	STM-1220W-D-B-12	High pressure pipe 2	SUS304	1	
18	YW59001500200	Auto Air exhaust valve DN15	Cu	2	
17	STM-1220W-D-B-02	Return water pipe		2	Welding parts
16	YW62051000100	Cross socket flat-head screw M5x10	Q235A	4	JIS1111
15	BH90115000250	High-temp. tester		2	EGO
14	YW61102500000	Inner hexagon cylindrical screw M10x25	12.9	24	GB/T770.1
13	YR10150000000	Flange gasket	ISO-68	4	TP-150-A-18 (has mould)
12	YW04030800400	Tonflon connector	H58	2	1/4"PTx3/8"H L
11	S-171	Teflon plug	H58	2	3/8"H plug
10	YW64080600000	Hexagon nut M8	Q235A	8	GB/T6170
9	YW66082200100	Large washer C grade	Q235A	16	GB/T968(8.4x24x2)
8	YW65008000100	Standard spring washer 8	65Mn	12	GB/T93
7	YW60083000200	Hexagon screw bolt M8x30	4.8	8	GB/T5783
6	TP-150	pump	Q235A	2	TP-150 Anbo
5	STM-1220W-D-B-01	Heating Tank		2	Welding parts
4	BE90340200050	Thermocouple	SUS304	1	2M
3	YW05061400100	Sleeve connector		5	6MMX1/4"PT L-type (H59)
2	BE90342500050	Thermocouple	SUS304	1	2.5M
1	YW50030800900	Ball valve	H58	2	3/8" KITZ anti-temp. 180°

序号	代号	名称	材料	数量	备注
	STM-1220W-D	内架结构	STM-1220W-D-B-ALL	比例 1:8	数量 1
				表面要求	物料号

制图	王泽文	版号	0			
设计	王泽文	核准				
校对						
标记	更改前	更改后	更改人	日期	审核	日期
						20210715



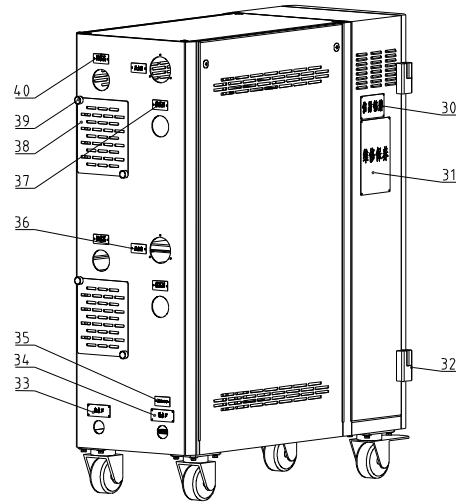
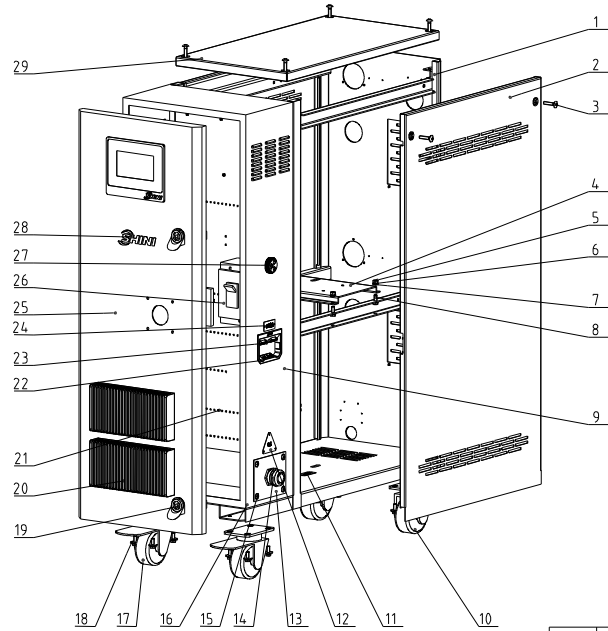
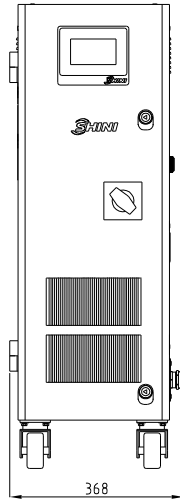
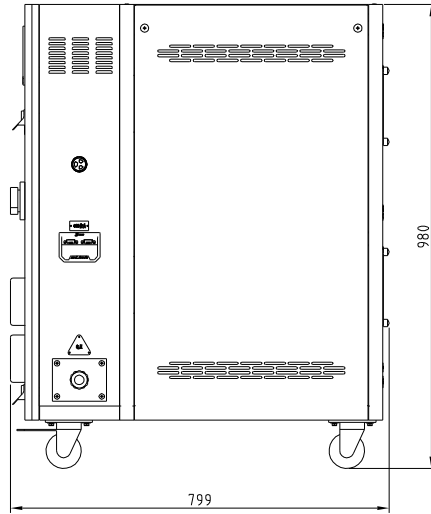

40	YP30423000000	Aluminum label	2024	2	To mould
39	YW69461600000	Hand screw M4*6*16	SPCC2.5	4	
38	STM-1220W-D-A-08	Rear panel small cover plate	SPCC12	2	
37	YP30422000000	Aluminum label	2024	2	from mould
36	YP30425000000	Aluminum label	2024	2	Pressure gauge
35	YP31091040000	Aluminum label	2024	1	Regularly clean the filter
34	YP30431000000	Aluminum label	2024	1	Water inlet
33	YP30430000000	Aluminum label	2024	1	Water outlet
32	YW06203100400	Hinge		2	CL203-1 (left) Shengjiu
31	YP31115800600	Aluminum label	2024	1	STM Maintenance
30	YP30804900700	Aluminum label	2024	1	SHINI Nameplate
29	STM-1220W-D-A-07	Cover plate	SPCC12	1	
28	YP30802700000	Shini Trademark		1	black
27	YE84003500600	buzzer PK-35A 24V	PVC	1	
26	YE40100300100	Dongyuan Circuit Breaker	Q235A	1	
25	STM-1220W-D-A-03	Door plank	SPCC15	1	
24	YP30048500000	Aluminum label	2024	1	485 Communication connector
23	YE90048501200	RS485 interface board		1	
22	YR40048500000	Shell RS485		1	
21	STM-1220W-D--A-04	Electrical base plate		1	Welding parts
20	YW90120700000	Aluminum cooler	6061	2	
19	YW00816100000	Door lock		2	MS816-1 With keys
18	YW66061800000	Large washer A grade	Q235A	16	GB/T96.1(6×18×1.5)
17	YW03000300000	3" Equipped with brake casters	Q235A	2	
16	YW62061000000	Large cross socket flat head screw M6x1	Q235A	4	JIS1111
15	YW62051000100		Q235A	4	JIS1111
14	YE67321500100	Copper nickel plated cable connector	H62	1	
13	SG-S-01	Wire fixture fixed plate	SPCC2.0	1	
12	YP31051650000	Power aluminum plate label	2024	1	Power triangle 3-phase 400V
11	YP30429000000	Aluminum label	2024	1	Drain outlet
10	YW03000300200	3" Without castor with brake	Q235A	2	
9	STM-1220W-D-A-02	Control box	SPCC15	1	
8	YW60061500100	Hexagon screw bolt M6x16	12 9	20	GB/T5783
7	YW66061300000	Flat washer A grade 6	Q235A	8	
6	YW65006000100	Standard spring washer 6	65Mn	20	GB/T93
5	YW64000600300	Hexagon nut M6	Q235A	8	GB/T6170
4	STM-1220W-D-A-05	Pump fixing plate	SPCC2.0	1	
3	YW62063000000	Large cross socket flat head screw M6x30	Q235A	8	JIS1111
2	STM-1220W-D-A-06	Side plate	SPCC12	2	
1	STM-1220W-D-A-01	Rack		1	Welding parts
序号	代号	名称	材料	数量	备注

**Technical requirements:**

1. Trimming and deburring;
2. Dimensional tolerances not specified shall be in accordance with GB/T1804-2000 "Tolerances for Linear and Angular Dimensions without Specified Tolerances" The M-level regulations.

				制图	版号	A	标题	STM-1220W-D	图号	STM-1220W-D-A-ALL	比例	1:10	数量	1
				设计	核准		外壳钣金						材质	/
		见本图		2024.02.21	校对								表面要求	/
标记	更改前	更改后	更改人	日期	审核	日期	20210714	信易电热机械股份有限公司 Shini Plastics Technologies, Inc.			物料号		/	

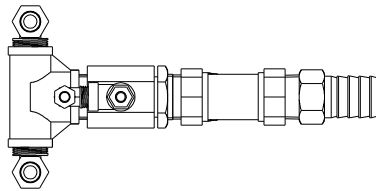
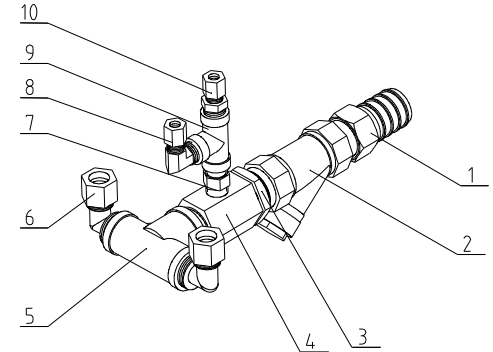
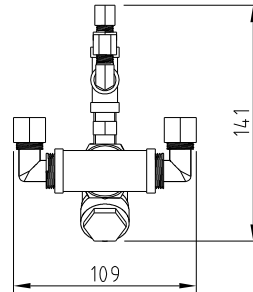
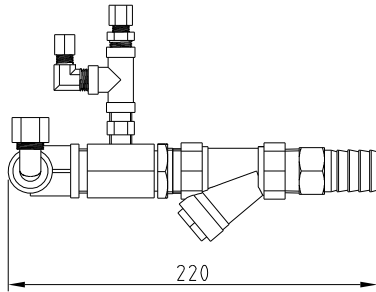

10	YW05061400000	Sleeve connector		1	6MMX1/4'' PT (H59)
9	YW52010400000	Stainless steel water pipe three-way 1/4"	SUS304	1	1/4"
8	YW05061400100	Sleeve connector		1	6MMX1/4'' PT L-type (H59)
7	S-08	Pipe coupler	H58	1	1/4"PT*1/4"PT
6	YW05121200100	Sleeve connector		2	12MMX1/2'' PT L-type (H59)
5	YW59201500100	Zhongda 3-way DN20*DN15	SUS304	1	
4	STM-3050F-B-08/01	Copper connector	H58	1	
3	STM-3050F-B-06	Copper nut	H58	1	
2	YW57030400000	Y-shaped water filter valve 3/4"	Cu	1	
1	S-124	Copper joint 3/4"PT*n25	H62	1	3/4 "PT external tooth n19 through-hole
序号	代号	名称	材料	数量	备注

					制图		版本号	标题	STM-1220W-D	图号	STM-1220W-D-B-03	比例		数量	
					设计		核准	进水接头组件					材质		
					校对			信易電熱機械股份有限公司 Shini Plastics Technologies, Inc.				表面要求			
标记	更改前	更改后	更改人	日期	审核		日期						物料号		

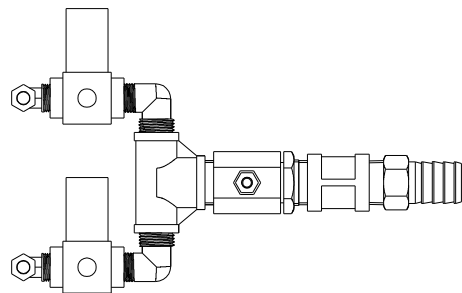
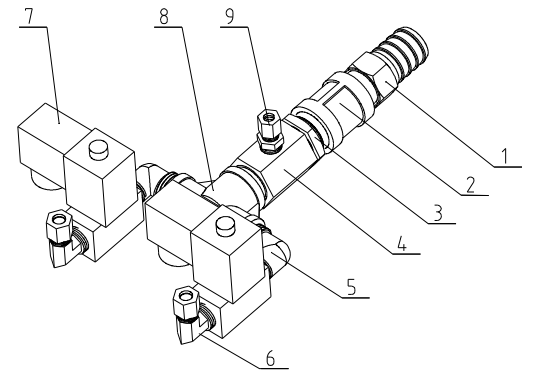
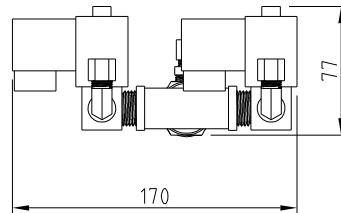
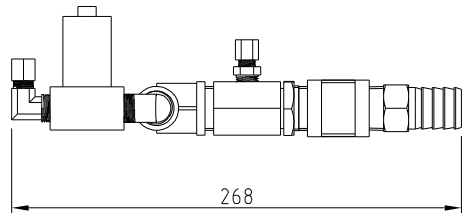

9	YW05061400000	Sleeve connector		1	6MMX1/4' PT (H59)
8	YW59201500100	Zhongda 3-way DN20*DN15	SUS304	1	
7	YE32203000900	Sleeve connector		2	3/8" Air TAC 24VAC
6	YW05083800100	Sleeve connector		2	8MMX3/8"PT L-type (H59)
5	YW04030800000	Copper connector 3/8 inch x 1/2 inch L-shaped	H58	2	
4	STM-3050F-B-08/01	Copper connector	H58	1	
3	STM-3050F-B-06	Copper nut	H58	1	
2	YW51030400000	Stainless steel water pipe straight through 3/4"	SUS304	1	
1	S-124	Copper joint 3/4"PT*n25	H62	1	3/4 "PT external tooth n19 through-hole
序号	代号	名称	材料	数量	备注

					制图		版号	标题	STM-1220W-D	图号	STM-1220W-D-B-04	比例		数量	
					设计		核准	排水接头组件					材质		
					校对			信易電熱機械股份有限公司 Shini Plastics Technologies, Inc.				表面要求			
标记	更改前	更改后	更改人	日期	审核		日期						物料号		