

1042.9

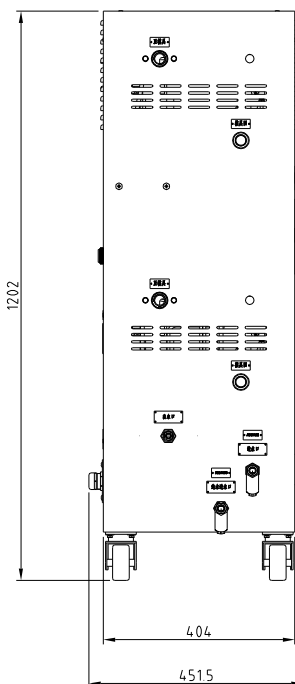

1202

404

4515

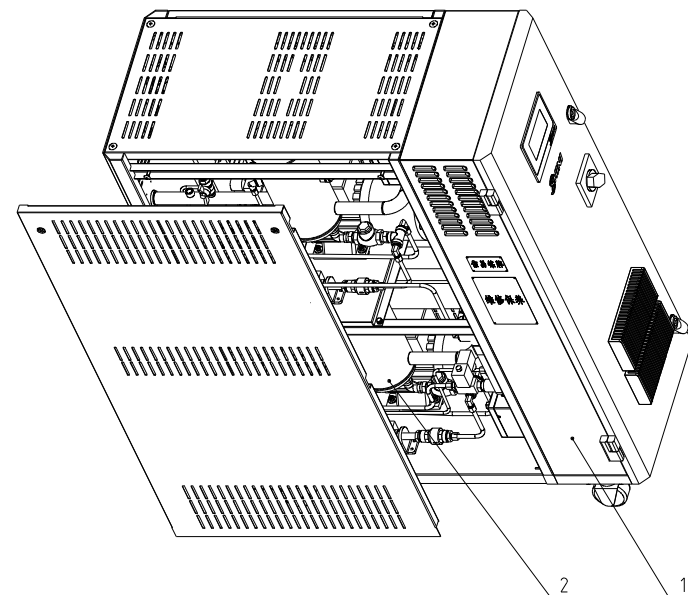
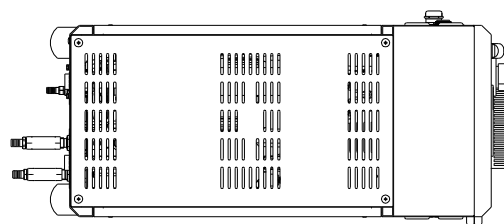

Technical requirements:
 1 Trimming and deburring,
 2 Dimensional tolerances not specified shall be in accordance with GB/T1804-2000
 Tolerances for linear and angular dimensions without specified tolerances
 The M-level regulations

2	STM-1220PW-D-B-ALL	Internal structure		1	
1	STM-1220PW-D-A-ALL	External sheet metal		1	
序号	代号	名称	材质	数量	备注

C1				2024.07.09	制图 设计 校对	版号 核 准	C	标题 STM-1220PW-D 双段高温水式模温机	图号 STM-1220PW-D-ALL	比例 1:10	数量 1	材质 /	
标记	更改前	更改后	更改人	日期	审核	日期	20230511	SHINI 信易电热机械股份有限公司 Shini Plastics Technologies, Inc.		表面要求	/	物料号	/

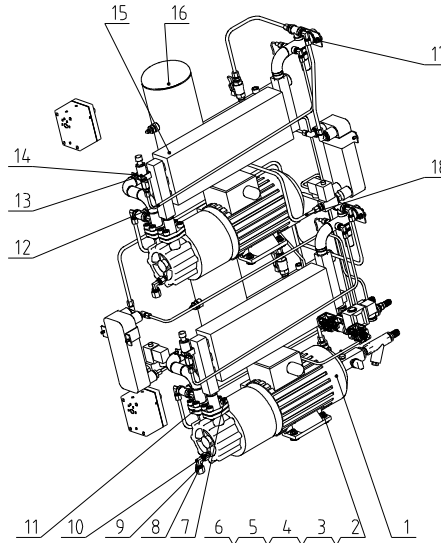
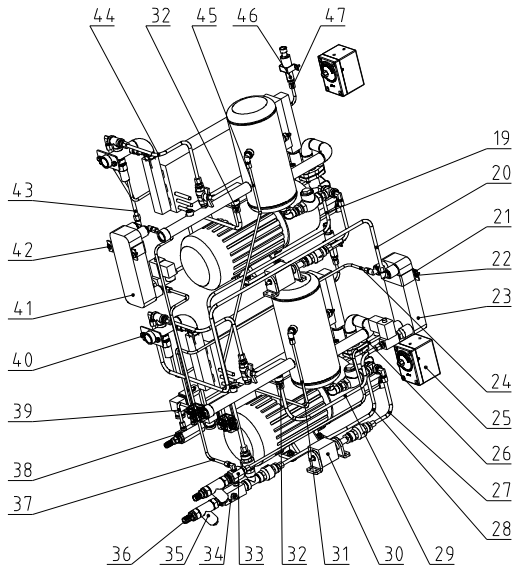

Technical requirements:

1. Trimming and deburring;

2. Dimensional tolerances not specified shall be in accordance with GB/T1804-2000

Tolerances for linear and angular dimensions without specified tolerances

The M-level regulations.

47	YW05061400000	Sleeve connector	H58	2	6MMX1/4"PT
46	BH12060701710	H-to-PT connector	SUS304	2	1/4" to 1/8" female thread
45	STM-1220PW-D-B-15	Pressure release pipe 2		1	
44	STM-1220PW-D-B-18	Hot water bypass		2	
43	STM-1220PW-D-B-16	Upper plate exchange hot water inlet pipe		1	
42	YW62061000000	One end flat head screw M8X11 Hex Flange		2	
41	STM-1220PW-D-B-26	Upper plate exchange		1	
40	YW60061500100	Hexagon screw bolt G2/32X M8X12.4 Flange		4	
39	STM-1220PW-D-B-20	Upper plate exchange cooling water outlet pipe		1	
38	STM-1220PW-D-B-06	discharge connector parts		1	
37	STM-1220PW-D-B-19	Upper plate exchange cooling water inlet pipe		1	
36	BH12121600010	Copper plug 1/2 inch PT * 16 (G-12)	H58	1	
35	YW57010200000	Flange filter water valve 1/2 inch PT female copper outlet G1/2	H62	1	
34	STM-1220PW-D-B-05	water refilling connector parts		1	
33	STM-1220PW-D-B-24	Cooling water inlet joint component		1	
32	YW050838000000	Sleeve connecto	H58	2	8MMX3/8"PT
31	STM-1220PW-D-B-10	Pressure relief pipe 1		1	
30	STM-607PW-F-ALL	Piston pump water replacement component		2	
29	STM-1220PW-D-B-12	Lower plate hot water exchange outlet pipe		1	
28	STM-1220PW-D-B-08	Water refilling pipe 1		1	
27	STM-1220PW-D-B-07	Piston pump water refilling pipe		2	
26	STM-1220PW-D-B-13	Lower plate exchange cooling water inlet pipe		1	
25	BH90115000250	Calculation 10 (1/2" 20 ° C G 1/2X 10) nickel wire		2	
24	STM-1220PW-D-B-14	Lower plate exchange cooling water outlet pipe		1	
23	STM-1220PW-D-B-25	Lower plate exchange		1	
22	YW62051000100	One end flat head screw M8X11 Hex Flange		10	
21	STM-607PW-B-20	Plate exchange fixed plate	SPCC2.0	2	
20	STM-1220PW-D-B-11	Lower plate exchange hot water inlet pipe		1	
19	STM-1220PW-D-B-09	Water refilling pipe 2		1	
18	STM-1220PW-D-B-17	Upper plate exchange hot water outlet pipe		1	
17	YW660613000000	Flat washer 4 grade G2/32.1 Flange		8	
16	STM-1220PW-D-B-04	Return pipe component		2	
15	STM-1220PW-D-B-03	Heater component		2	
14	STM-1220PW-D-B-23	Pressure transmitter mounting plate	SPCC15	2	
13	YE15200000500	Hexagon head bolt (20MM X 40MM X 1.6MM X 1.6MM)		2	
12	STM-1220PW-D-B-22	Pressure transmitter connecting pipe		2	
11	YR101100000000	Flange gasket 1/2-10 x 10 (graphite)	ISO-68	4	
10	YW04030800400	hot water pipe connector 3/8" (PT) 3/16" 3/16" degree	H58	2	
9	BH1224.4.001610	Teflon pipe plug 3/8" S-171	H58	2	
8	BH12090705510	brass oil drain screw G1/2X1/2 (10) yellow 1	H58	2	
7	YW61102500000	Hexagon head screw G2/32.1 M8X12.4 Flange		16	
6	YW64000600300	Hexagonal nut G2/32.1 M8 Flange		12	
5	YW65006000100	Standard spring washer G2/32 Flange		12	
4	YW660618000000	Large washer 4 grade G2/32.1 Flange		8	
3	YW66082200100	Large washer C grade G2/32.1 40MM Flange		8	
2	YW600625000000	Hexagonal head bolt G2/32.1 M8X12.4		8	
1	BM20150300750	Acrylic pipe fitting (brass nut) 1/2 inch 20MM X 10MM X 10MM	QT400	2	1.5KW Anbo

序号	代号	名称	材质	数量	备注
		标题 STM-1220PW-D	图号	比例 1:12	数量 1
		内部结构	STM-1220PW-D-B-ALL	材质 /	
				表面要求 /	
			物料号		/

制图	版号	E	日期	审核	日期
设计	核准		2024.07.10	校对	
标记	更改前	更改后	更改人	日期	20230511



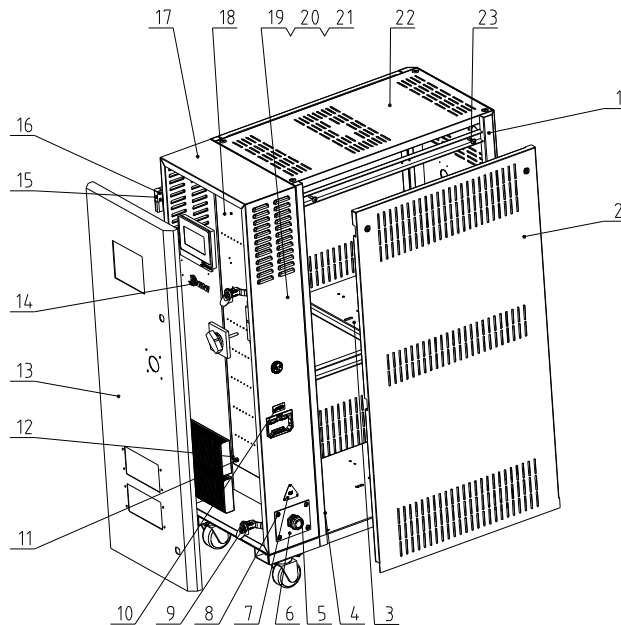
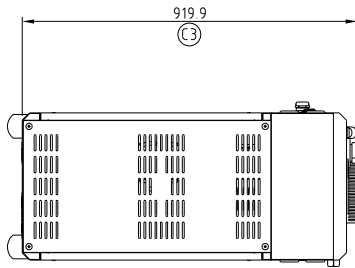
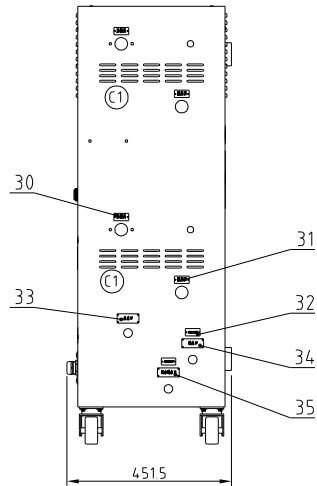
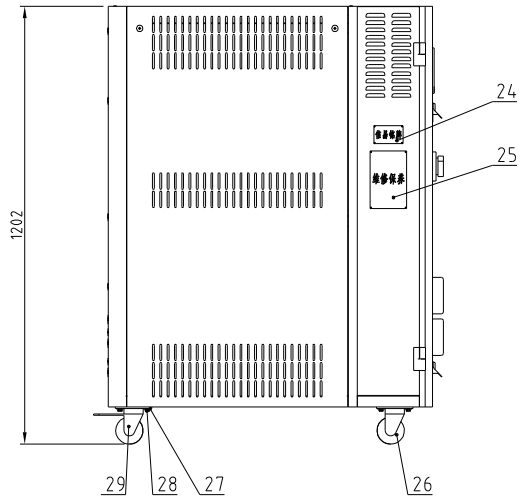

35	YP30602500000	Pure water inlet (aluminum plate)	2024	1	
34	YP30431000000	Water inlet (aluminum plate)	2024	1	
33	YP30430000000	Water outlet (aluminum plate)	2024	1	
32	YP31091040000	Aluminum plate label symbol 40*60MM	2024	2	
31	YP30422000000	Mould back	2024	2	
30	YP30423000000	To the mould (aluminum plate label)	2024	2	
29	YW03000300000	3-1/2" black PPR wheel with middle brake		2	
28	YW60061500100	Hexagon head bolt GB/T5783 M12*12.9	12.9	16	
27	YW66061800000	Large Water Grade A GB/T93.1 6 Deg Nut		16	
26	YW03000300200	3-1/2" movable black PPR wheel		2	
25	YP31115800600	Aluminum plate label 100*150mm	2024	1	
24	YP30804900700	Aluminum plate nameplate group general	2024	1	
23	YW62063000000	Cross recessed flat head screw JIS1111	Q235A	8	
22	STM-1220PW-D-A-05	Cover plate	SPCC12	1	
21	YW65006000100	Standard spring washer GB/T93 6	65Mn	20	
20	YW60061200000	Hexagon head bolt GB/T5783 M12*12.9	12.9	4	
19	YW66061300000	Flat Washer Grade A GB/T93.1 6-Deg Nut	Q235A	4	
18	STM-1220PW-D-A-04	Electronic control base	SECC15	1	
17	STM-1220PW-D-A-02	Electric control box	SPCC15	1	
16	YW61051000200	Cross recessed pan head screw-II type	Q235A	8	(C2)
15	YW06203100100	Ring G203-1 (left) Shengjin brand		2	
14	YP30802700000	Trademark 100*4 black sticker strong		1	
13	STM-1220PW-D-A-03	Door panel	SPCC15	1	
12	YW62061000000	Cross recessed flat head screw JIS1111	Q235A	6	
11	YW64000600300	Hexagonal nut GB/T6170 M6	Q235A	4	
10	YP30048500000	Communication interface RS485	2024	1	
9	YW00816100000	Door lock (MS16-1 black with key)		2	
8	YW62051000100	Cross recessed flat head screw JIS1111	Q235A	4	
7	YP31051650000	Power supply 3-phase 400V 51*51MM	2024	1	
6	BL50290000020	Wire clamp fixing plate PCS SS-3-01	SPCC2.0	1	
5	YE67361500100	Copper nickel-plated cable connector JF		1	
4	YP30429000000	Drainage outlet (aluminum plate)	2024	1	
3	STM-1220PW-D-A-08	Middle pump support plate	SPCC2.0	1	
2	STM-1220PW-D-A-06	Side panels	SPCC12	2	
1	STM-1220PW-D-A-01	rack		1	
序号	代号	名称	材质	数量	备注

Technical requirements:

1. Trimming and deburring;
2. Dimensional tolerances not specified shall be in accordance with GB/T1804-2000 Tolerances for linear and angular dimensions without specified tolerances The M-level regulations.

制图	版号	C	标题	图号	比例	1:13	数量	1
设计	核		STM-1220PW-D	STM-1220PW-D-A-ALL				
2024.0711	准		外部钣金					
校对	日期	20230506	信易电热机械股份有限公司 Shini Plastics Technologies, Inc.		表面要求		/	
标记	更改前	更改后			更改人	日期	物料号	/

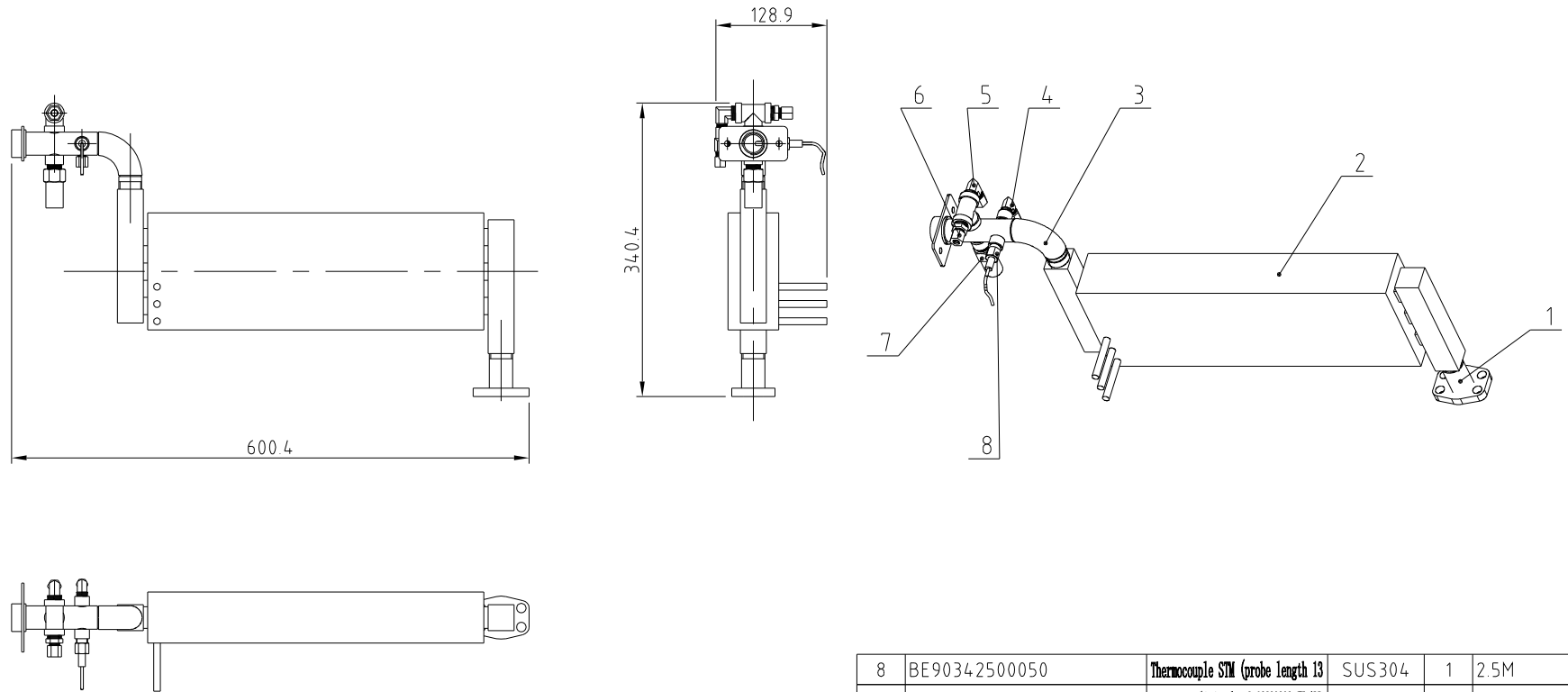

Technical requirements:

1. Trimming and deburring;
2. Dimensional tolerances not specified shall be in accordance with GB/T1804-2000 Tolerances for linear and angular dimensions without specified tolerances The M-level regulations.
3. Each screw thread connection must be wrapped with a sealing tape and must not leak under a pressure of 1.5 MPa.

8	BE90342500050	Thermocouple STM (probe length 13	SUS304	1	2.5M
7	BY90202200110	Pressure relief valve S-20220308-CH-ALL	Cu	1	
6	YW05083800000	Ferrule connector 8MMX3/8"PT	H58	1	8MMX3/8"PT
5	YW05083800100	Ferrule connector 6MMX3/8"PT L type	H58	1	6MMX3/8"PT L-type
4	YW05061400100	Ferrule connector 6MMX1/4"PT L type	H58	1	6MMX1/4"PT L-type
3	STM-1220PW-D-B-36	Heater outlet pipe		1	
2	YW59123300100	Mould temperature machine heater	SUS304	1	
1	STM-1220PW-D-B-01	Heater and water pump connecting pipe		1	
序号	代 号	名 称	材 质	数 量	备 注

					制图	版号	E	标题	STM-1220PW-D	图号	STM-1220PW-D-B-03	比例	1:7	数量	2
					设计	核		加热器组件					材质	/	
				2024.07.09	校对	准		信易電熱機械股份有限公司 Shini Plastics Technologies, Inc.				表面要求	/		
标记	更改前	更改后	更改人	日期	审核	日期	2024.07.09						物料号	/	

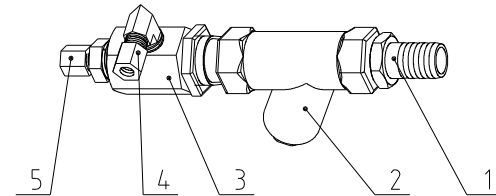
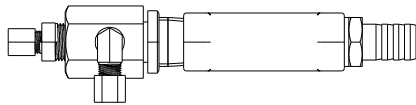
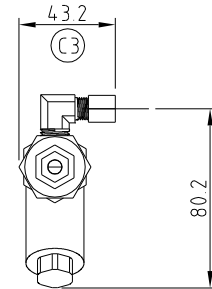
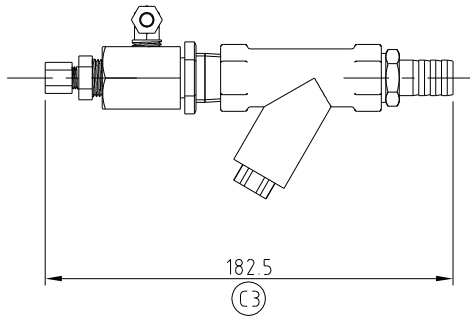

Technical requirements:

1. Trimming and deburring.
2. Dimensional tolerances not specified shall be in accordance with GB/T1804-2000 Tolerances for linear and angular dimensions without specified tolerances The M-level regulations.
3. Each screw thread should be wrapped with raw material tape to ensure no leakage at 15Mbar.

5	YW05063800500	Ferrule connector	H58	1	6MMX3/8"PT
4	YW05061400100	Ferrule connector	H58	1	6MMX1/4"PT L-type
3	BH12607800010	The fourth set of copper connectors		1	
2	YW57010200000	Y-type water filter valve 1/2" PT	H62	1	
1	BH12121600010	Copper ferrule 1/2" PT*Ø16 (S-133)	H58	1	
序号	代号	名称	材质	数量	备注

					制图	版号	C	标题	STM-1220PW-D	图号	STM-1220PW-D-B-24	比例	1:3	数量	1
					设计	核准		冷却水进水接头组件					材质	/	
				2024-0710	校对				信易电热机械股份有限公司	Shini Plastics Technologies, Inc.	表面要求	/			
标记	更改前	更改后	更改人	日期	审核	日期	20230510				物料号	/			

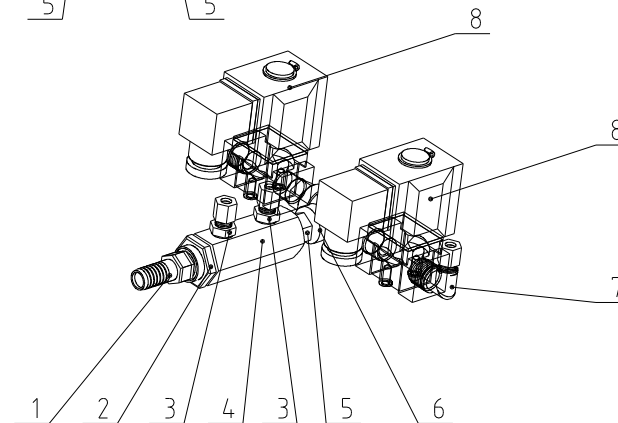
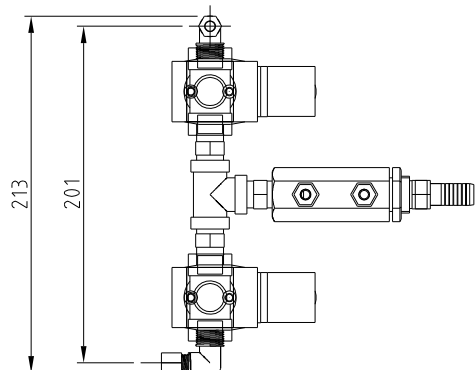
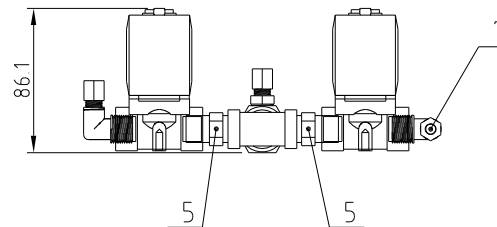
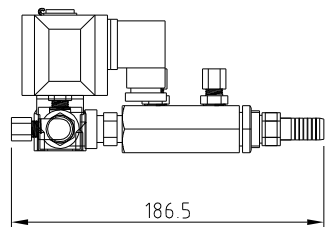

Technical requirements:

1. Trimming and deburring;
2. Dimensional tolerances not specified shall be in accordance with GB/T1804-2000 Tolerances for linear and angular dimensions without specified tolerances The M-level regulations.
3. Each threaded connection must be connected with thread glue.

8	YE30003802400	Solenoid valve 3/8" 2LHD50-10E AC24V		2	
7	YW05063800000	Ferrule connector 6MMX3/8" PT L type	H62	2	6MMX3/8" PT L-type
6	YW52030800000	Stainless steel water pipe tee 3/8"	SUS304	1	
5	BH12030800110	Tongni can't get it 3/8PT*3/8PT(S-07)	H58	3	
4	BH12607300010	Copper connector second set	H58	1	
3	YW05061400000	Ferrule connector 6MMX1/4" PT	H58	2	6MMX1/4" PT
2	BH12060703910	Universal copper nut S-136	H58	1	
1	BH12030801110	Copper joint 3/8" PT*Ø13 (S-85)	H58	1	
序号	代号	名称	材质	数量	备注

					制图	版号	E	标题	STM-1220PW-D	图号	比例	1:4	数量	1
					设计	核准		排水接头组件		STM-1220PW-D-B-06			材质	/
				20240709	校对				信易電熱機械股份有限公司 Shini Plastics Technologies, Inc.		表面要求	/		
标记	更改前	更改后	更改人	日期	审核	日期	20230509				物料号	/		

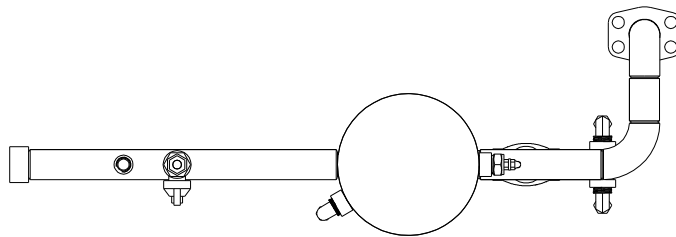
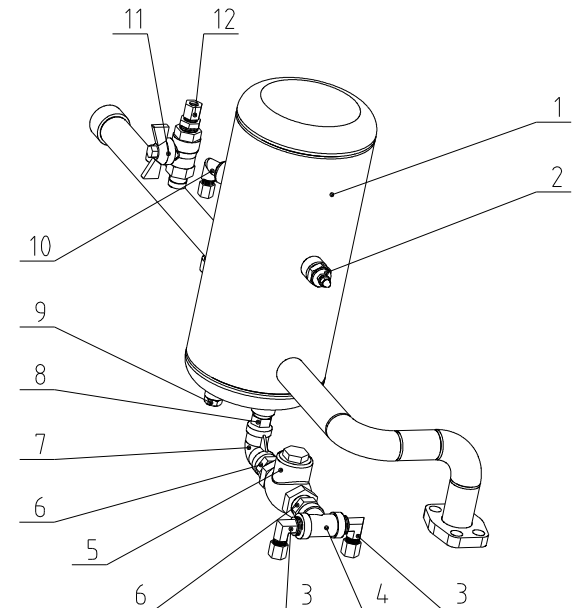
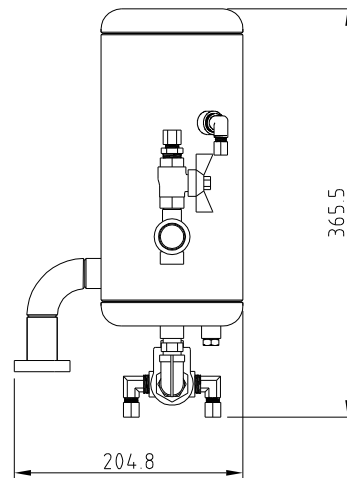
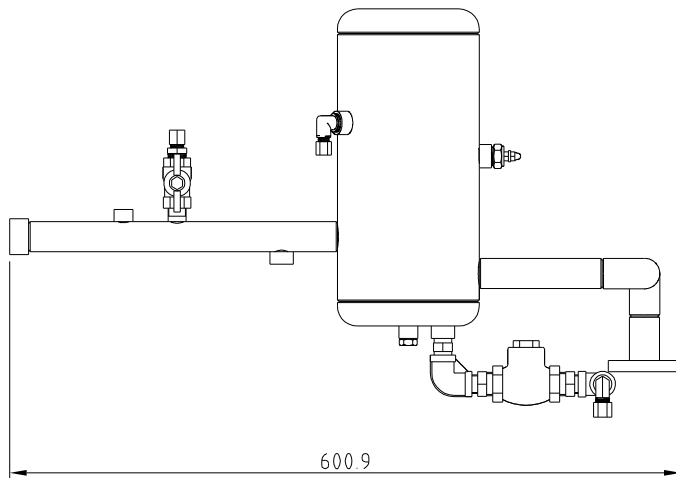

Technical requirements:

1. Trimming and deburring;
2. Dimensional tolerances not specified shall be in accordance with GB/T1804-2000 Tolerances for linear and angular dimensions without specified tolerances The M-level regulations.
3. PT teeth need to be wrapped with PTFE tape, and no leakage is allowed at any interface under 1.5Mbar.

12	YW05083800000	Ferrule connector 8MMX3/8"PT	H58	1	8MMX3/8"PT
11	YW50381800100	Copper butterfly handle ball valve 3/8	H58	1	Water level probe single copper
10	YW05063800000	Ferrule connector 6MMX3/8"PT L type	H62	1	6MMX3/8"PT L-type
9	BH12010400710	Hopper bottom screw 1/4" PT (S-11-0)	H58	1	
8	BH12030800110	Tongni can't get it 3/8PT*3/8PT (S-07)	H58	1	
7	YW53308000000	Stainless steel wire elbow 3/8" (304)	SUS304	1	
6	BH12030800310	Copper Ni can't reach 3/8" PT*1/2"	H58	2	
5	YW59010200300	Swing check valve R1/2" KITZ (copper)	Cu	1	
4	YW52030800000	Stainless steel water pipe tee 3/8"	SUS304	1	
3	YW05083800100	Ferrule connector 6MMX3/8"PT L type	H58	2	8MMX3/8"PT L-type
2	YW09003800500	Water level probe single copper		1	
1	STM-1220PW-D-B-02	Return pipe		1	
序号	代号	名称	材质	数量	备注

					制图	版号	C	标题	STM-1220PW-D	图号	STM-1220PW-D-B-04	比例	1:6	数量	2
					设计	核准			回水管组件				材质	/	
C1				2024.07.09	校对				信易电热机械股份有限公司 Shini Plastics Technologies, Inc.			表面要求	/		
标记	更改前	更改后	更改人	日期	审核	日期	20230509					物料号	/		

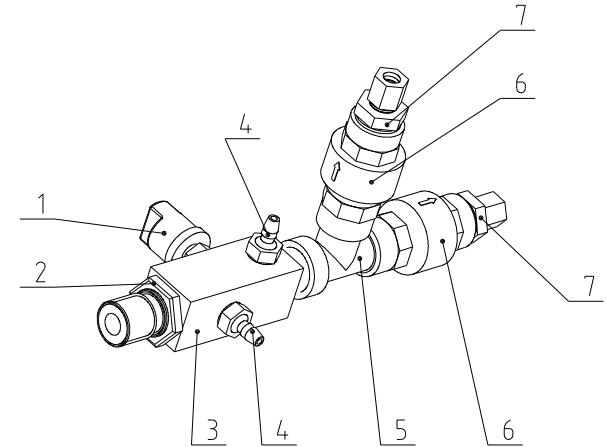
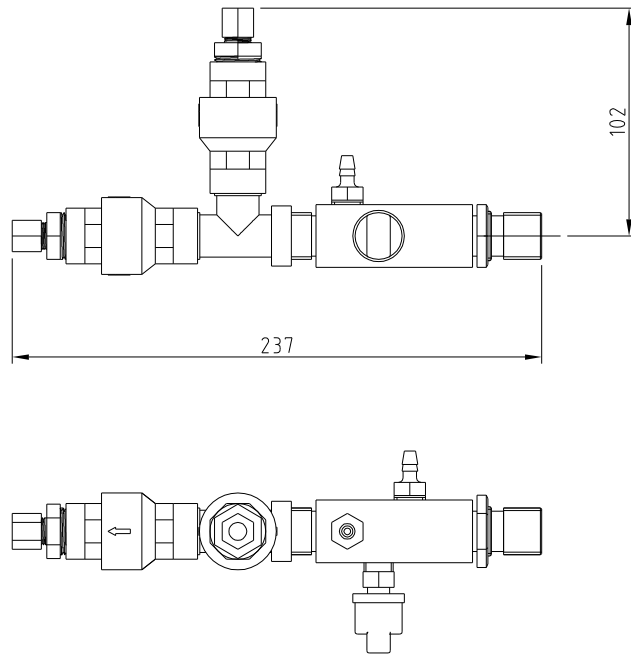

7	YW05081200600	Sleeve connector	H58	2	8MMX1/2"PT
6	YW59001201300	1/2 inch copper one-way valve		2	
5	YW59123000300	Stainless steel inner and outer teeth water pipe (ø 1/2 inch G3/8)	SUS304	1	
4	BH11060703110	Pagoda 7mm*1/4	H58	2	
3	BH12060703110	Water replacement connector STM-807P-01 (R3) version I	H58	1	
2	BH12060703910	General copper nut S-136	H58	1	
1	YE90110800100	Low pressure switch	H58	1	1/4"PTx1.5kg
序号	代号	名称	材质	数量	备注

Technical requirements:

1. Trimming and deburring;
2. Dimensional tolerances not specified shall be in accordance with GB/T1804-2000 Tolerances for linear and angular dimensions without specified tolerances The M-level regulations.
3. Threaded connections must be connected using thread glue.

					制图		版号	D	标题	STM-1220PW-D	图号	STM-1220PW-D-B-05	比例	1:3	数量	1
					设计		核准		补水接头组件					材质	/	
				2024.07.09	校对				信易電熱機械股份有限公司 Shini Plastics Technologies, Inc.			表面要求	/			
标记	更改前	更改后	更改人	日期	审核		日期	20230509			物料号	/				