

| Cooling Method | Heating Tank Qty | Pump Max. Pressure (bar) | Max. pump Flow(L/min) (ISO/60Hz) | Pump Power(kW) (ISO/60Hz) | Heater kW | Weight kW | Ver. |
|------------------|------------------|--------------------------|-------------------------------------|------------------------------|---------------------------|-----------|------|
| Indirect Cooling | 1 | 4.8 | 25.5/28 | 0.6/0.69 | 6 | 80 | J |
| | Max. Temp. | Ext. Size (mm)(H×W×D) | Inlet /Outlet Size (inch) | Sub water tank capacity (L) | Heating tank capacity (L) | | |
| | 180°C | 690×320×910 | 2/2 | 1.4 | 3.4 | | |

| 43 | YW66061300000 | Flat washer A grade 6 | Q235A | 4 | | | | | | | |
|-----|-------------------|--|---------|------|--------------------|-----|-----------------|------|------|------|---------|
| 42 | STM-607PW-C-ALL | Return water pipe assembly | | 1 | | | | | | | |
| 41 | STM-607PW-D-ALL | Refilling connector | | 1 | Assembly | | | | | | |
| 40 | YW67481900000 | Cross recessed pan head self-tapping screw | Q235A | 4 | GB/T15856.1 | | | | | | |
| 39 | STM-607PW-F-ALL | Plunger pump refilling assembly | | 1 | Assembly | | | | | | |
| 38 | STM-607PW-ALL-03 | Control box rear plate | | 1 | Welding parts | | | | | | |
| 37 | YW03002500000 | Castor | | 4 | 2.5" without brake | | | | | | |
| 36 | YW06219100000 | Large hinge | 2024 | 2 | Shengju CL219-1 | | | | | | |
| 35 | YW90120700000 | Alu cooler | 6061 | 1 | | | | | | | |
| 34 | STM-607PW-ALL-01 | Control box | | 1 | Welding parts | | | | | | |
| 33 | YW85015000000 | Pressure gauge | | 1 | 0~15MPa range | | | | | | |
| 32 | YW69081500000 | Butterfly bolt M8×15 | Q235A | 2 | GB/T 3098 | | | | | | |
| 31 | YW66081600000 | Flat washer A grade (8.4×16×1.6) | Q235A | 2 | GB/T97.1 | | | | | | |
| 30 | YE818500100100 | STM controller | | 1 | | | | | | | |
| 29 | YE84003500200 | buzzer PK-3A 220V | PVC | 1 | | | | | | | |
| 28 | STM-607PW-ALL-02 | Door plank | | 1 | Welding parts | | | | | | |
| 27 | YW0000000100 | Long door lock | PVC | 1 | | | | | | | |
| 26 | YW20660900100 | Door plank alu. handle | 2024 | 1 | 6609(Ya Xuan) | | | | | | |
| 25 | YE10125250000 | Main power switch | Q235A | 1 | P1-25 | | | | | | |
| 24 | BH90115000050 | High temp. tester | | 1 | EGO | | | | | | |
| 23 | | RS485 comm. connector | | 1 | Assembly | | | | | | |
| 22 | SG-S-01 | Wire clamp fixed plate | SPCC2.0 | 1 | | | | | | | |
| 21 | YE67201500100 | Copper nickel plated cable head | H62 | 1 | for 2.5×4C cable | | | | | | |
| 20 | YW62051000100 | Large cross recessed flat head screw M5×10 | Q235A | 4 | JIS1111 | | | | | | |
| 19 | YW65008000100 | Standard spring washer 8 | 65Mn | 4 | GB/T93 | | | | | | |
| 18 | YW66082200100 | Large washer C grade | Q235A | 8 | GB/T968(8.4×24×2) | | | | | | |
| 17 | YW62061000000 | Large cross recessed flat head screw M6×10 | Q235A | 18 | JIS1111 | | | | | | |
| 16 | YR10551500000 | Graphite washer | ISO-68 | 2 | for MP-55 | | | | | | |
| 15 | YW61082001200 | Inner hex. column head screw M8×20 | 12.9 | 12 | GB/T70.1 | | | | | | |
| 14 | YW66061800000 | Flat washer A grade | Q235A | 4 | GB/T96 1(6×18×1.5) | | | | | | |
| 13 | YW60062500000 | Hex bolt M6×25 | 4.8 | 4 | GB/T5781 | | | | | | |
| 12 | YW65006000100 | Standard spring washer 6 | 65Mn | 10 | GB/T93 | | | | | | |
| 11 | YW64000600300 | Hex nut M6 | Q235A | 6 | GB/T6170 | | | | | | |
| 10 | MP-55 | Magnetic pump | Q235A | 1 | Shini produced | | | | | | |
| 9 | STM-607PW-A-ALL | Rack | | 1 | Welding parts | | | | | | |
| 8 | YW57010200000 | Y-type strainer | H62 | 1 | 1/2"PT 30-35 mesh | | | | | | |
| 7 | STM-607PW-B-21 | Cooling water inlet connector | | 1 | Welding parts | | | | | | |
| 6 | S-133 | Copper insert | H58 | 1 | | | | | | | |
| 5 | STM-607PW-E-ALL | Drainage connector | | 1 | | | | | | | |
| 4 | STM-607PW-B-20 | Plate exchange fixed plate | SPCC2.0 | 1 | | | | | | | |
| 3 | STM-1220PW-D-B-29 | Right plate exchanger | | 1 | | | | | | | |
| 2 | STM-607PW-B-ALL | Heating tank assembly | | 1 | Welding parts | | | | | | |
| 1 | YR40523040000 | Plastic flexible buckle | PVC | 1 | 52×30 has mould | | | | | | |
| No. | Material number | Name | Mat. | Num. | Remarks | No. | Material number | Name | Mat. | Num. | Remarks |

| | | | | | |
|----|---------------|------------------------------------|------|---|-------------------|
| 46 | YE90002000000 | Pressure switch controller HLP520E | PVC | 1 | 5~20KG auto reset |
| 45 | YE90000800000 | Low pressure switch controller | PVC | 1 | 0~8KG/auto |
| 44 | YW60061500100 | Hex bolt M6×16 | 12.9 | 2 | GB/T5783 |

| | | | | | | | |
|----|-----|-----|-----------|----|---------------|------|-----|
| 制图 | 版号 | 标题 | STM-607PW | 图号 | STM-607PW-ALL | 比例 | 数量 |
| 设计 | 核准 | | 高温水式模温机 | | | | 材质 |
| 校对 | | | | | | 表面要求 | |
| 标记 | 更改前 | 更改后 | 更改人 | 日期 | 审核 | 日期 | 物料号 |



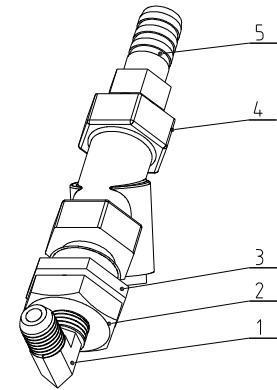
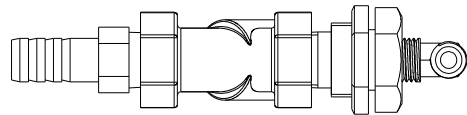
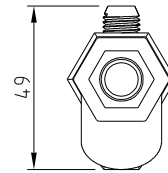
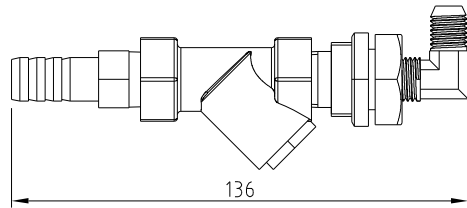

| | | | | | |
|-----|-----------------|--|-------|------|--------------------|
| 5 | S-85 | Copper insert | H58 | 1 | 3/8"PT×diameter 13 |
| 4 | YW57030800000 | Y strainer water valve $\frac{3}{8}$ " | Cu | 1 | |
| 3 | S-136 | Comm. copper nut | H58 | 1 | thread M22×15 |
| 2 | S-58 | Comm. connector | Q235A | 1 | |
| 1 | YW04010400400 | Tonflon pipe male thread elbow | H62 | 1 | 1/4"H×1/4"PT L |
| No. | Material number | Name | Mat. | Num. | Remarks |

| | | | | | | | | | | | | |
|----|-----|-----|-----|----|----|----|---|-----------|----|----------------|------|-----|
| | | | | | 制图 | 版号 | 标题 | STM-607PW | 图号 | STM-607PW-B-21 | 比例 | 数量 |
| | | | | | 设计 | 核准 | 冷却水进接头组件 | | | | | 材质 |
| | | | | | 校对 | | 信易電熱機械股份有限公司 Shini Plastics Technologies, Inc. | | | | 表面要求 | |
| 标记 | 更改前 | 更改后 | 更改人 | 日期 | 审核 | 日期 | | | | | | 物料号 |

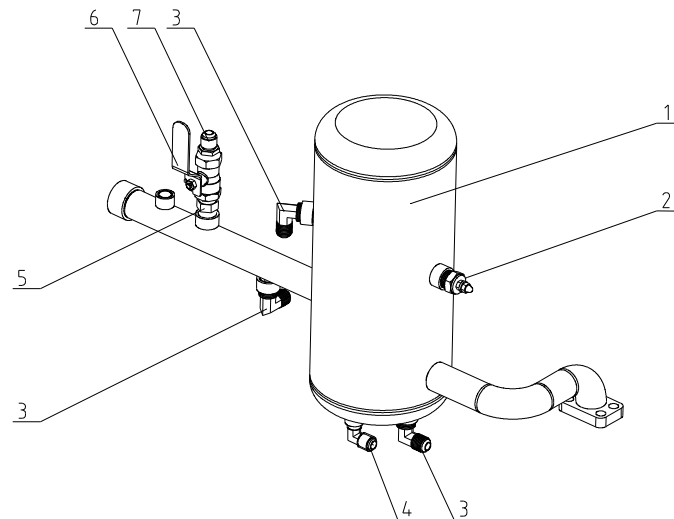
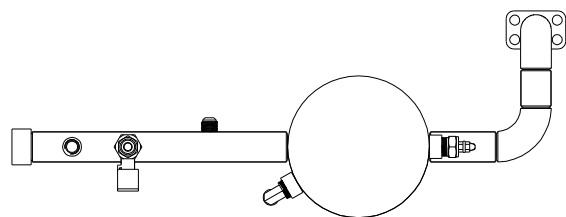
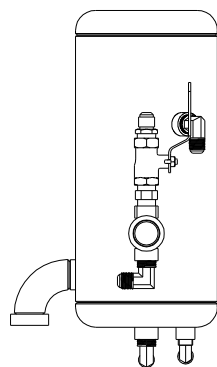
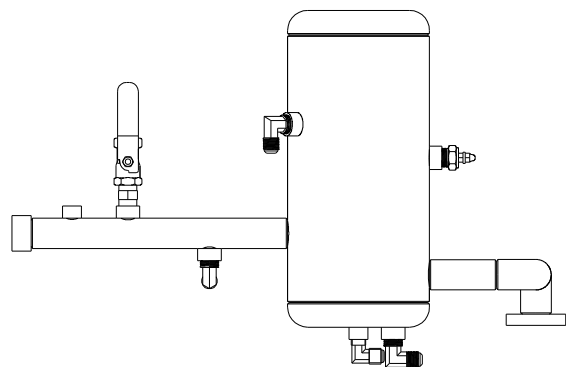

| | | | | | |
|-----|-----------------|--------------------------------|--------|------|---|
| 7 | S-116 | Tonflon pipe male thread elbow | H62 | 1 | 3/8"PT×3/8"H |
| 6 | YW50382300500 | Ball valve 3/8" | SUS304 | 1 | One piece withstand pressure |
| 5 | S-07 | Copper connector | H58 | 1 | 3/8"PT×3/8"PT |
| 4 | YW04030800200 | Tonflon pipe male thread elbow | H58 | 1 | 3/8H×1/4PTL type |
| 3 | YW04030800300 | Tonflon pipe connector | H58 | 3 | 3/8"PT×3/8"H L |
| 2 | YW09003800500 | Single water level probe | Q235A | 1 | 3" without lead wire withstand pressure 15Mpa |
| 1 | STM-607PW-C-01 | Return water pipe | | 1 | welding parts |
| No. | Material number | Name | Mat. | Num. | Remarks |

| | | | | | | | | | | |
|----|-----|-----|-----|----|----|----|---|-----------------|-----|------|
| | | | | | 制图 | 版号 | 标题 | 图号 | 比例 | 数量 |
| | | | | | 设计 | 核准 | STM-607PW | STM-607PW-C-ALL | | 材质 |
| | | | | | 校对 | | 回水管组件 | | | 表面要求 |
| 标记 | 更改前 | 更改后 | 更改人 | 日期 | 审核 | 日期 | 信易電熱機械股份有限公司 Shini Plastics Technologies, Inc. | | 物料号 | |

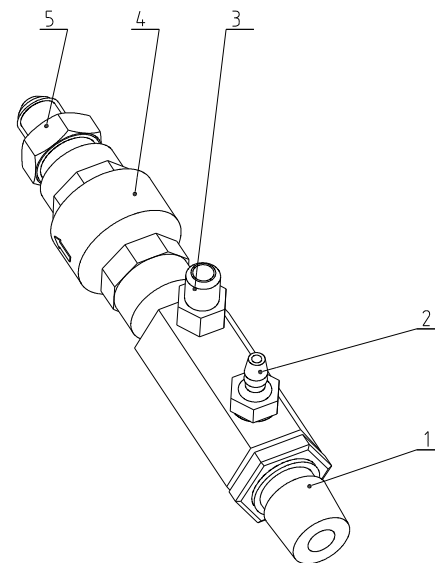
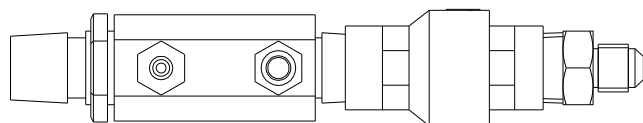
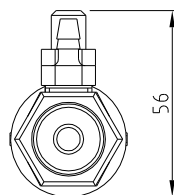
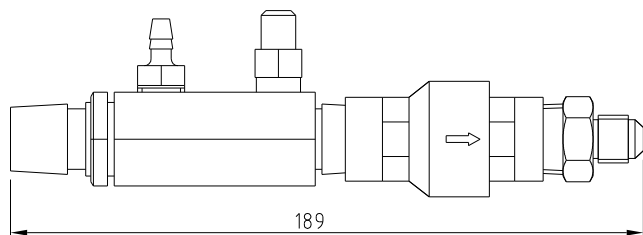

| | | | | | |
|----|-----------------|---------------------------------|------|------|--------------|
| 5 | S-91 | Tonflon pipe male thread elbow | H62 | 1 | 3/8"H×1/2"PT |
| 4 | YW59001201300 | Single way valve 1/2" VITON | Cu | 1 | RB |
| 3 | BH12010400410 | Tonflon pipe connector | H58 | 1 | 1/4"H×1/4"PT |
| 2 | STM-607PW-D-02 | pagoda 7mm×1/4 | H58 | 1 | borrow |
| 1 | S-146 | The 7th set of copper connector | | 1 | |
| No | Material number | Name | Mat. | Num. | Remarks |

| | | | | | | | | | | | | |
|----|-----|-----|-----|----|----|----|---|-----------|----|-----------------|------|-----|
| | | | | | 制图 | 版号 | 标题 | STM-607PW | 图号 | STM-607PW-D-ALL | 比例 | 数量 |
| | | | | | 设计 | 核准 | 补水接头组件 | | | | | 材质 |
| | | | | | 校对 | | 信易電熱機械股份有限公司 Shini Plastics Technologies, Inc. | | | | 表面要求 | |
| 标记 | 更改前 | 更改后 | 更改人 | 日期 | 审核 | 日期 | | | | | | 物料号 |

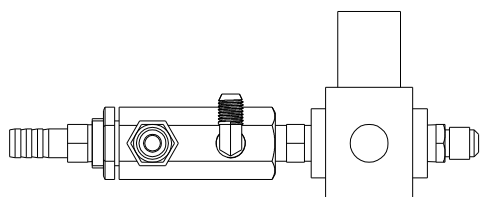
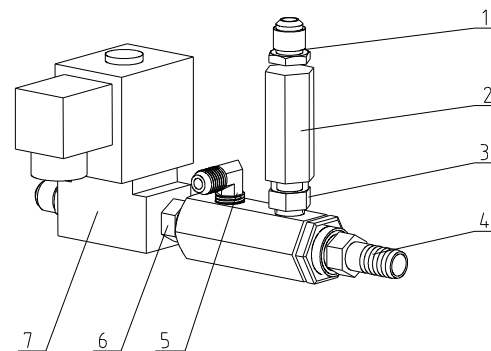
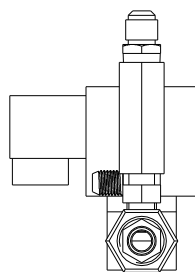
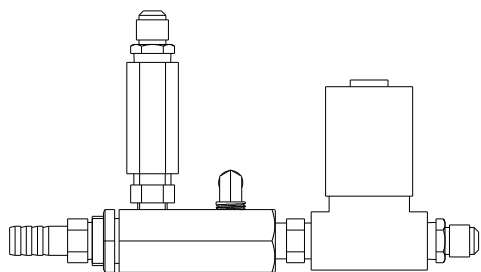

| | | | | | |
|----|-----------------|---------------------------------|--------|------|----------------|
| 7 | YE30003802400 | Solenoid valve AC24V Airtac | | 1 | 2LH050-10E |
| 6 | S-07 | Copper pipe | H58 | 1 | 3/8"PT×3/8"PT |
| 5 | YW04010400400 | Tonflon pipe male thread elbow | H62 | 1 | 1/4"H×1/4"PT L |
| 4 | S-139 | The 2th set of copper connector | | 1 | |
| 3 | S-50 | Copper pipe | H58 | 1 | 3/8"PT×1/4"PT |
| 2 | YW59383400000 | Single way valve 3/8" | SUS304 | 1 | 3/8"(SUS304) |
| 1 | S-116 | Tonflon pipe male thread elbow | H62 | 2 | 3/8"PT×3/8"H |
| No | Material number | Name | Mat. | Num. | Remarks |

| | | | | | | | | | | |
|----|-----|-----|-----|----|----|----|--|-----------------|------|----|
| | | | | | 制图 | 版号 | 标题 | 图号 | 比例 | 数量 |
| | | | | | 设计 | 核准 | STM-607PW | STM-607PW-E-ALL | | 材质 |
| | | | | | 校对 | | 排水接头部件 | | 表面要求 | |
| 标记 | 更改前 | 更改后 | 更改人 | 日期 | 审核 | 日期 | SHINI 信易電熱機械股份有限公司 Shini Plastics Technologies, Inc. | | 物料号 | |

| | | | | | | | |
|------------------|------------------|--------------------------|------------------------------------|-----------------------------|---------------------------|-----------|------|
| Cooling Method | Heating Tank Qty | Pump Max. Pressure (bar) | Max. pump Flow(L/min) (50/60Hz) | Pump Power(kW) (50/60Hz) | Heater kW | Weight kW | Ver. |
| Indirect Cooling | 2 | 4.8 | 25.5/28 | 0.6×2/0.69×2 | 6×2 | 185 | G |
| | Max. Temp. | Ext. Size (mm)(H×W×D) | Inlet /Outlet Size (inch) | Sub water tank capacity (L) | Heating tank capacity (L) | | |
| | 180°C | 750×620×990 | 2/2 | 1.4×2 | 3.2×2 | | |

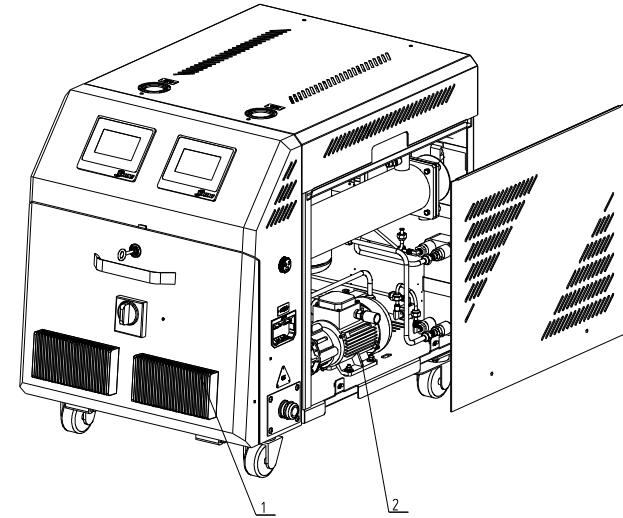
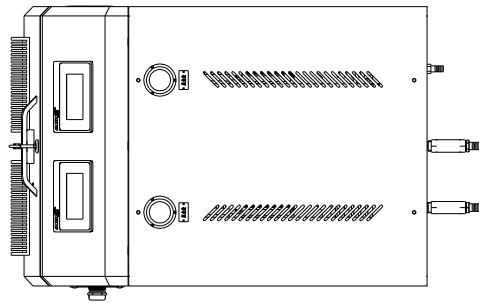
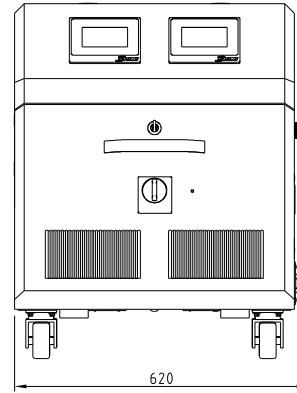
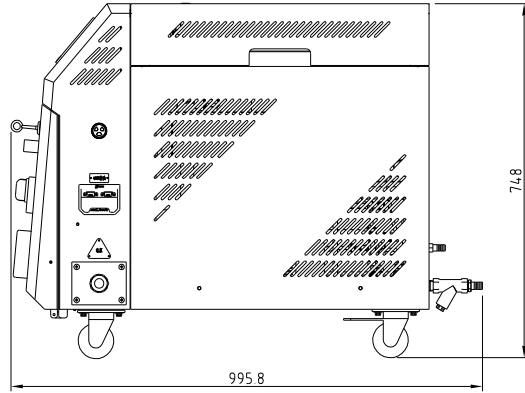

| | | | | | |
|-----|--------------------|--------------------|------|------|---------|
| 2 | STM-607PW-D-A-ALL | internal structure | | 1 | |
| 1 | STM-1220PW-D-A-ALL | House sheet metal | | 1 | |
| No. | Material number | Name | Mat. | Num. | Remarks |

| | | | | | | |
|----|-----|-----|-----|----|----|----|
| | | | | | 制图 | 版号 |
| | | | | | 设计 | 核准 |
| | | | | | 校对 | |
| 标记 | 更改前 | 更改后 | 更改人 | 日期 | 审核 | 日期 |

| | | | | | |
|---|-------------|----|-----------------|------|----|
| 标题 | STM-607PW-D | 图号 | STM-607PW-D-ALL | 比例 | 数量 |
| | 高温型双段水式模温机 | | | | 材质 |
| 信易电热机械股份有限公司 Shini Plastics Technologies, Inc. | | | | 表面要求 | |
| | | | | 物料号 | |

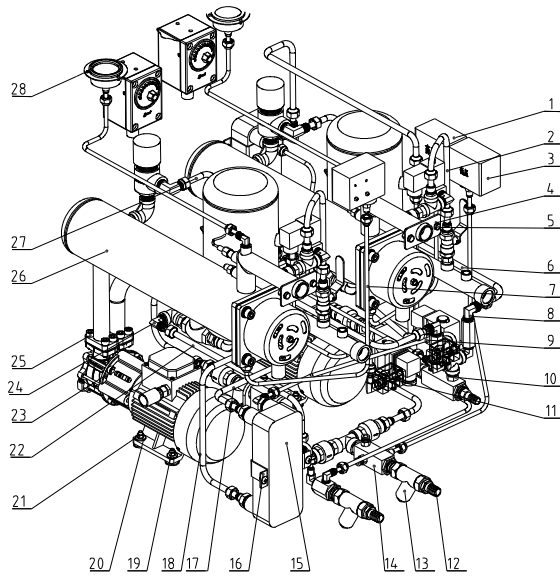
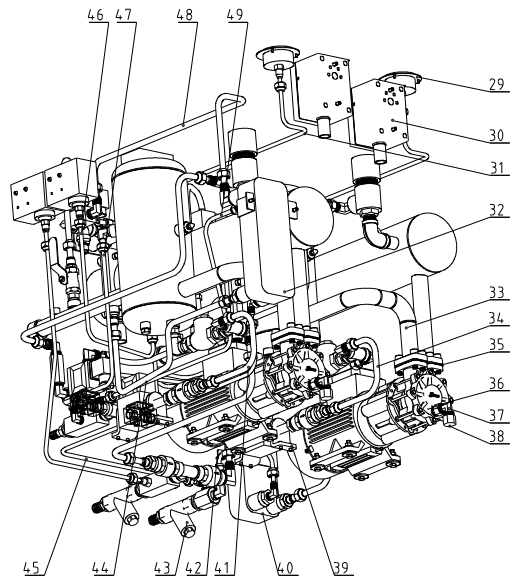
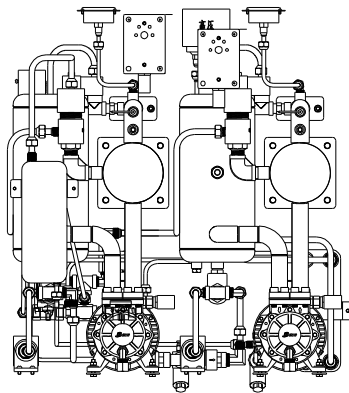
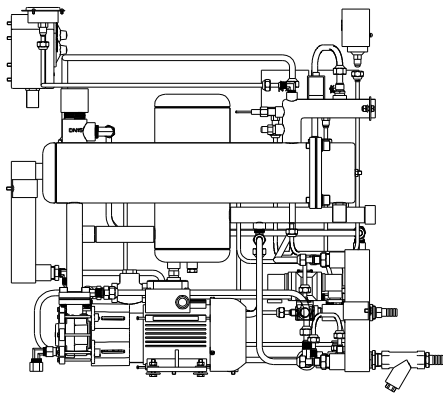

| | | | | | |
|-----|-------------------|--|---------|----|---------------------|
| 4.8 | STM-1220PW-D-B-31 | Left plate exchanger hot water inlet pipe | | 1 | |
| 4.7 | STM-1220PW-D-B-11 | Left pressure release pipe | | 1 | |
| 4.6 | STM-1220PW-D-B-18 | Left high pressure pipe | | 1 | |
| 4.5 | STM-1220PW-D-B-17 | Left cooling water inlet pipe | | 1 | |
| 4.4 | STM-1220PW-D-B-32 | Left plate exchanger hot water outlet pipe | | 1 | |
| 4.3 | STM-1220PW-D-B-35 | Cooling water inlet connector assembly | | 1 | Welding parts |
| 4.2 | YW62061000000 | Large cross recessed flat head screw M6×10 | Q235A | 2 | JIS1111 |
| 4.1 | STM-1220PW-D-B-13 | Left refilling pipe | | 1 | |
| 4.0 | STM-1220PW-D-B-29 | Right plate exchanger | | 1 | |
| 3.9 | STM-607PW-F-ALL | Plunger pump refilling assembly | | 2 | |
| 3.8 | S-171 | Teflon pipe plug | H58 | 2 | 3/8"H plug |
| 3.7 | YW04.03080004.00 | Copper pipe connector | H58 | 2 | 1/4"PT×3/8"H L |
| 3.6 | STM-907HT-B-17 | Oil discharge long screw | H58 | 2 | borrow |
| 3.5 | YR10551500000 | graphite gasket | ISO-68 | 4 | for MP-55 |
| 3.4 | STM-1220PW-D-B-12 | Plunger pump refilling pipe | | 2 | |
| 3.3 | STM-607PW-D-A-04 | Return water pipe assembly | | 2 | assembly |
| 3.2 | STM-1220PW-D-B-30 | Left plate exchanger | | 1 | |
| 3.1 | STM-1220PW-D-B-20 | Pressure gauge pipe | | 2 | |
| 3.0 | BH90115000005.0 | High temp tester | | 2 | EGO |
| 2.9 | YW85015000000 | Pressure gauge | | 2 | 0~1.5MPa range |
| 2.8 | YW63030600000 | Cross recessed pan head screw M3×6 | Q235A | 6 | GB/T-823 |
| 2.7 | STM-1220PW-D-B-22 | Right air exhaust pipe | | 1 | |
| 2.6 | STM-607PW-D-A-03 | Heating tank assembly | | 2 | assembly |
| 2.5 | YW61082500000 | Inner hex column head screw M8×25 | Q235A | 16 | GB/T770.1 |
| 2.4 | YW04.030800300 | Copper pipe connector | H58 | 5 | 3/8"PT×3/8"H L |
| 2.3 | MP-55 | Magnetic pump | Q235A | 2 | Shini auto produced |
| 2.2 | STM-1220PW-D-B-23 | Right water refilling pipe | | 1 | |
| 2.1 | YW650060000100 | Standard spring washer 6 | 65Mn | 12 | GB/T93 |
| 2.0 | YW66061800000 | Large washer A grade | Q235A | 8 | GB/T96.1(6×18×15) |
| 1.9 | YW60062500000 | Hex bolt M6×25 | 4.8 | 8 | GB/T5781 |
| 1.8 | STM-1220PW-D-B-34 | Right plate exchange hot water outlet pipe | | 1 | |
| 1.7 | STM-1220PW-D-B-33 | Right plate exchange hot water inlet pipe | | 1 | |
| 1.6 | STM-607PW-B-20 | Plate exchange fixed plate | SPCC2.0 | 2 | |
| 1.5 | STM-1220PW-D-B-24 | Right cooling water inlet pipe | | 1 | |
| 1.4 | STM-1220PW-D-B-05 | Refilling connector assembly | | 1 | |
| 1.3 | YW57010200000 | Y-type water strainer | H62 | 1 | 1/2" PT 30-35 mesh |
| 1.2 | S-133 | Copper insert | H58 | 1 | |
| 1.1 | STM-1220PW-D-B-21 | Right pressure release pipe | | 1 | |
| 1.0 | STM-1220PW-D-B-06 | Drainage connector assembly | | 1 | |
| 9 | STM-1220PW-D-B-25 | Right cooling water outlet pipe | | 1 | |
| 8 | STM-1220PW-D-B-10 | Low pressure pipe | | 1 | |
| 7 | STM-1220PW-D-B-26 | Right high pressure pipe | | 1 | |
| 6 | STM-1220PW-D-B-14 | Left air exhaust pipe | | 1 | |
| 5 | YW600615000100 | Hex bolt M6×16 | 12.9 | 4 | GB/T5783 |
| 4 | YW66061300000 | Flat washer A grade 6 | Q235A | 8 | |
| 3 | YE90000800000 | Low pressure switch controller | PVC | 1 | 0-8KG/auto |
| 2 | STM-1220PW-D-B-16 | Hot water bypass pipe | | 2 | |
| 1 | YE90002000000 | Pressure switch controller HLP520E | PVC | 2 | 5~20KG auto reply |

| 4.9 | STM-1220PW-D-B-15 | Left cooling water outlet pipe | | 1 | |
|-----|-------------------|--------------------------------|------|------|---------|
| No | Material number | Name | Mat. | Num. | Remarks |

| No | Material number | Name | Mat. | Num. | Remarks |
|----|-----------------|------|------|------|---------|
|----|-----------------|------|------|------|---------|

| | | | | | | | | | | | | | |
|----|-----|-----|-----|----|----|----|----|----|-------------|----|-------------------|------|----|
| | | | | | 制图 | | 版号 | 标题 | STM-607PW-D | 图号 | STM-607PW-D-A-ALL | 比例 | 数量 |
| | | | | | 设计 | | 核准 | | 内部结构 | | | | 材质 |
| | | | | | 校对 | | | | | | | 表面要求 | |
| 标记 | 更改前 | 更改后 | 更改人 | 日期 | 审核 | 日期 | | | | | | 物料号 | |



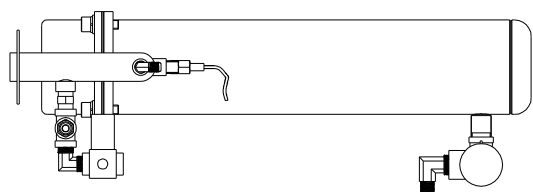
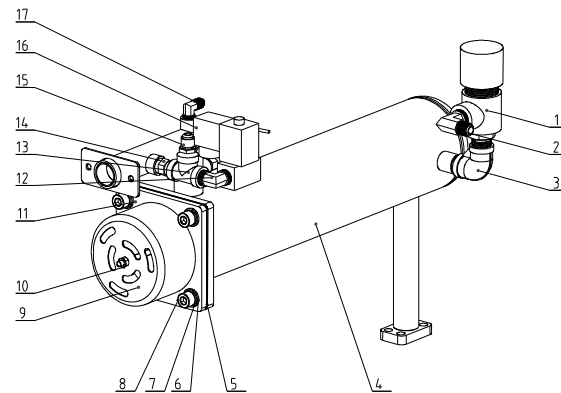
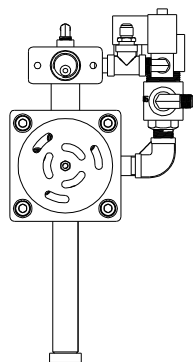
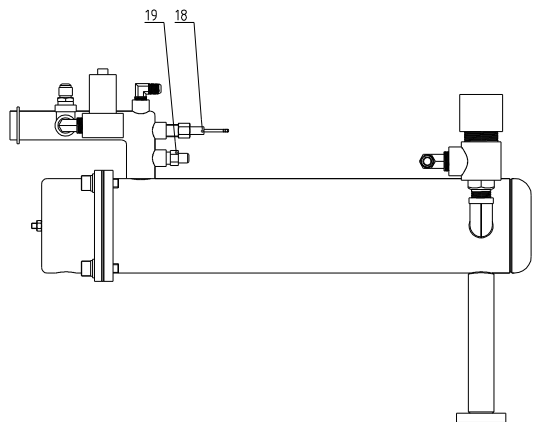

| | | | | | |
|-----|------------------|--------------------------------------|--------|------|---------------------|
| 19 | BH120104.004.10 | Tonflon pipe connector | H58 | 1 | 1/4"Hx1/4"PT |
| 18 | BE9034.1500050 | Thermocouple | SUS304 | 1 | 1.5M |
| 17 | YW04.0104.004.00 | Tonflon pipe male thread elbow | H62 | 1 | 1/4"Hx1/4"PT L |
| 16 | YE32203000900 | Solenoid valve | | 1 | 3/8"Arctac 24 VAC |
| 15 | S-116 | Tonflon pipe male thread elbow | H62 | 1 | 3/8"PTx3/8"H |
| 14 | S-07 | Copper connector | H58 | 1 | 3/8"PTx3/8"PT |
| 13 | YW52030800000 | 3/8" stainless steel 3-way Connector | SUS304 | 1 | |
| 12 | YW04.030800100 | Connector | H62 | 1 | 3/8"PT(L) |
| 11 | STM-607PW-H-ALL | Pipe heater assembly | | 1 | Welding part borrow |
| 10 | YW64.000600300 | Hex. nut M6 | Q235A | 1 | GB/T6170 |
| 9 | S-190 | Pipe heater cover | SPCC10 | 1 | |
| 8 | YW61103000100 | Inner hex. column head screw M10x30 | 12.9 | 4 | GB/T70.1 |
| 7 | YW65010000000 | Standard spring washer 10 | 65Mn | 4 | GB/T93 |
| 6 | YW66102000100 | Flat washer A grade 10 | Q235A | 4 | GB/T97.1 (11x20x2) |
| 5 | YR20121200000 | Flexible graphite gasket | ISO-68 | 1 | 120x120x2.0 |
| 4 | STM-607PW-D-A-01 | Heating tank | | 1 | Welding part |
| 3 | YW53001200100 | Stainless steel wire elbow | SUS304 | 1 | 3/8"PT |
| 2 | YW04.010200200 | Tonflon pipe connector | H58 | 1 | 1/2"PTx3/8"H L type |
| 1 | YW0514.1200000 | Safety valve | SUS304 | 1 | 1/2" male thread |
| No. | Material number | Name | Mat. | Num. | Remarks |

| | | | | | | | | | | |
|----|-----|-----|-----|----|----|----|--|------------------|------|----|
| | | | | | 制图 | 版号 | 标题 | 图号 | 比例 | 数量 |
| | | | | | 设计 | | STM-607PW-D | STM-607PW-D-A-03 | 1:1 | |
| | | | | | 校对 | | 加热桶组件 | | 1:1 | 材质 |
| | | | | | 审核 | | SHINI 信易电热机械股份有限公司 Shini Plastics Technologies, Inc. | | 表面要求 | |
| 标记 | 更改前 | 更改后 | 更改人 | 日期 | 审核 | 日期 | | | 物料号 | |

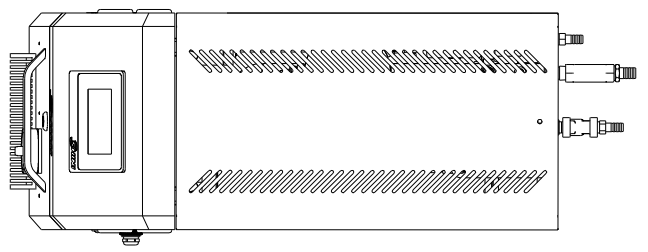
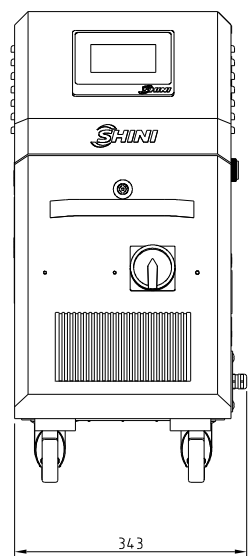
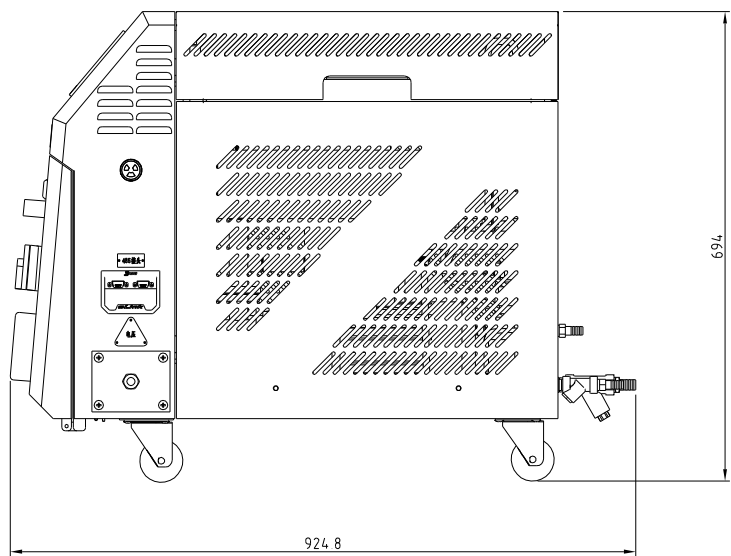

| | | | | | | |
|--|-------------------------|----------------|-------------------------------|-----------------------------|------------------|------|
| Max. pump Pressure (bar) | Max. pump Flow(L / min) | Pump Power(kW) | Heater (kW) | Max Temp | Weight(kg) | Ver. |
| 5.8 | 50 | 1.05 | 9 | 180°C | 73 | C |
| Inlet /Outlet Size CE PT inner thread (inch) | | | Cooling Method Direct Cooling | Sub water Tank capacity (L) | Heating Tank Qty | |
| 2/2 | | | | 14 | 1 | |

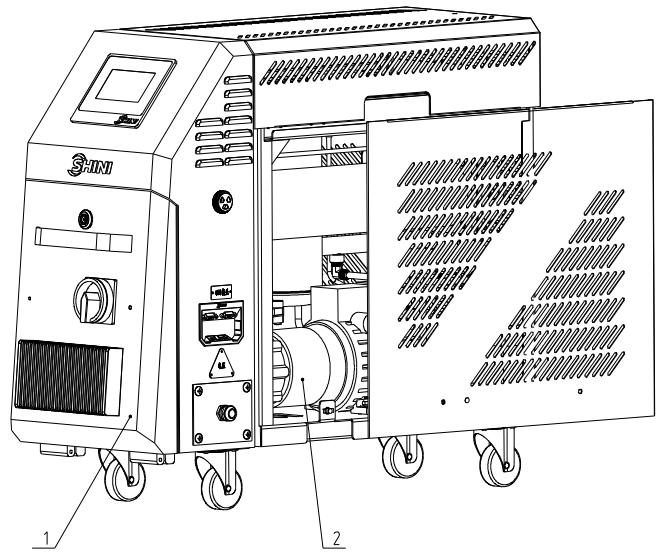

Technical requirements:

1. The machine needs to be wiped clean, without scratches or bumps;
2. During the operation of the machine, it is necessary to ensure that all pipelines are leak free

| | | | | | |
|----|-----------------|--------------------|----|----|----|
| 2 | STM-910PW-B-ALL | Internal Structure | | 1 | |
| 1 | STM-910PW-A-ALL | External Structure | | 1 | |
| 序号 | 代号 | 名称 | 材质 | 数量 | 备注 |

| | | | | | | | | | | | | | | |
|----|-----|-----|-----|----|----|--|----|--|---|-----------|----|---------------|-------------|----|
| | | | | | 制图 | | 版号 | | 标题 | STM-910PW | 图号 | STM-910PW-ALL | 比例 | 数量 |
| | | | | | 设计 | | 核准 | | 总装图 | | | | 表面要求 物料号 | |
| | | | | | 校对 | | | | 信易电热机械股份有限公司 Shini Plastics Technologies, Inc. | | | | | |
| 标记 | 更改前 | 更改后 | 更改人 | 日期 | 审核 | | 日期 | | | | | | | |

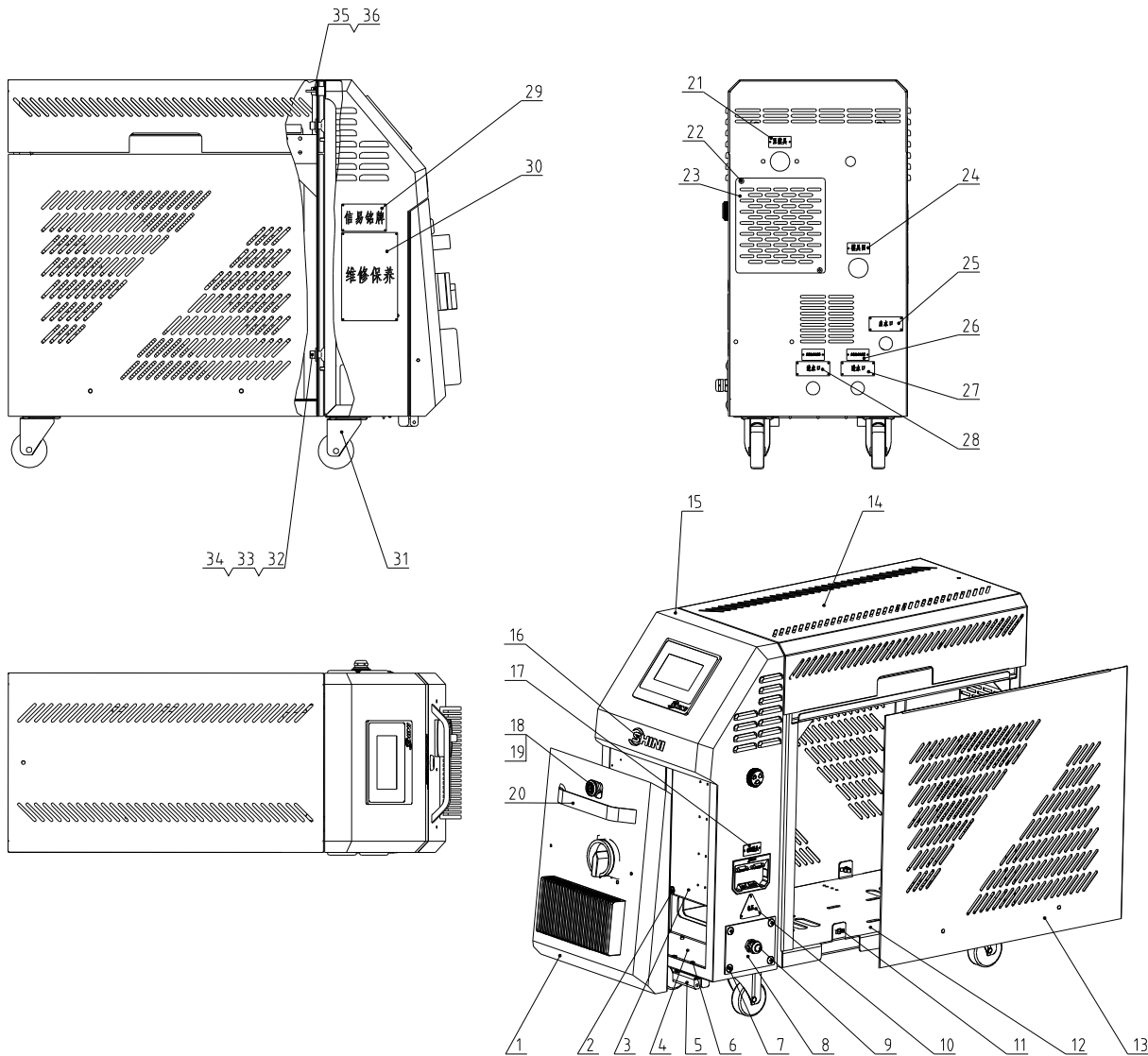

| | | | | | |
|----|-------------------|---|---------|----|----|
| 36 | YW66081600000 | Flat washer 1 grade Q235 1.6 40*40 Q13gpin | | 2 | |
| 35 | YW69081500000 | Butterfly bolt GR7 3038 Mx15 | | 2 | |
| 34 | YW6500800100 | Standard spring washer G2/33 P-Longzinc | | 4 | |
| 33 | YW66082200100 | Large washer C grade Q1700(1.4310)-Longzinc | | 4 | |
| 32 | YW61082001200 | Large washer C grade Q1700(1.4310)-Longzinc | | 4 | |
| 31 | YW03002500000 | Internal rubber sheet 2.5 inches (thickness) | | 4 | |
| 30 | YP31115800600 | Washer of aluminum alloy (thickness 1.6) in diameter 10 (P-16) | 2024 | 1 | |
| 29 | YP304.370000000 | Aluminum Plate Anodized (Thickness 1.6) in diameter 10 (P-16) | 2024 | 1 | |
| 28 | YP30602500000 | Perforated steel plate (Thickness 1.6) in diameter 10 (P-16) | 2024 | 1 | |
| 27 | YP304.310000000 | Aluminum Plate Anodized (Thickness 1.6) in diameter 10 (P-16) | 2024 | 1 | |
| 26 | YP3109104.0000 | Aluminum Plate Anodized (Thickness 1.6) in diameter 10 (P-16) | 2024 | 2 | |
| 25 | YP304.300000000 | Aluminum Plate Anodized (Thickness 1.6) in diameter 10 (P-16) | 2024 | 1 | |
| 24 | YP304.220000000 | Aluminum Plate Anodized (Thickness 1.6) in diameter 10 (P-16) | 2024 | 1 | |
| 23 | STM-1220PW-A-07 | Rear plate small cover plate | SPCC12 | 1 | |
| 22 | YW63051000000 | Washer of aluminum alloy (thickness 1.6) in diameter 10 (P-16) | Q235A | 2 | |
| 21 | YP304.230000000 | Aluminum Plate Anodized (Thickness 1.6) in diameter 10 (P-16) | 2024 | 1 | |
| 20 | YW20660900100 | Large hinge of aluminum alloy (thickness 1.6) in diameter 10 (P-16) | 2024 | 1 | |
| 19 | YW00004.0600000 | Washer of aluminum alloy (thickness 1.6) in diameter 10 (P-16) | | 1 | |
| 18 | YW00000000100 | Long door lock | PVC | 1 | |
| 17 | YP3004.8500000 | Aluminum Plate Anodized (Thickness 1.6) in diameter 10 (P-16) | 2024 | 1 | |
| 16 | YP30802700100 | Aluminum Plate Anodized (Thickness 1.6) in diameter 10 (P-16) | PET | 1 | |
| 15 | STM-910PW-A-02 | Control box | | 1 | |
| 14 | STM-910PW-A-03 | Cover plate | | 1 | |
| 13 | STM-910PW-A-04 | Side plate | | 2 | |
| 12 | STM-910PW-A-01 | Rack | | 1 | |
| 11 | YW01051000000 | Pin spring STM with 65Mn | 65Mn | 6 | |
| 10 | YP31051650000 | Washer of aluminum alloy (thickness 1.6) in diameter 10 (P-16) | 2024 | 1 | |
| 9 | YE67201500200 | Large hinge of aluminum alloy (thickness 1.6) in diameter 10 (P-16) | | 1 | |
| 8 | BL50135000020 | Plating board of zinc clamp P23.5 (S2.5) (1mm width) | SPCC2.0 | 1 | |
| 7 | YW62061000000 | Cross washer flat head screw 2.5(11) Mx1.6(1) Longzinc | Q235A | 20 | |
| 6 | YW6704.0600600 | Cross washer flat head screw 2.5(11) Mx1.6(1) Longzinc | Q235A | 5 | |
| 5 | YW06219100000 | Large hinge Q210-1 (with mold) | | 2 | |
| 4 | STM-607PW-ALL-03 | Rear panel of electrical control box | | 0 | |
| 3 | STM-1220PW-ALL-03 | Electric control base plate | SECC15 | 1 | |
| 2 | YW63062000000 | Washer of aluminum alloy (thickness 1.6) in diameter 10 (P-16) | Q235A | 4 | |
| 1 | STM-607PW-ALL-02 | door plank | | 1 | |
| 序号 | 代号 | 名称 | 材质 | 数量 | 备注 |

Technical requirements:
Components that require screw fastening must have screws securely fastened.

| 标记 | 更改前 | 更改后 | 更改人 | 日期 | 制图 | 版号 | 标题 | 图号 | 比例 | 数量 | 备注 |
|----|-----|-----|-----|----|----|----|---------------------------|-----------------------------------|------|----|----|
| | | | | | 设计 | 核准 | STM-910PW | STM-910PW-A-ALL | 1:1 | 1 | |
| | | | | | 校对 | | 外部结构 | | | | |
| | | | | | 审核 | | SHINI 信易电热机械股份有限公司 | Shini Plastics Technologies, Inc. | 表面要求 | | |
| | | | | | | | | | 物料号 | | |

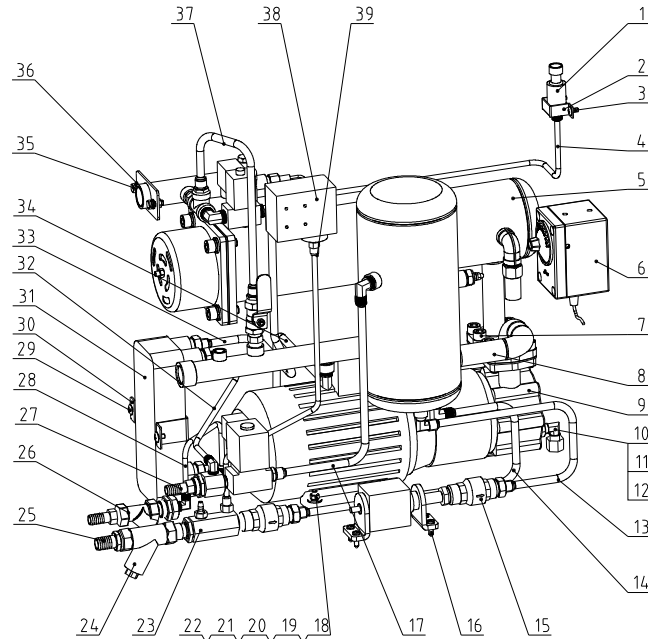
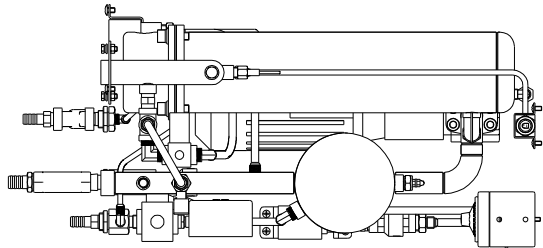
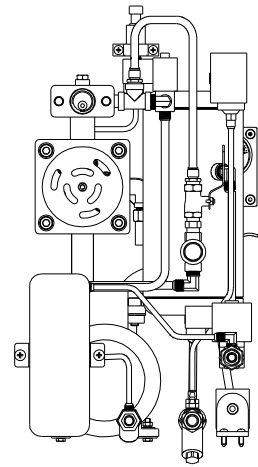
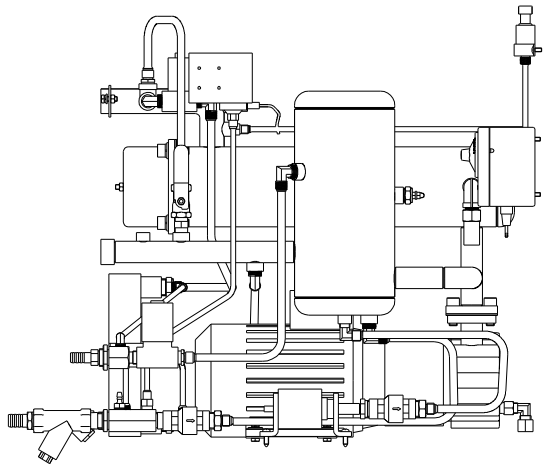

| | | | | | |
|----|-------------------|--|---------|----|----|
| 39 | STM-910PW-B-08 | Low pressure pipe | | 1 | |
| 38 | YE90000800000 | Low pressure pipe | | 1 | |
| 37 | STM-1220PW-B-08 | Hot water bypass | | 1 | |
| 36 | YW66061300000 | Flat water 1 grade 62/77.1 Flange | | 2 | |
| 35 | YW60061500100 | Large size hot 62/78.1 Hot Flange | 12.9 | 2 | |
| 34 | STM-1220PW-B-18 | Plate exchange outlet pipe | | 1 | |
| 33 | STM-1220PW-B-17 | plate exchange hot water inlet pipe | | 1 | |
| 32 | STM-607PW-B-10 | Outlet of cooling water | | 1 | |
| 31 | STM-910PW-B-10 | Plate exchange assembly | | 1 | |
| 30 | STM-607PW-B-20 | Plate exchange fixed plate | SPCC2.0 | 1 | |
| 29 | YW62061000000 | Large size hot 62/78.1 Hot Flange | | 2 | |
| 28 | STM-607PW-B-11 | Cooling water inlet pipe | | 1 | |
| 27 | STM-607PW-E-ALL | Drainage joint components | / | 1 | |
| 26 | STM-607PW-B-21 | Cooling water inlet joint component | | 1 | |
| 25 | BH12131200010 | Copper joint 1/2" F7x13(S-73) | H58 | 1 | |
| 24 | YW57010200000 | 1/2" filled air inlet 1/2" Flange 1 large size of 18 | H62 | 1 | |
| 23 | STM-607PW-D-ALL | Water refilling connector assembly 0 | | 1 | |
| 22 | YW64000600300 | Hexagon nut 62/76.170 M6-Longtine | | 6 | |
| 21 | YW65006000100 | Standard spring washer 62/73 Flange | | 6 | |
| 20 | YW66061800000 | Large washer 1 grade 62/78.1 Flange | | 4 | |
| 19 | YW66082200100 | Large washer 1 grade 62/78.1 62/80 Flange | | 4 | |
| 18 | YW60062500000 | Large size hot 62/78.1 Hot Flange | | 4 | |
| 17 | STM-910PW-B-09 | Air exhaust pipe | | 1 | |
| 16 | YW67481900000 | Low size hot 62/78.1 Hot Flange | Q235A | 4 | |
| 15 | STM-607PW-F-ALL | Piston pump water refilling assembly 0 | | 1 | |
| 14 | STM-910PW-B-06 | Water refilling pipe | | 1 | |
| 13 | STM-910PW-B-05 | Piston pump water refilling pipe | | 1 | |
| 12 | BH1224.4001610 | Teflon pipe plug/1/8" S-171 | H58 | 1 | |
| 11 | YW04030800400 | Water pipe connector 1/8" F7x13(S-73) 1 degree | H58 | 1 | |
| 10 | BH12090705510 | 6/11 lengthened screw 20#-400F+17/32Hex.4 | H58 | 1 | |
| 9 | BM20010000550 | Pump 1/2" 20#/40#/40#/40#/40#/40#/40# | | 1 | |
| 8 | STM-910PW-B-04 | Return water pipe assembly | | 1 | |
| 7 | YW61102500000 | Large size hot 62/78.1 Hot Flange | 12.9 | 8 | |
| 6 | BH90115000050 | Assembly 150/115-50°C 62.1362.160 | | 1 | |
| 5 | STM-910PW-B-03 | Heating tank assembly 0 | | 1 | |
| 4 | STM-910PW-B-07 | Pressure transmitter connection pipe | | 1 | |
| 3 | YW62051000100 | Large size hot 62/78.1 Hot Flange | Q235A | 4 | |
| 2 | STM-1220PW-D-B-23 | Pressure transmitter fixed plate | SPCC15 | 1 | |
| 1 | YE15200000500 | Pressure transmitter 1/2" F7x13(S-73) | | 1 | |
| 序号 | 代号 | 名称 | 材质 | 数量 | 备注 |

| | | | | | | | | | | |
|----|-----|-----|-----|----|----|----|--------------|---|------|----|
| | | | | | 制图 | 版号 | 标题 | 图号 | 比例 | 数量 |
| | | | | | 设计 | 核准 | STM-910PW | STM-910PW-B-ALL | 1:1 | 1 |
| | | | | | 校对 | | 内部结构 | | | 材质 |
| | | | | | 审核 | 日期 | SHINI | 信易电热机械股份有限公司 Shini Plastics Technologies, Inc. | 表面要求 | |
| 标记 | 更改前 | 更改后 | 更改人 | 日期 | 审核 | 日期 | | | 物料号 | |

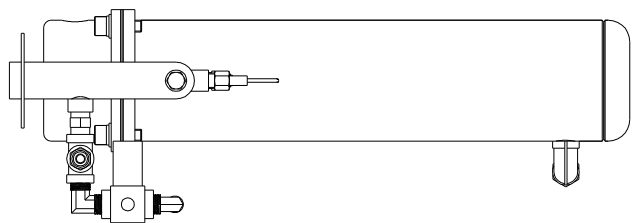
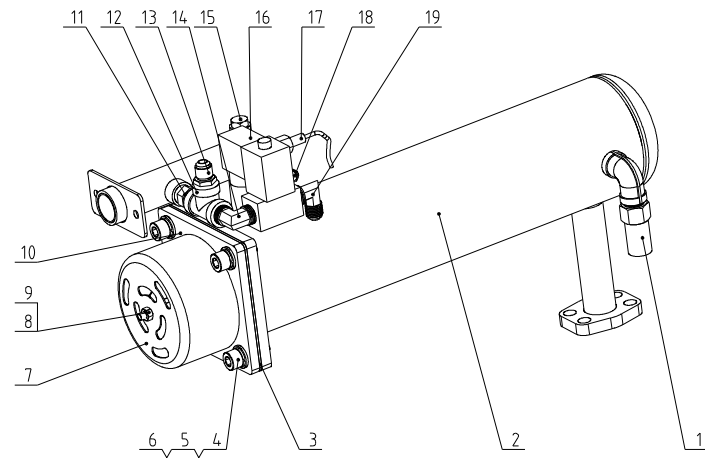
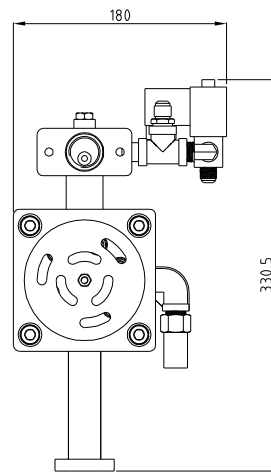
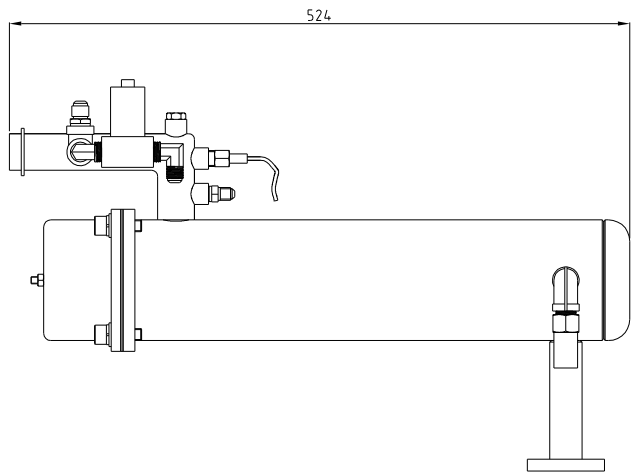

| | | | | | |
|----|----------------|--|--------|----|----|
| 19 | YW04030800300 | Copper Flared Tube Fitting 3/8"x1/8" L-shaped | H58 | 1 | |
| 18 | BH12019200010 | Pressure gauge connector S-152(152) | H62 | 1 | |
| 17 | BE90342500050 | Thermopile 20 (high temp), 20 (high temp) HT | | 1 | |
| 16 | YE32203000900 | Solenoid valve 3/8" 24VDC 15W 24VDC Air MC | | 1 | |
| 15 | BH12010400710 | Screw at tank bottom 1/4" PT (S-11-0) | Cu | 1 | |
| 14 | YW04030800100 | Copper pipe coupler 3/8"x1/8" L-type | H62 | 1 | |
| 13 | BH12030800610 | Eye Ring for 3/8" 304 (high temp) (high temp) | H62 | 1 | |
| 12 | YW52030800000 | Stainless steel water pipe three-way 3/8" 304 | SUS304 | 1 | |
| 11 | BH12030800110 | Copper pipe coupler 3/8"x1/8" (S-11) | H58 | 1 | |
| 10 | BH70091000250 | Hex nut for 3/8" 304 (high temp) (high temp) | | 1 | |
| 9 | YW64000600300 | Hexagonal nut G2/76170 NF-Longzine | | 1 | |
| 8 | YW66061300000 | Flat washer 1 grade G2/76171 F-Longzine | | 1 | |
| 7 | BL80091000120 | Hex nut F304 (high temp) (high temp) (high temp) | SPCC12 | 1 | |
| 6 | YW66102500000 | Flat washer 10x25x1.5 Longzine | | 4 | |
| 5 | YW65010000000 | Standard spring washer G2/76173 H-Longzine | | 4 | |
| 4 | YW61102500000 | Hex nut and flat washer G2/76171 H-Longzine | | 4 | |
| 3 | YR20121200000 | Flexible graphite gasket 120x120x2.0mm | ISO-68 | 1 | |
| 2 | STM-910PW-B-01 | Heating Bucket | | 1 | |
| 1 | BY90202200110 | Heater relief valve 1/2" 150PSI G-41-252 | Cu | 1 | |
| 序号 | 代号 | 名称 | 材质 | 数量 | 备注 |

Technical requirements:

1. Trimming and deburring;
2. Dimensional tolerances not specified shall be in accordance with GB/T1804-2000 Tolerances for linear and angular dimensions without specified tolerances The M-level regulations.
3. Raw tape should be wrapped around each threaded connection to ensure that no leakage occurs at each threaded connection.

| | | | | | | | | | | | | | | |
|----|-----|-----|-----|----|----|--|----|--|--|-----------|----|----------------|----|------|
| | | | | | 制图 | | 版号 | | 标题 | STM-910PW | 图号 | STM-910PW-B-03 | 比例 | 数量 |
| | | | | | 设计 | | 核准 | | 加热桶组件 | | | | | 材质 |
| | | | | | 校对 | | | | 信易电热机械股份有限公司 Shini Plastics Technologies, Inc. | | | | | 表面要求 |
| 标记 | 更改前 | 更改后 | 更改人 | 日期 | 审核 | | 日期 | | | | | | | |

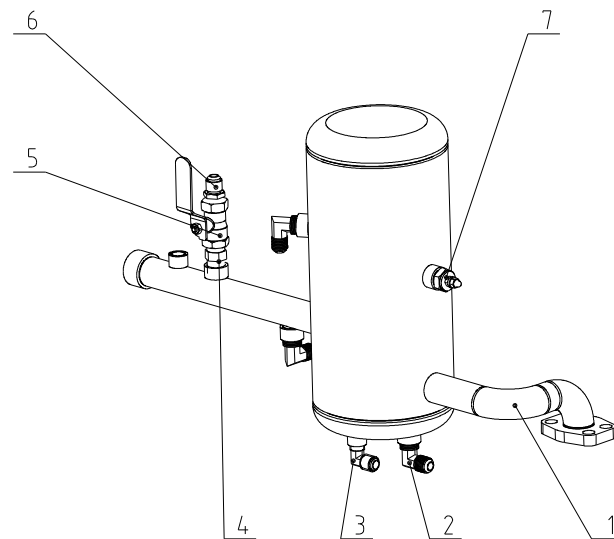
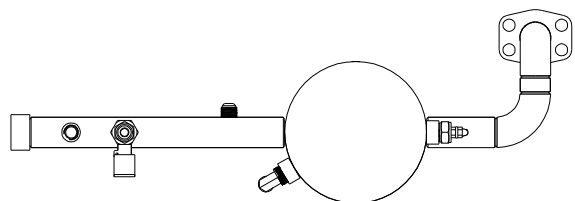
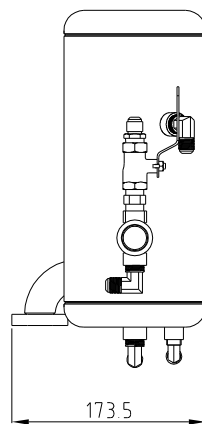
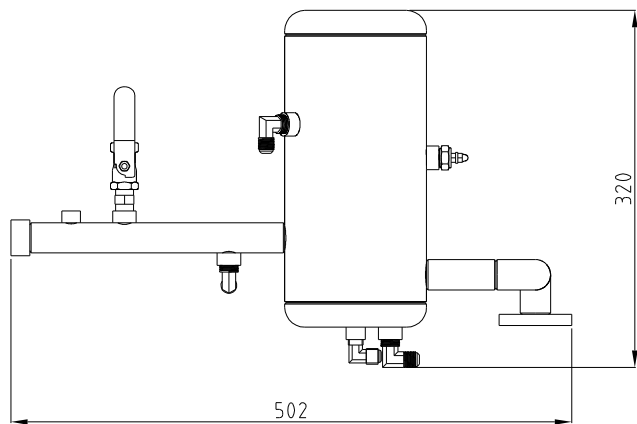

技术要求:

1. 修边去毛刺;
2. 未注尺寸公差按GB/T1804-2000《未注公差的线性尺寸和角度尺寸的公差》的m级规定。
3. PT牙需缠绕铁氟龙胶带, 各接口处保证在1.5Mpa下不泄漏。

| | | | | | |
|----|----------------|--|-----|----|----|
| 7 | YW09003800500 | Water level probe single copper fitting 3/8" female on lead with 1/2" threaded (1.5kg) | | 1 | |
| 6 | BH12030800610 | Turn-on pipe connector 3/8PT*3/8(S degree) (Drawing No. 5-118) | H62 | 1 | |
| 5 | YW50382300500 | Stainless steel ball valve 3/8" inch pressure resistance 1.5MPa (PT) | | 1 | |
| 4 | BH12030800110 | Copper connector 3/8PT*3/8PT(S-07) | H58 | 1 | |
| 3 | YW04030800200 | Copper Filling tube external torch joint 3/8" * 1/4" type | H58 | 1 | |
| 2 | YW04030800300 | Copper Filling pipe joint 3/8" * 3/8" type | H58 | 3 | |
| 1 | STM-910PW-B-02 | Return water pipe | | 1 | |
| 序号 | 代号 | 名称 | 材质 | 数量 | 备注 |

| | | | | | | | | | | | | | | | | |
|----|-----|-----|-----|----|----|--|----|--|--|-----------|------|----------------|-----|----|----|--|
| | | | | | 制图 | | 版号 | | 标题 | STM-910PW | 图号 | STM-910PW-B-04 | 比例 | | 数量 | |
| | | | | | 设计 | | 核准 | | 回水管组件 | | | | | 材质 | | |
| | | | | | 校对 | | | | 信易電熱機械股份有限公司 Shini Plastics Technologies, Inc. | | 表面要求 | | | | | |
| 标记 | 更改前 | 更改后 | 更改人 | 日期 | 审核 | | 日期 | | | | | | 物料号 | | | |

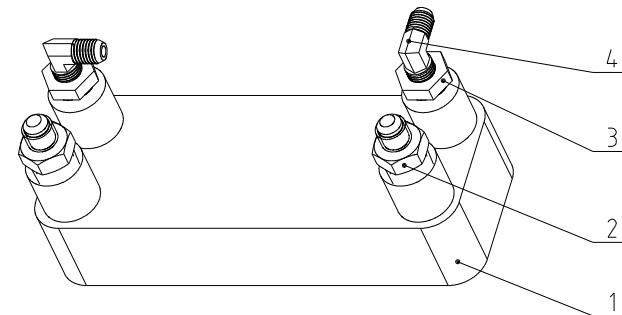
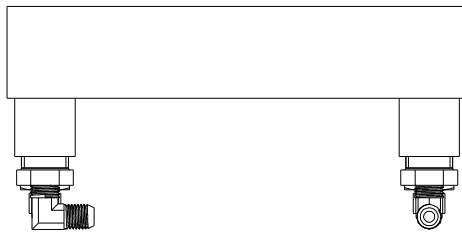
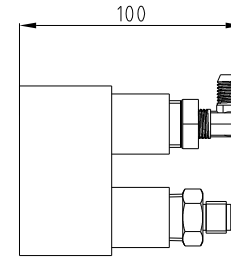
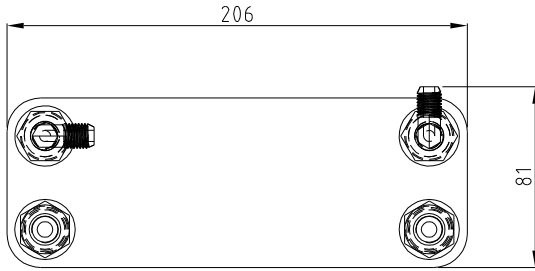

Technical requirements:

1. Trimming and deburring;
2. Dimensional tolerances not specified shall be in accordance with GB/T1804-2000

Tolerances for linear and angular dimensions without specified tolerances The M-level regulations.

3. Each screw thread connection must be sealed to ensure no leakage at 1.5MPa.

| 序号 | 代号 | 名称 | 材质 | 数量 | 备注 |
|----|---------------|--|--------|----|----|
| 4 | YW04010400400 | Tyfon pipe connector (C-shaped) 1/4" PT/1/4" H | H62 | 2 | |
| 3 | YW59121400000 | Stainless steel connector 1/2" PT male thread/1/2" PT female thread (SUS304) | SUS304 | 2 | |
| 2 | BH12030800210 | Tyfon pipe male thread connector 3/8"PT/2PT(S-9) | H62 | 2 | |
| 1 | YW87141400100 | Plate hot exchange 216*90 hole and outlet (PT thread) (standard) | | 1 | |

| 标记 | 更改前 | 更改后 | 更改人 | 日期 | 制图 | 版号 | 标题 | 图号 | 比例 | 数量 | 备注 |
|----|-----|-----|-----|----|----|----|-----------|----------------|------|----|----|
| | | | | | 设计 | 核准 | STM-910PW | STM-910PW-B-10 | 1:1 | 2 | |
| | | | | | 校对 | | 板换部件 | | 表面要求 | | |
| | | | | | 审核 | | | | 物料号 | | |
| | | | | | | | | | | | |



信易電熱機械股份有限公司
Shini Plastics Technologies, Inc.

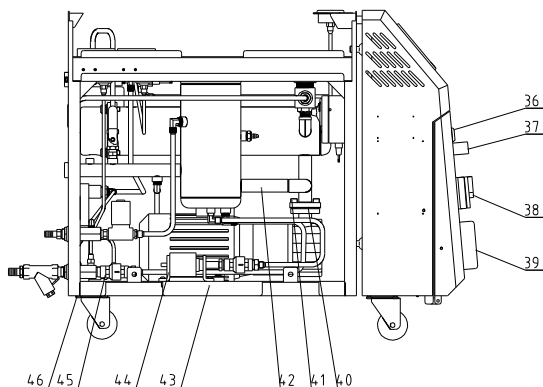
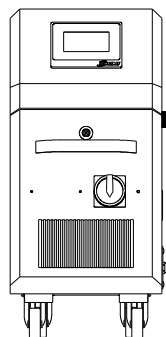
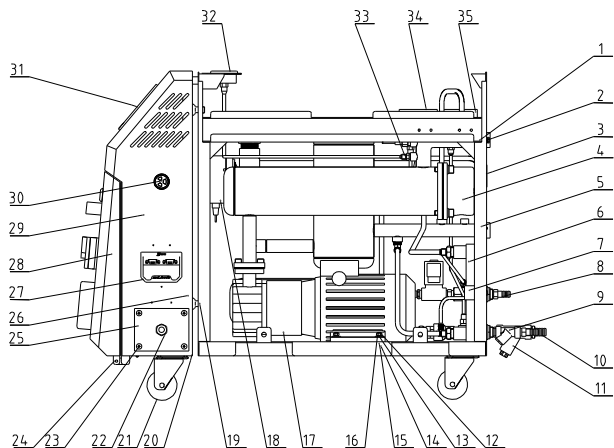

| 4.6 | YW62061000000 | Large cross recessed flat head screw M6x10 | Q235A | 16 | JIS1111 | 3 | YR40523040000 | Plastic flexible buckle | PVC | 1 | 52x30 | has mould |
|-----|-----------------|--|-------|------|----------|-----|-----------------|-------------------------|-------|------|---------|-----------|
| 4.5 | STM-607PW-D-ALL | Refilling connector assembly | | 1 | Assembly | 2 | YW66061300000 | Flat washer A grade 6 | Q235A | 4 | | |
| 4.4 | STM-607PW-F-ALL | Plunger pump refilling assembly | | 1 | Assembly | 1 | YW60061500100 | Hex. bolt M6x16 | 12.9 | 2 | | GB/T5783 |
| No. | Material number | Name | Mat. | Num. | Remarks | No. | Material number | Name | Mat. | Num. | Remarks | |

| Cooling Method | Heating Tank Qty | Pump Max. Pressure (bar) | Max. pump Flow (L/min) (50/60Hz) | Pump Power(kW) (50/60Hz) | Heater kW | Weight kW | Ver. |
|------------------|------------------|--------------------------|-------------------------------------|-----------------------------|-----------------------------|---------------------------|------|
| Indirect Cooling | 1 | 5.8 | 50/60 | 1.05/1.2 | 12 | 95 | J |
| | | Max. Temp. | Ext. Size (mm)(H×W×D) | Inlet /Outlet Size (inch) | Sub water tank capacity (L) | Heating tank capacity (L) | |
| | | 180°C | 690×320×990 | 2/2 | 1.4 | 3.4 | |

| | | | | | |
|-----|-------------------|--|---------|----|--------------------|
| 4.3 | YW67481900000 | Cross recessed pan head self-lapping screw | Q235A | 4 | GB/T15856.1 |
| 4.2 | STM-1220PW-C-ALL | Return water pipe assembly | | 1 | Assembly |
| 4.1 | YW61082001200 | Inner hex. column head screw M8x20 | 12.9 | 12 | GB/T770.1 |
| 4.0 | YR10110000000 | MP-100 graphite washer | ISO-68 | 2 | has mould |
| 3.9 | YW90120700000 | Alu. cooler | 6061 | 1 | |
| 3.8 | YE10125250000 | Main power switch | Q235A | 1 | P1-25 |
| 3.7 | YW20660900100 | Alu. door plank handle | 2024 | 1 | 6609(Yaxuan) |
| 3.6 | YW00000000100 | Long door lock | PVC | 1 | |
| 3.5 | YE90000800000 | Low pressure switch controller | PVC | 1 | 0-8KG/auto |
| 3.4 | YE90002000000 | Pressure switch controller HLP520E | PVC | 1 | 5-20KG auto reset |
| 3.3 | S-192 | Pressure gauge connector | H62 | 1 | 1/4"PT×1/4"H |
| 3.2 | YW85015000000 | Pressure gauge | | 1 | 0-1.5MPa range |
| 3.1 | YE81850100100 | STM controller | | 1 | |
| 3.0 | YE84003500200 | buzzer PK-3A 220V | PVC | 1 | |
| 2.9 | STM-607PW-ALL-01 | Control box | | 1 | Welding parts |
| 2.8 | STM-607PW-ALL-02 | Door plank | | 1 | Welding parts |
| 2.7 | | RS485 comm. connector | | 1 | Assembly |
| 2.6 | STM-1220PW-ALL-03 | Control bottom plate | SECC15 | 1 | |
| 2.5 | SG-S-01 | Wire clamp fixed plate | SPCC2.0 | 1 | |
| 2.4 | YW06219100000 | Large hinge | 2024 | 2 | Shengjiu CL219-1 |
| 2.3 | YW62051000100 | Large cross recessed flat head screw M5x10 | Q235A | 6 | JIS1111 |
| 2.2 | YE67201500100 | Copper nickel plated cable head | H62 | 1 | for 2.5x4C cable |
| 2.1 | YW03002500000 | Castor | | 4 | 2.5"without brake |
| 2.0 | STM-607PW-ALL-03 | Control box rear plate | | 1 | Welding parts |
| 1.9 | YW65008000100 | Standard spring washer 8 | 65Mn | 4 | GB/T93 |
| 1.8 | BH90115000050 | High temp. tester | | 1 | EGO |
| 1.7 | MP-100 | Magnetic drive pump MP-100 | QT4.00 | 1 | 1KW Aubo |
| 1.6 | YW65006000100 | Standard spring washer 6 | 65Mn | 10 | GB/T93 |
| 1.5 | YW66082200100 | Large washer C grade | Q235A | 8 | GB/T96818.4x24x2) |
| 1.4 | YW60062500000 | Hex. bolt M6x25 | 4.8 | 4 | GB/T5781 |
| 1.3 | YW66061800000 | Flat washer A grade | Q235A | 4 | GB/T96.1(6x18x1.5) |
| 1.2 | YW64000600300 | Hexnut M6 | Q235A | 6 | GB/T6170 |
| 1.1 | YW57010200000 | Y-type strainer | H62 | 1 | 1/2"PT 30-35 mesh |
| 1.0 | S-133 | Copper insert | H58 | 1 | |
| 9 | STM-607PW-B-21 | Cooling water inlet connector | | 1 | Welding parts |
| 8 | STM-607PW-E-ALL | Drainage connector | | 1 | |
| 7 | STM-1220PW-ALL-04 | Plate exchange fixed plate | SPCC2.0 | 1 | |
| 6 | STM-1220PW-D-B-29 | Right plate exchanger | | 1 | |
| 5 | STM-1220PW-A-ALL | Rack | | 1 | Welding parts |
| 4 | STM-1220PW-B-ALL | Heating tank assembly | | 1 | Assembly |

| | | | | | | | | | | | | |
|----|-----|-----|-----|----|----|----|---|------------|----|----------------|------|----|
| | | | | | 制图 | 版号 | 标题 | STM-1220PW | 图号 | STM-1220PW-ALL | 比例 | 数量 |
| | | | | | 设计 | 核准 | 高温水式模温机 | | | | | 材质 |
| | | | | | 校对 | | 信易电热机械股份有限公司 Shini Plastics Technologies, Inc. | | | | 表面要求 | |
| 标记 | 更改前 | 更改后 | 更改人 | 日期 | 审核 | 日期 | | | | | 物料号 | |

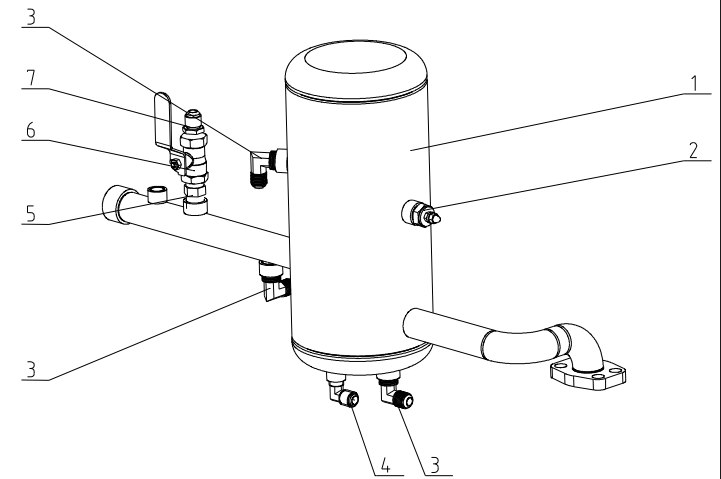
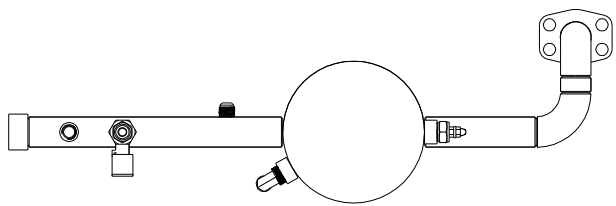
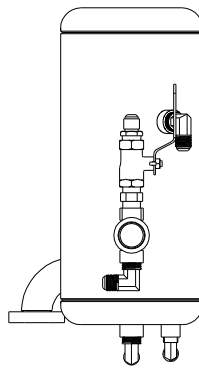
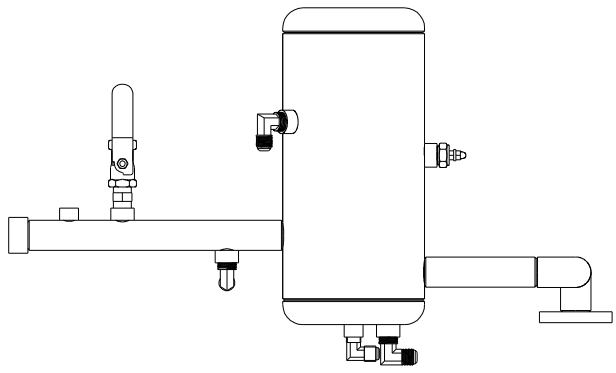

| | | | | | |
|-----|-----------------|--------------------------------|--------|------|---|
| 7 | S-116 | Tonflon pipe male thread elbow | H62 | 1 | 3/8"PT×3/8"H |
| 6 | YW50382300500 | Ball valve 3/4" | SUS304 | 1 | One piece withstand pressure |
| 5 | S-07 | Copper connector | H58 | 1 | 3/8"PT×3/8"PT |
| 4 | YW04030800200 | Tonflon pipe male thread elbow | H58 | 1 | 3/8H×1/4PTL type |
| 3 | YW04030800300 | Tonflon pipe connector | H58 | 3 | 3/8"PT×3/8"H L |
| 2 | YW09003800500 | Single water level probe | Q235A | 1 | 3" without lead wire withstand pressure 15Mpa |
| 1 | STM-1220PW-C-01 | Return water pipe | | 1 | welding parts |
| No. | Material number | Name | Mat. | Num. | Remarks |

| | | | | | | | | | | |
|----|-----|-----|-----|----|----|----|---|------------------|-----|------|
| | | | | | 制图 | 版号 | 标题 | 图号 | 比例 | 数量 |
| | | | | | 设计 | 核准 | STM-1220PW | STM-1220PW-C-ALL | | 材质 |
| | | | | | 校对 | | 回水管部件 | | | 表面要求 |
| 标记 | 更改前 | 更改后 | 更改人 | 日期 | 审核 | 日期 | 信易電熱機械股份有限公司 Shini Plastics Technologies, Inc. | | 物料号 | |

| Cooling Method | Heating Tank Qty | Pump Max. Pressure (bar) | Max. pump Flow (L/min) (50/60Hz) | Pump Power(kW) (50/60Hz) | Heater kW | Weight kW | Ver. |
|------------------|------------------|--------------------------|-------------------------------------|-----------------------------|---------------------------|-----------|------|
| Indirect Cooling | 2 | 5.8 | 50/60 | 1.05×2/1.2×2 | 12×2 | 190 | D |
| | Max. Temp | Ext. Size (mm)(H×W×D) | Inlet /Outlet Size (inch) | Sub water tank capacity (L) | Heating tank capacity (L) | | |
| | 180°C | 750×620×990 | 3/4 | 1.4×2 | 3.2×2 | | |

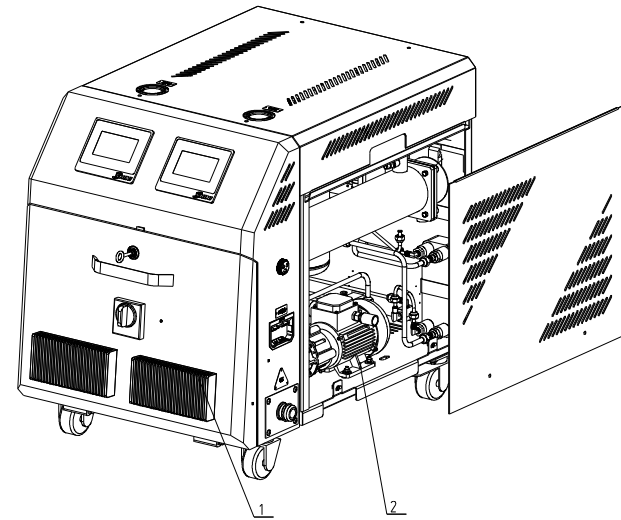
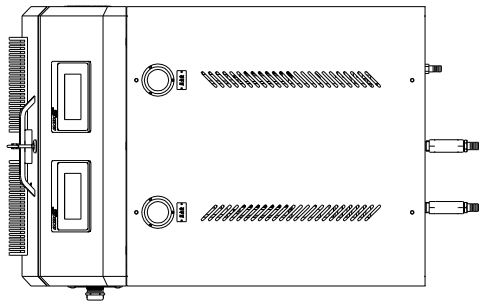
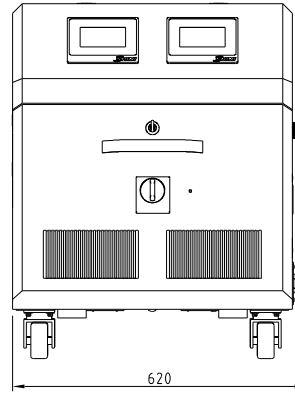
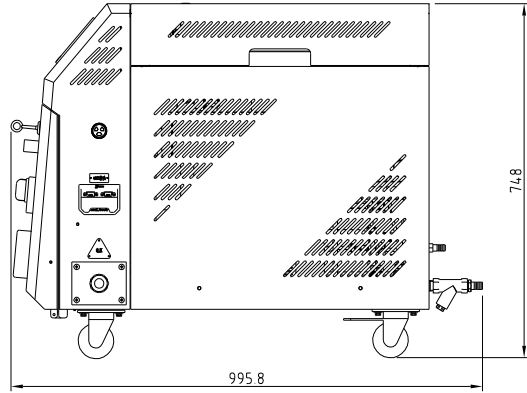

| 2 | STM-1220PW-D-A-ALL | internal structure | | 1 | |
|-----|--------------------|----------------------|------|------|---------|
| 1 | STM-1220PW-D-A-ALL | external sheet metal | | 1 | |
| No. | Material number | Name | Mat. | Num. | Remarks |

| | | | | | | |
|----|-----|-----|-----|----|----|----|
| | | | | | 制图 | 版号 |
| | | | | | 设计 | 核准 |
| | | | | | 校对 | |
| 标记 | 更改前 | 更改后 | 更改人 | 日期 | 审核 | 日期 |

| | | | | | |
|---|--------------|----|------------------|------|----|
| 标题 | STM-1220PW-D | 图号 | STM-1220PW-D-ALL | 比例 | 数量 |
| 高温型双段水式模温机 | | | | | 材质 |
| 信易电热机械股份有限公司 Shini Plastics Technologies, Inc. | | | | 表面要求 | |
| | | | | 物料号 | |

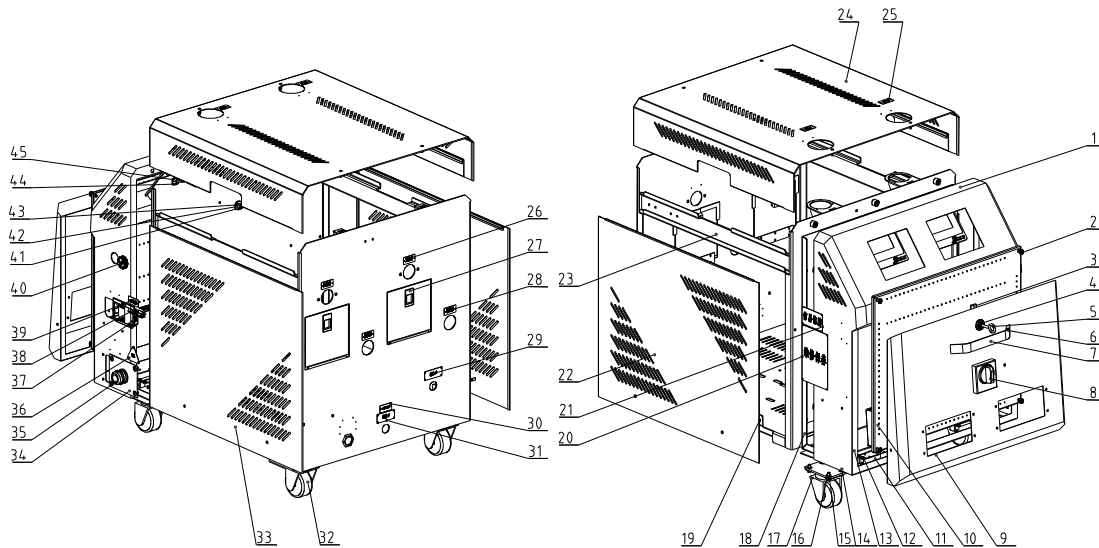
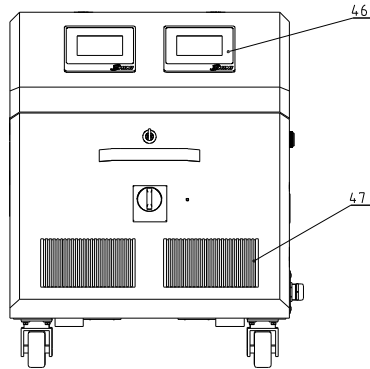
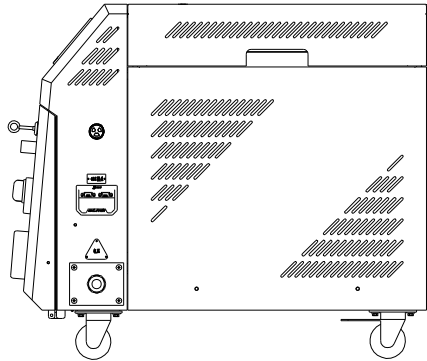

| | | | | | |
|-----|-------------------|---|---------|------|-----------------------------|
| 47 | YW90120700000 | Alu. cooler | 6061 | 2 | |
| 46 | YE81850100100 | STM connector | | 2 | |
| 45 | YW66081600000 | Flat washer A grade (8.4×16×16) | Q235A | 3 | GB/T97.1 |
| 44 | YW69081500000 | Butterfly bolt M8×15 | Q235A | 3 | GB/T 3098 |
| 43 | YW65008000100 | Standard spring washer 8 | 65Mn | 9 | GB/T93 |
| 42 | YW66082200100 | Large washer C grade | Q235A | 6 | GB/T968(8.4×24×2) |
| 41 | YW61082001200 | Inner hex. column head screw M8×20 | 12.9 | 6 | GB/T70 1 |
| 40 | YE84.003500600 | Buzzer PK-35A 24V | PVC | 1 | |
| 39 | YP30048500000 | Alu. plate lable | 2024 | 1 | 485 comm. connector |
| 38 | YE90048501200 | RS485 comm. interface plate | | 1 | |
| 37 | YR4.00485000000 | Shell RS485 | | 1 | |
| 36 | YP31051650000 | Power Alu. plate lable | 2024 | 1 | Power triangle 3-phase 400V |
| 35 | YE67321500100 | Copper nickel plated cable connector | H62 | 1 | |
| 34 | SG-S-01 | Wire clamp fixed plate | SPCC2.0 | 1 | |
| 33 | STM-1220PW-D-A-06 | Right side plate | | 1 | Welding parts |
| 32 | YW03000300000 | 3" without brake castor | Q235A | 2 | |
| 31 | YP30431000000 | Alu. plate lable | 2024 | 1 | water inlet |
| 30 | YP3109104.00000 | Alu. plate lable | 2024 | 1 | Clean the filter regularly |
| 29 | YP30430000000 | Alu. plate lable | 2024 | 1 | water outlet |
| 28 | YP30422000000 | Alu. plate lable | 2024 | 2 | from mould |
| 27 | YR40523040000 | Plastic stretch buckle | PVC | 2 | 52×30 has mould |
| 26 | YP30423000000 | Alu. plate lable | 2024 | 2 | to mould |
| 25 | YP30425000000 | Alu. plate lable | 2024 | 2 | Pressure gauge |
| 24 | STM-1220PW-D-A-08 | Cover plate | | 1 | Welding parts |
| 23 | STM-1220PW-D-A-01 | Rack | | 1 | Welding parts |
| 22 | STM-1220PW-D-A-07 | Left side plate | | 1 | Welding parts |
| 21 | YP30437000000 | Alu. plate lable | 2024 | 1 | Shin nameplate |
| 20 | YP31115800600 | Alu. plate lable | 2024 | 1 | STM repair & maintenance |
| 19 | YW01051000000 | Pin spring | 65Mn | 8 | for STM new model |
| 18 | STM-1220PW-D-A-02 | Control box rear plate | | 1 | Welding parts |
| 17 | YW03000300200 | 3" without brake castor | Q235A | 2 | |
| 16 | YW65060000000 | Standard spring washer 6 | 65Mn | 16 | GB/T93 |
| 15 | YW66061800000 | Large washer A grade | Q235A | 16 | GB/T96.1(6×18×15) |
| 14 | YW60061500100 | Hex. bolt M6×16 | 12.9 | 16 | GB/T5783 |
| 13 | YW67040600600 | Cross recessed pan head tapping lock screw M4×6 | Q235A | 6 | GB6560 |
| 12 | YW62051000100 | Large cross recessed flat head screw M5×10 | Q235A | 12 | JIS1111 |
| 11 | YW06219100000 | Large hinge | 2024 | 2 | Shengjiu CL219-1 |
| 10 | STM-1220PW-D-A-04 | Control bottom plate | SECC1.5 | 1 | |
| 9 | STM-1220PW-D-A-05 | Door plank | | 1 | Welding parts |
| 8 | YE10021160000 | Main power switch | PVC | 1 | TO-2-1/EA/SVB/16A Mu Le |
| 7 | YW20660900100 | Alu. door plank handle | 2024 | 1 | 6609(Ya Xuan) |
| 6 | YW63040600000 | Cross recessed pan head screw M4×6 | Q235A | 2 | GB/T-823 |
| 5 | YW00040600200 | Long door lock key | SUS201 | 1 | CF-406-DH |
| 4 | YW00000000100 | Long door lock | PVC | 1 | |
| 3 | YW00040600000 | Long door lock fender | SUS201 | 1 | MF-406-DH |
| 2 | YW63062000000 | Cross recessed pan head screw M6×20 | Q235A | 4 | GB/T-818 |
| 1 | STM-1220PW-D-A-03 | Control box | | 1 | Welding parts |
| No. | Material number | Name | Mat. | Num. | |

| 标记 | 更改前 | 更改后 | 更改人 | 日期 | 制图 | 版号 | 标题 | 图号 | 比例 | 数量 | |
|----|-----|-----|-----|----|----|----|---|--------------------|-----|------|--|
| | | | | | 制图 | | STM-1220PW-D | STM-1220PW-D-A-ALL | | | |
| | | | | | 设计 | | 外壳钣金 | | 1:1 | 1 | |
| | | | | | 校对 | | | | 材质 | | |
| | | | | | 审核 | | 信易电热机械股份有限公司 Shini Plastics Technologies, Inc. | | | 表面要求 | |
| | | | | | 日期 | | | | | 物料号 | |

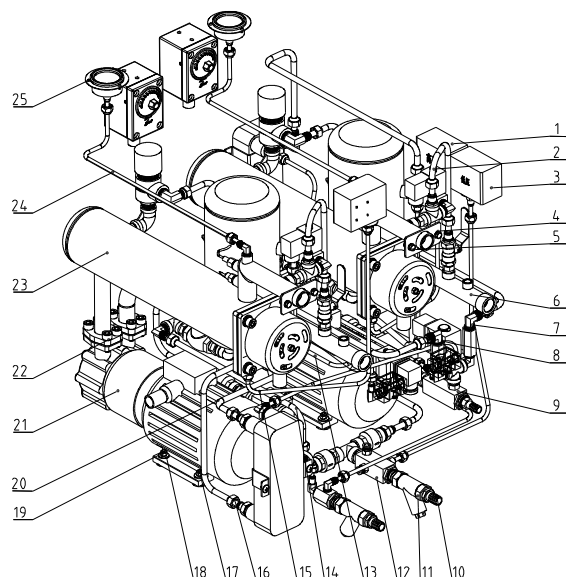
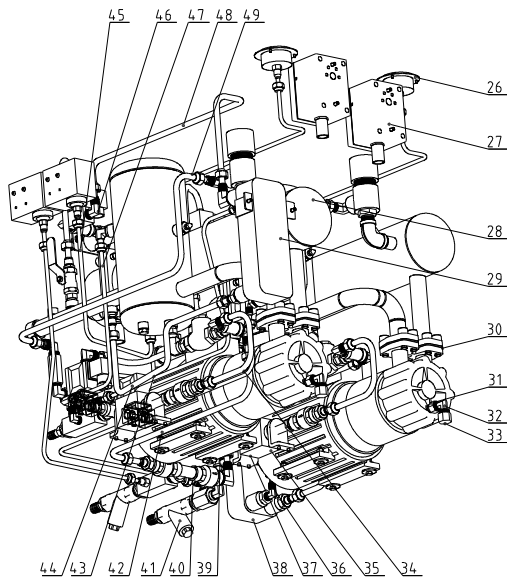
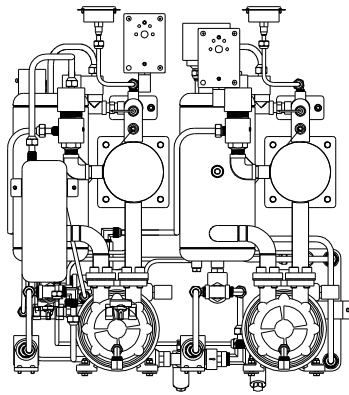
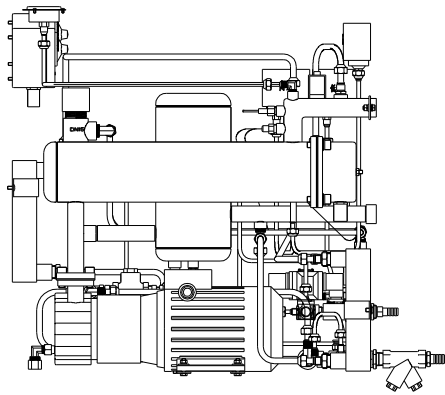

| 4.9 | STM-1220PW-D-B-14 | Left exhaust air pipe | | 1 | |
|-----|-------------------|-----------------------|------|------|---------|
| No. | Material number | Name | Mat. | Num. | Remarks |

| 4.8 | STM-1220PW-D-B-31 | Left plate exchanger hot water inlet pipe | | 1 | |
|-----|-------------------|--|---------|------|----------------------|
| 4.7 | STM-1220PW-D-B-11 | Left pressure release pipe | | 1 | |
| 4.6 | YW04030800300 | Copper pipe connector | H58 | 5 | 3/8"PT×3/8"H L |
| 4.5 | STM-1220PW-D-B-18 | Left high pressure pipe | | 1 | |
| 4.4 | STM-1220PW-D-B-32 | Left plate exchanger hot water outlet pipe | | 1 | |
| 4.3 | STM-1220PW-D-B-15 | Left cooling water outlet pipe | | 1 | |
| 4.2 | STM-1220PW-D-B-13 | Left refilling pipe | | 1 | |
| 4.1 | STM-1220PW-D-B-35 | Cooling water inlet connector assembly | | 1 | Welding parts |
| 4.0 | STM-1220PW-D-B-17 | Left cooling water inlet pipe | | 1 | |
| 39 | YW62061000000 | Large cross recessed flat head screw M6×10 | SUS304 | 2 | JIS1111 |
| 38 | STM-1220PW-D-B-29 | Right plate exchanger | | 1 | |
| 37 | STM-607PW-F-ALL | Plunger pump refilling assembly | | 2 | |
| 36 | STM-1220PW-D-B-24 | Right cooling water inlet pipe | | 1 | |
| 35 | STM-607PW-B-20 | Plate exchange fixed plate | SPCC2.0 | 2 | |
| 34 | STM-1220PW-D-B-12 | Plunger pump refilling pipe | | 2 | |
| 33 | S-171 | Teflon pipe plug | H58 | 2 | 3/8"H plug |
| 32 | YW04030800400 | Copper pipe connector | H58 | 2 | 1/4"PT×3/8"H L |
| 31 | STM-907HT-B-17 | Oil discharge long screw | H58 | 2 | borrow |
| 30 | YR10110000000 | MP-100 graphite gasket | ISO-68 | 4 | has mould |
| 29 | STM-1220PW-D-B-30 | Left plate exchanger | | 1 | |
| 28 | STM-1220PW-D-B-22 | Right exhaust pipe | | 1 | |
| 27 | BH90115000050 | High temp. tester | | 2 | EGO |
| 26 | YW85015000000 | Pressure gauge | | 2 | 0~15MPa range |
| 25 | YW63030600000 | Cross recessed pan head screw M3×6 | Q235A | 6 | GB/T-823 |
| 24 | STM-1220PW-D-B-20 | Pressure gauge pipe | | 2 | |
| 23 | STM-1220PW-D-B-03 | Heating tank assembly | | 2 | assembly |
| 22 | YW61102500000 | Inner hex column head screw M10×25 | 12.9 | 16 | GB/T170.1 |
| 21 | MP-100 | Magnetic driven pump MP-100 | QT400.2 | 2 | 1KW 50L/Min 58M Anbo |
| 20 | STM-1220PW-D-B-33 | Right plate exchange hot water inlet pipe | | 1 | |
| 19 | YW65060000000 | Standard spring washer 6 | 65Mn | 12 | GB/T93 |
| 18 | YW66061800000 | Large washer A grade | Q235A | 8 | GB/T96 1(6×18×15) |
| 17 | YW60062500000 | Hex bolt M6×25 | 4.8 | 8 | GB/T5781 |
| 16 | STM-1220PW-D-B-34 | Right plate exchange hot water outlet pipe | | 1 | |
| 15 | STM-1220PW-D-B-26 | Right high pressure pipe | | 1 | |
| 14 | STM-1220PW-D-B-23 | Right water refilling pipe | | 1 | |
| 13 | STM-1220PW-D-B-21 | Right pressure release pipe | | 1 | |
| 12 | STM-1220PW-D-B-05 | Water refilling connector assembly | | 1 | |
| 11 | YW57010200000 | Y-type water strainer | H62 | 1 | 1/2" PT 30-35 mesh |
| 10 | S-133 | Copper insert | H58 | 1 | M16×1/2"PT |
| 9 | STM-1220PW-D-B-06 | Drainage connector assembly | | 1 | |
| 8 | STM-1220PW-D-B-25 | Right cooling water outlet pipe | | 1 | |
| 7 | STM-1220PW-D-B-10 | Low pressure pipe | | 1 | |
| 6 | STM-1220PW-D-B-04 | Return water pipe assembly | | 2 | |
| 5 | YW60061500100 | Hex. bolt M6×16 | 12.9 | 4 | GB/T5783 |
| 4 | YW66061300000 | Flat washer A grade 6 | Q235A | 8 | |
| 3 | YE90008000000 | Low pressure switch controller | PVC | 1 | 0-8KG/auto |
| 2 | STM-1220PW-D-B-16 | Hot water bypass pipe | | 2 | |
| 1 | YE90002000000 | Pressure switch controller HLP520E | PVC | 2 | 5~20KG auto reply |
| No. | Material number | Name | Mat. | Num. | Remarks |

| | | | | | | |
|----|-----|-----|-----|----|----|----|
| | | | | | 制图 | 版号 |
| | | | | | 设计 | 核准 |
| | | | | | 校对 | |
| 标记 | 更改前 | 更改后 | 更改人 | 日期 | 审核 | 日期 |

| | | | | | |
|---|--------------|----|--------------------|------|----|
| 标题 | STM-1220PW-D | 图号 | STM-1220PW-D-B-ALL | 比例 | 数量 |
| | 内部结构 | | | | 材质 |
| 信易电热机械股份有限公司 Shini Plastics Technologies, Inc. | | | | 表面要求 | |
| | | | | 物料号 | |

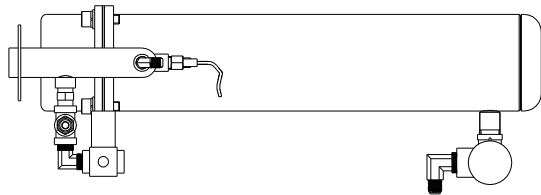
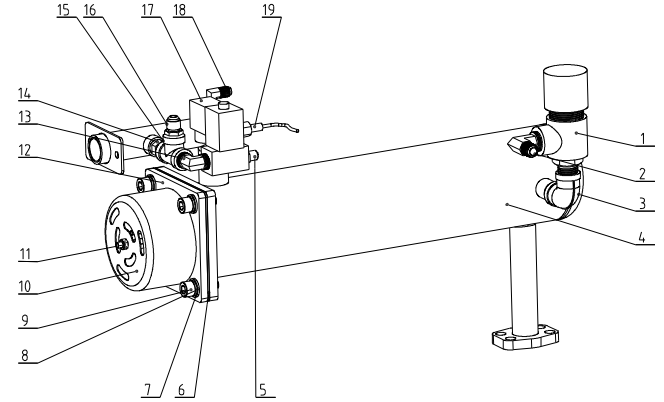
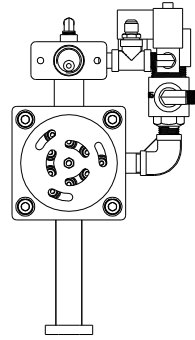
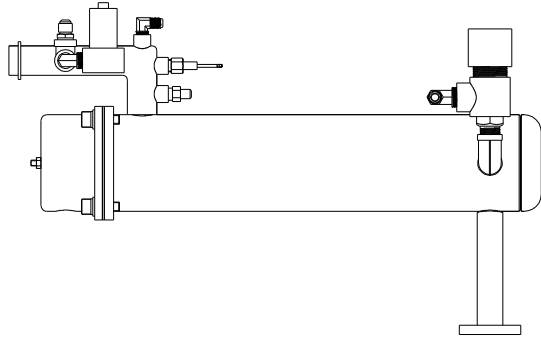

| | | | | | |
|-----|-------------------|-------------------------------------|---------|------|-------------------------------------|
| 19 | BE90341500050 | Thermocouple | SUS304 | 1 | 15M |
| 18 | YW04010400400 | Tonflon pipe male thread elbow | H62 | 1 | 1/4"Hx1/4"PT L |
| 17 | YE32203000900 | Solenoid valve | | 1 | 3/8" AirTAC 24VAC |
| 16 | S-116 | Tonflon pipe male thread elbow | H62 | 1 | 3/8"PTx3/8"H |
| 15 | YW52030800000 | 3/8" stainless steel 3-way | SUS304 | 1 | |
| 14 | S-07 | Copper connector | H58 | 1 | 3/8"PTx3/8"PT |
| 13 | YW04030800100 | Connector | H62 | 1 | 3/8"PT(L) |
| 12 | STM-1220PW-F-ALL | Pipe heater welding diagram | | 1 | Welding part borrow |
| 11 | YW64000600300 | Hex. nut M6 | Q235A | 1 | GB/T6170 |
| 10 | S-190 | Pipe heater cover | SPCC1.0 | 1 | |
| 9 | YW61103000100 | Inner hex. column head screw M10x30 | 12 9 | 4 | GB/T70.1 |
| 8 | YW65010000000 | Standard spring washer 10 | 65Mn | 4 | GB/T93 |
| 7 | YW66102000100 | Flat washer A grade 10 | Q235A | 4 | GB/T97.1 (11x20x2) |
| 6 | YR20121200000 | Flexible graphite gasket | ISO-68 | 1 | 120x120x2.0 |
| 5 | BH12010400410 | Tonflon pipe connector | H58 | 1 | 1/4"Hx1/4"PT |
| 4 | STM-1220PW-D-B-01 | Heating tank | | 1 | Welding part |
| 3 | YW53001200100 | Stainless steel wire elbow | SUS304 | 1 | 1/2"PT |
| 2 | YW04010200200 | Tonflon pipe connector | H58 | 1 | 1/2"Hx1/4"PT L type |
| 1 | YW05141200000 | Safety valve | SUS304 | 1 | 1/2" male thread withstand pressure |
| No. | Material number | Name | Mat. | Num. | Remarks |

| | | | | | | | | | | | | |
|----|-----|-----|-----|----|----|----|---|--------------|----|-------------------|------|----|
| | | | | | 制图 | 版号 | 标题 | STM-1220PW-D | 图号 | STM-1220PW-D-B-03 | 比例 | 数量 |
| | | | | | 设计 | 核准 | 加热桶组件 | | | | | 材质 |
| | | | | | 校对 | | 信易电热机械股份有限公司 Shini Plastics Technologies, Inc. | | | | 表面要求 | |
| 标记 | 更改前 | 更改后 | 更改人 | 日期 | 审核 | 日期 | | | | | 物料号 | |

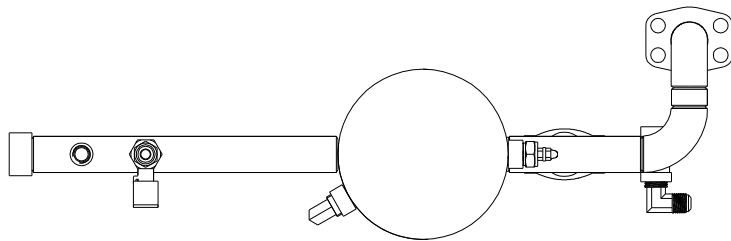
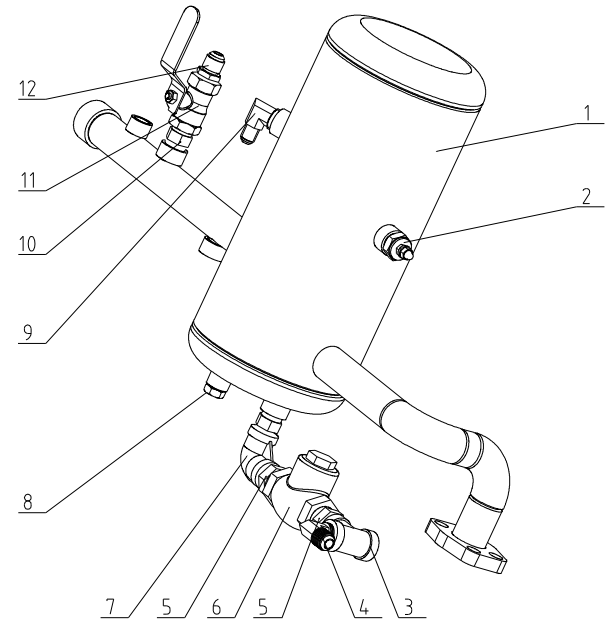
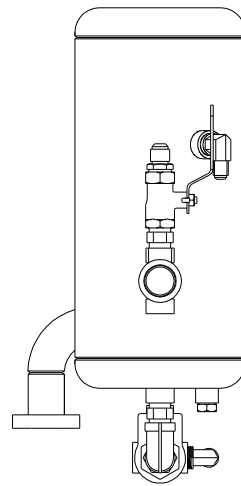
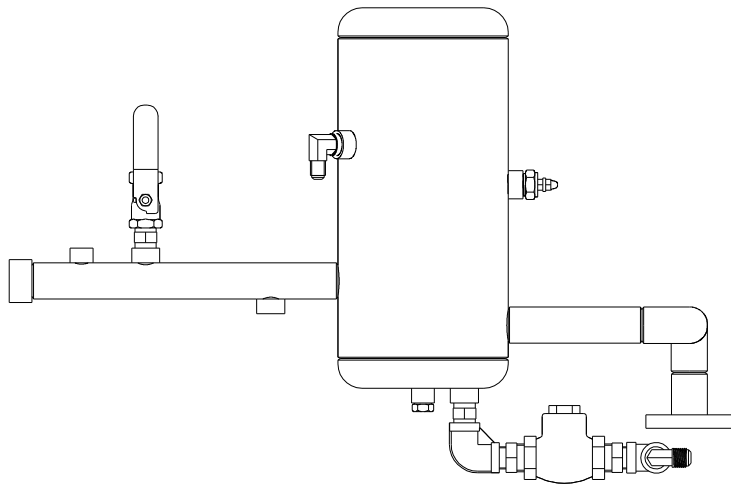

| | | | | | |
|-----|-------------------|--------------------------------|--------|------|---|
| 12 | S-116 | Tonflon pipe male thread elbow | H62 | 1 | 3/8"PT*3/8"H |
| 11 | YW50382300500 | Ball valve 3/8" | SUS304 | 1 | One piece withstand pressure 23MPaKITZ |
| 10 | S-07 | Copper connector | H58 | 2 | 3/8"PT × 3/8"PT |
| 9 | YW04030800500 | Tonflon pipe connector | H58 | 1 | 3/8"PT*1/4"H L |
| 8 | S-11 | Hopper bottom screw | H58 | 1 | 1/4"PT |
| 7 | YW53308000000 | 3/8" stainless steel elbow | SUS304 | 1 | |
| 6 | YW59010200300 | Rotary return valve R1/2" | Cu | 1 | KITZ |
| 5 | S-92 | Copper connector | H58 | 2 | 3/8"PT × 1/2"PT |
| 4 | YW04030800300 | Tonflon pipe connector | H58 | 1 | 3/8"PT*3/8"H L |
| 3 | YW52030800000 | 3/8" stainless steel 3-way | SUS304 | 1 | |
| 2 | YW09003800500 | Single water level probe | Q235A | 1 | 3" without lead wire withstand pressure 15Mpa |
| 1 | STM-1220PW-D-B-02 | Return water pipe | | 1 | welding parts |
| No. | Material number | Name | Mat. | Num. | Remarks |

| | | | | | | | | | | |
|----|-----|-----|-----|----|----|----|---|-------------------|----|----|
| | | | | | 制图 | 版号 | 标题 | 图号 | 比例 | 数量 |
| | | | | | 设计 | 核准 | STM-1220PW-D | STM-1220PW-D-B-04 | | 材质 |
| | | | | | 校对 | | 信易電熱機械股份有限公司 Shini Plastics Technologies, Inc. | 表面要求 | | |
| 标记 | 更改前 | 更改后 | 更改人 | 日期 | 审核 | 日期 | | 物料号 | | |

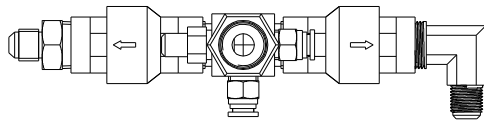
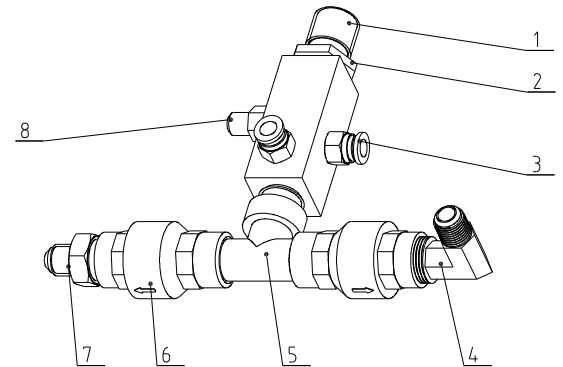
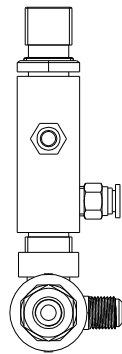
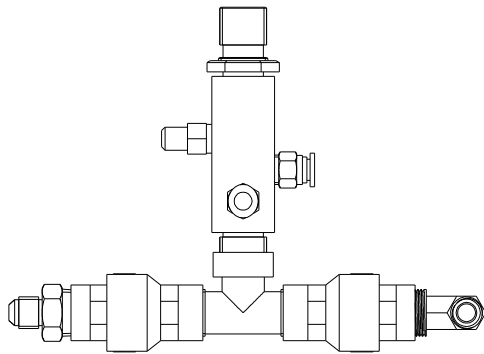

| | | | | | |
|-----|-----------------|--|--------|------|---------------------|
| 8 | BH12010400410 | Tonflon pipe connector | H58 | 1 | 1/4"H×1/4"PT |
| 7 | S-91 | Tonflon pipe male thread connector | H62 | 1 | 3/8"H×1/2"PT |
| 6 | YW59001201300 | Single way valve 1/2" VITON | Cu | 2 | RB |
| 5 | YW59123000100 | 1/2" male thread stainless steel 3-way | SUS304 | 1 | |
| 4 | YW04010200200 | Tonflon pipe connector | H58 | 1 | 1/2"PT×3/8"H L type |
| 3 | YW80081400000 | Screw direct connector 1/4-φ8 | SUS304 | 2 | AirTAC |
| 2 | S-136 | Common copper nut | H58 | 1 | thread M22×1.5 |
| 1 | STM-607PW-D-01 | Refilling connector | H58 | 1 | |
| No. | Material number | Name | Mat. | Num. | Remarks |

| | | | | | | | | | | |
|----|-----|-----|-----|----|----|----|---|-------------------|----|------|
| | | | | | 制图 | 版号 | 标题 | 图号 | 比例 | 数量 |
| | | | | | 设计 | 核准 | STM-1220PW-D | STM-1220PW-D-B-05 | | 材质 |
| | | | | | 校对 | | 信易電熱機械股份有限公司 Shini Plastics Technologies, Inc. | | | 表面要求 |
| 标记 | 更改前 | 更改后 | 更改人 | 日期 | 审核 | 日期 | | | | |

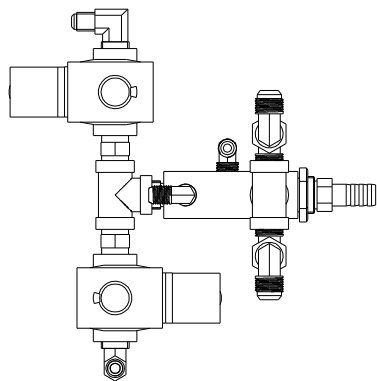
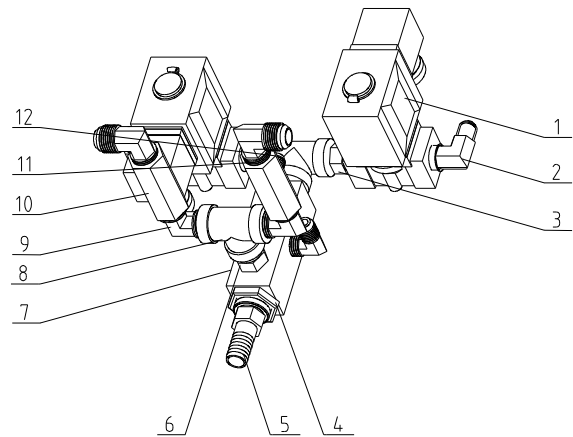
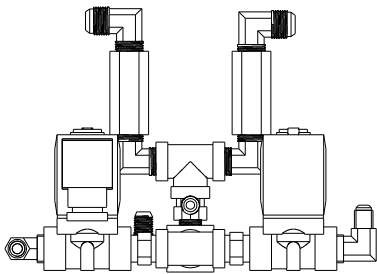
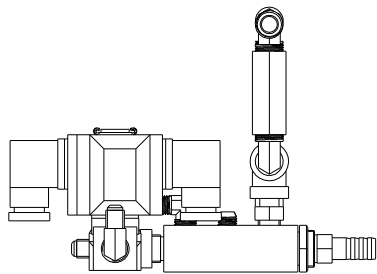

| | | | | | |
|-----|----------------------|--------------------------------|--------|------|---------------------|
| 12 | YW04010400400 | Tonflon pipe male thread elbow | H62 | 2 | 1/4"H*1/4"PT L |
| 11 | YW04030800600 | Tonflon pipe connector | H58 | 2 | 3/8"PT*3/8"H L |
| 10 | YW59383400000 | Single way valve 3/8" | SUS304 | 2 | 3/8" (SUS304) |
| 9 | YW04030800100 | Connector | H62 | 2 | 3/8"PT (L) |
| 8 | YW52030800000 | 3/8" stainless steel 3-way | SUS304 | 2 | |
| 7 | STM-1220PW-D-B-06/01 | Refiling connector | H58 | 1 | |
| 6 | S-50 | Tonflon pipe connector | H58 | 1 | 3/8"PT*1/4"PT |
| 5 | S-85 | Copper insert | H58 | 1 | 3/8"PT* diameter 13 |
| 4 | S-136 | Common copper nut | H58 | 1 | thread M22*1.5 |
| 3 | S-07 | Tonflon pipe connector | H58 | 2 | 3/8"PT x 3/8"PT |
| 2 | YW04030800500 | Tonflon pipe connector | H58 | 2 | 3/8"PT*1/4"H L |
| 1 | YE30003802400 | Solenoid valve 2LH050-10E | | 2 | 3/8" 24V AirTAC |
| No. | Material number | Name | Mat. | Num. | Remarks |

| | | | | | | | | | | |
|----|-----|-----|-----|----|----|----|--|-------------------|------|----|
| | | | | | 制图 | 版号 | 标题 | 图号 | 比例 | 数量 |
| | | | | | 设计 | 核准 | STM-607PW-D/1220PW-D | STM-1220PW-D-B-06 | | 材质 |
| | | | | | 校对 | | 排水接头组件 | | 表面要求 | |
| 标记 | 更改前 | 更改后 | 更改人 | 日期 | 审核 | 日期 | SHINI 信易電熱機械股份有限公司 Shini Plastics Technologies, Inc. | | 物料号 | |

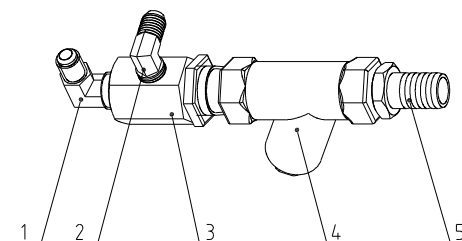
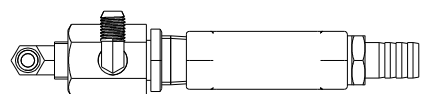
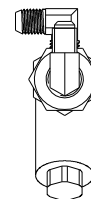
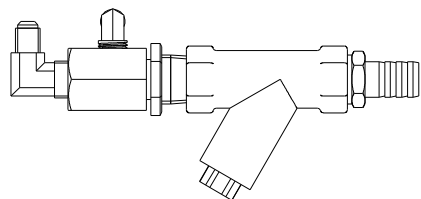

| | | | | | |
|----|-----------------|-------------------------------------|------|------|-------------------|
| 5 | S-133 | Copper insert | H58 | 1 | M16×1/2"PT |
| 4 | YW57010200000 | Y type strainer | H62 | 1 | 1/2"PT 30-35 mesh |
| 3 | S-142 | The 4th set of the copper connector | | 1 | |
| 2 | YW04010400400 | Tonflon pipe male thread elbow | H62 | 1 | 1/4"H×1/4"PT L |
| 1 | YW04030800500 | Tonflon pipe connector | H58 | 1 | 3/8"PT×1/4"H L |
| No | Material number | Name | Mat. | Num. | Remarks |

| | | | | | | | | | | | | |
|----|-----|-----|-----|----|----|----|---|--------------|----|-------------------|------|-----|
| | | | | | 制图 | 版号 | 标题 | STM-1220PW-D | 图号 | STM-1220PW-D-B-35 | 比例 | 数量 |
| | | | | | 设计 | 核准 | 冷却水进接头组件 | | | | | 材质 |
| | | | | | 校对 | | 信易電熱機械股份有限公司 Shini Plastics Technologies, Inc. | | | | 表面要求 | |
| 标记 | 更改前 | 更改后 | 更改人 | 日期 | 审核 | 日期 | | | | | | 物料号 |

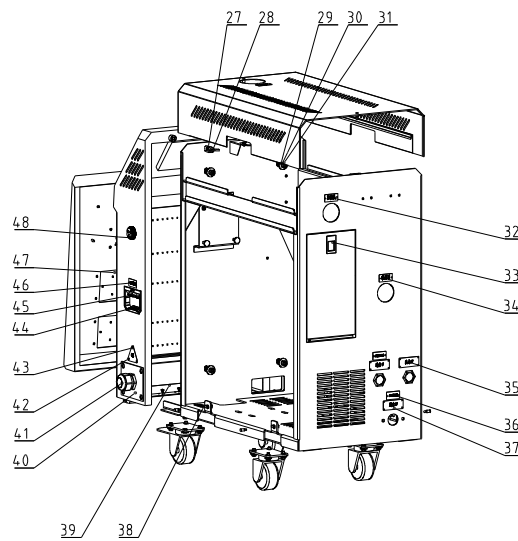
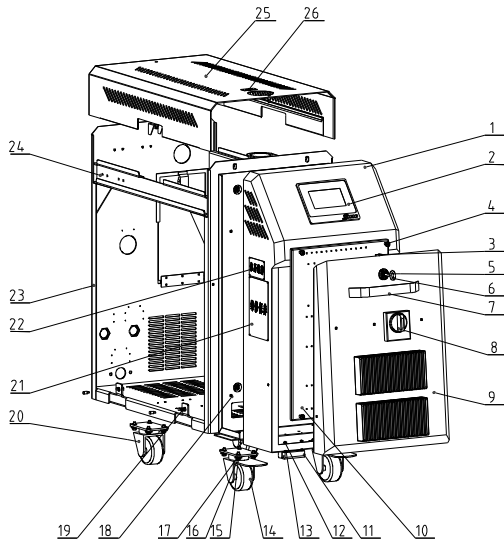
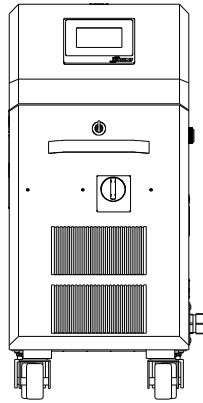
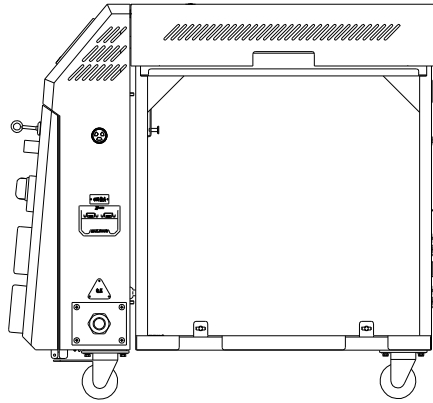

| | | | | | |
|-----|-----------------|---|-------------|------|-----------------------------|
| 48 | YE84003500200 | Buzzer PK-3A 220V | PVC | 1 | |
| 47 | YW90120700000 | Alu. cooler | 6061 | 2 | |
| 46 | YP30048500000 | Alu. plate lable | 2024 | 1 | 485 comm connector |
| 45 | YE90048501200 | RS485 comm. interface plate | | 1 | |
| 44 | YR40048500000 | Shell RS485 | | 1 | |
| 43 | YP31051650000 | Power Alu. plate lable | 2024 | 1 | Power triangle 3-phase 400V |
| 42 | YW69020500000 | Rivet 2x5 | 2024 | 31 | GB/T 827 |
| 41 | YE67002900000 | Cable lock head | PVC | 1 | |
| 40 | SG-S-01 | Wire clamp fixed plate | SPCC2.0 | 1 | |
| 39 | STM-2440PW-A-06 | Right side plate | | 1 | Welding parts |
| 38 | YP30429000000 | Alu. plate lable | 2024 | 1 | Drainage port |
| 37 | YP30431000000 | Alu. plate lable | 2024 | 2 | Water inlet |
| 36 | YP31091040000 | Alu. plate lable | 2024 | 2 | Clean the filter regularly |
| 35 | YP30430000000 | Alu. plate lable | 2024 | 1 | water outlet |
| 34 | YP30422000000 | Alu. plate lable | 2024 | 1 | from mould |
| 33 | YR40523040000 | Plastic slrech buckle | PVC | 1 | 52x30has mould |
| 32 | YP30423000000 | Alu. plate lable | 2024 | 1 | to mould |
| 31 | YW65008000100 | Standard spring washer 8 | 65Mn | 6 | GB/T93 |
| 30 | YW66082200100 | Large washer C grade | Q235A | 4 | GB/T968(8.4x24x2) |
| 29 | YW61082001200 | Inner hex. column head screw M8x20 | 12.9 | 4 | GB/T70.1 |
| 28 | YW69081500000 | Butterfly bolt M8x15 | Q235A | 2 | GB/T 3098 |
| 27 | YW66081600000 | Flat washer A grade (8.4x16x1.6) | Q235A | 2 | GB/T97.1 |
| 26 | YP30425000000 | Alu. plate lable | 2024 | 1 | Pressure gauge |
| 25 | STM-2440PW-A-08 | Cover plate | | 1 | Welding parts |
| 24 | STM-2440PW-A-01 | Rack | | 1 | Welding parts |
| 23 | STM-2440PW-A-07 | Left side plate | | 1 | Welding parts |
| 22 | YP30437000000 | Alu. plate lable | 2024 | 1 | Shin nameplate |
| 21 | YP31115800600 | Alu. plate lable | 2024 | 1 | STM repair & maintenance |
| 20 | YW03000300200 | 3" without brake castor | Q235A | 2 | |
| 19 | YW01051000000 | Pin spring | 65Mn | 6 | for STM new model |
| 18 | STM-2440PW-A-02 | Control box rear plate | | 1 | Welding parts |
| 17 | YW66061800000 | Large washer A grade | Q235A | 16 | GB/T96.1(6x18x1.5) |
| 16 | YW60061500100 | Hex. bolt M6x16 | 12.9 | 16 | GB/T5783 |
| 15 | YW65006000100 | Standard spring washer 6 | 65Mn | 16 | GB/T93 |
| 14 | YW03000300000 | 3" without brake castor | Q235A | 2 | |
| 13 | YW62051000100 | Large cross recessed flat head screw M5x10 | Q235A | 12 | JIS1111 |
| 12 | YW67040600600 | Cross recessed pan head tapping lock screw M4x6 | Q235A | 6 | GB6560 |
| 11 | YW06219100000 | Large hinge | 2024 | 2 | Shengjue CL219-1 |
| 10 | STM-2440PW-A-04 | Control bottom plate | Elec. plate | 1 | |
| 9 | STM-2440PW-A-05 | Door plank | | 1 | Welding parts |
| 8 | YE10021160000 | Main power switch | PVC | 1 | TO-2-1/EA/SVB/16A Mu Le |
| 7 | YW20660900100 | Alu. door plank handle | 2024 | 1 | 6609(Ya Xuan) |
| 6 | YW00040600200 | Long door lock key | SUS201 | 1 | CF-406-DH |
| 5 | YW00000000100 | Long door lock | PVC | 1 | |
| 4 | YW63062000000 | Cross recessed pan head screw M6x20 | Q235A | 4 | GB/T-818 |
| 3 | YW00040600000 | Long door lock fender | SUS201 | 1 | MF-406-DH |
| 2 | YE81850100100 | STM connector | | 1 | |
| 1 | STM-2440PW-A-03 | Control box | | 1 | Welding parts |
| No. | Material number | Name | Mat. | Num. | Remark |

| | | | | | | | | | | |
|----|-----|-----|-----|----|----|----|---|------------------|------|----|
| | | | | | 制图 | 版号 | 标题 | 图号 | 比例 | 数量 |
| | | | | | 设计 | 核准 | 外壳钣金 | STM-2440PW-A-ALL | 1:1 | 1 |
| | | | | | 校对 | | | | 表面要求 | 材质 |
| 标记 | 更改前 | 更改后 | 更改人 | 日期 | 审核 | 日期 | SHINI 信易电热机械股份有限公司 Shini Plastics Technologies, Inc. | | 物料号 | |

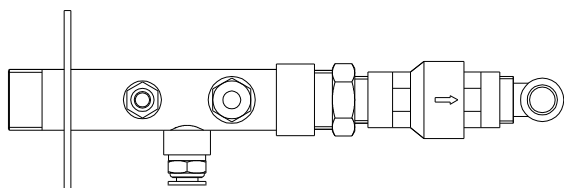
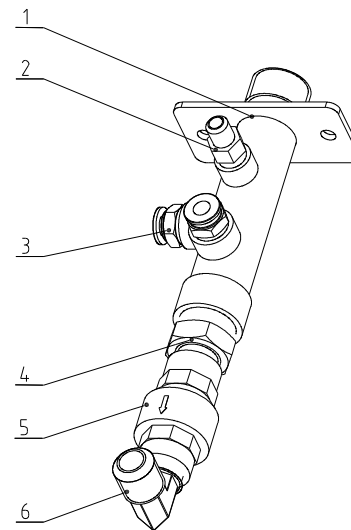
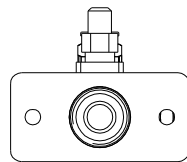
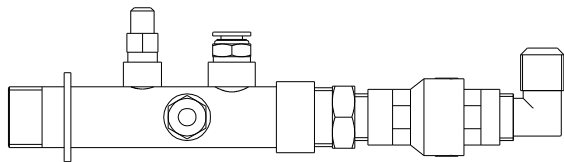

| | | | | | |
|-----|--------------------|--------------------------------|------|------|------------------|
| 6 | YW04121200000 | Tonflon pipe male thread elbow | H62 | 1 | 1/2PT×1/2HL type |
| 5 | YW59001201300 | Single way valve 1/2" VITON | Cu | 1 | RB |
| 4 | S-205 | Copper connector | H58 | 1 | 1/2"PT×3/4"PT |
| 3 | YW80083800100 | Air pipe quick connector | PVC | 2 | APC8-3/8(Arctac) |
| 2 | BH12010400410 | Copper pipe connector | H58 | 1 | 1/4"H×1/4"PT |
| 1 | STM-2440PW-B-03/01 | Pipe refilling connector | | 1 | welding parts |
| No. | Material number | Name | Mat. | Num. | Remarks |

| | | | | | | | | | | | | |
|----|-----|-----|-----|----|----|----|---|------------|----|-----------------|------|-----|
| | | | | | 制图 | 版号 | 标题 | STM-2440PW | 图号 | STM-2440PW-B-03 | 比例 | 数量 |
| | | | | | 设计 | 核准 | 补水接头组件 | | | | | 材质 |
| | | | | | 校对 | | 信易電熱機械股份有限公司 Shini Plastics Technologies, Inc. | | | | 表面要求 | |
| 标记 | 更改前 | 更改后 | 更改人 | 日期 | 审核 | 日期 | | | | | | 物料号 |

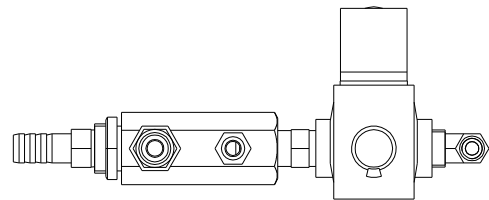
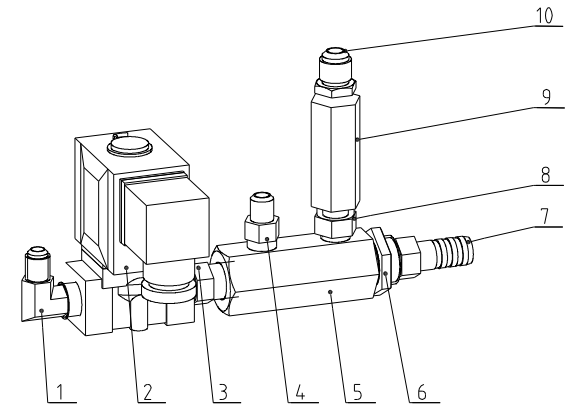
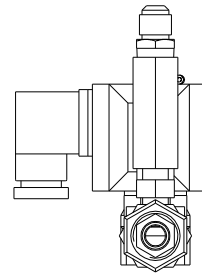
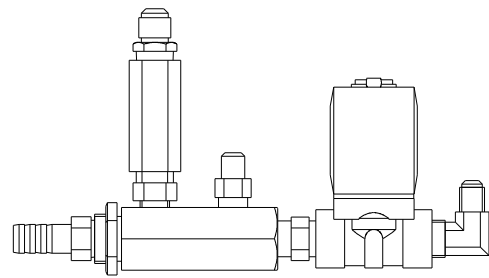

| | | | | | |
|-----|-----------------|---------------------------------|--------|------|---------------------|
| 10 | S-116 | Tonflon pipe male thread elbow | H62 | 1 | 3/8"PT×3/8"H |
| 9 | YW59383400000 | Single way valve 3/8" | SUS304 | 1 | 3/8"(SUS304) |
| 8 | S-50 | Copper connector | H58 | 1 | 3/8"PT×1/4"PT |
| 7 | S-85 | Copper insert | H58 | 1 | 3/8"PT× diameter 13 |
| 6 | S-136 | Common copper nut | H58 | 1 | thread M22×1.5 |
| 5 | S-138 | The 2th set of copper connector | H58 | 1 | |
| 4 | BH12010400410 | Tonflon pipe connector | H58 | 1 | 1/4"H×1/4"PT |
| 3 | S-07 | Copper connector | H58 | 1 | 3/8"PT×3/8"PT |
| 2 | YE300038024.00 | Solenoid valve 2LH050-10E | | 1 | 3/8"24 V AirTAC |
| 1 | YW04030800500 | Copper connector | H58 | 1 | 3/8"PT×1/4"H L |
| No. | Material number | Name | Mat. | Num. | Remarks |

| | | | | | | | | | | | | |
|----|-----|-----|-----|----|----|----|---|------------|----|-----------------|------|-----|
| | | | | | 制图 | 版号 | 标题 | STM-2440PW | 图号 | STM-2440PW-B-04 | 比例 | 数量 |
| | | | | | 设计 | 核准 | 排水接头组件 | | | | | 材质 |
| | | | | | 校对 | | 信易電熱機械股份有限公司 Shini Plastics Technologies, Inc. | | | | 表面要求 | |
| 标记 | 更改前 | 更改后 | 更改人 | 日期 | 审核 | 日期 | | | | | | 物料号 |

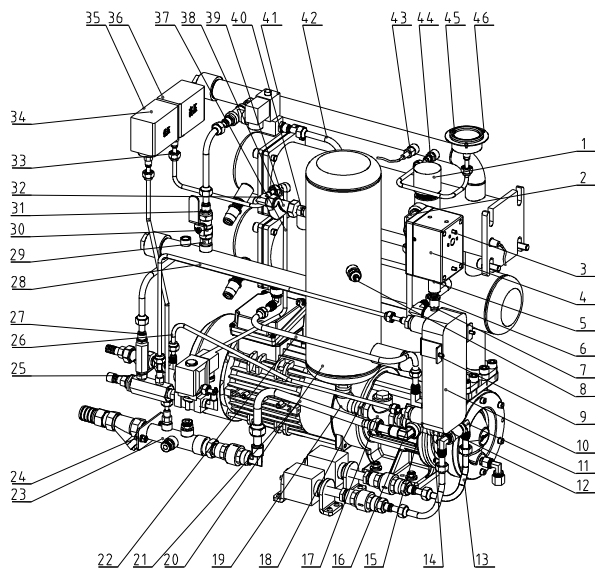
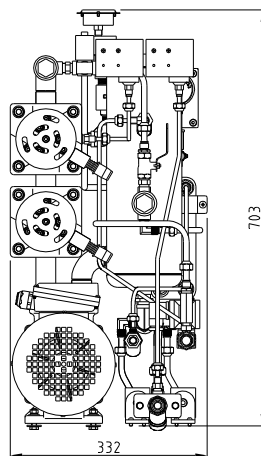
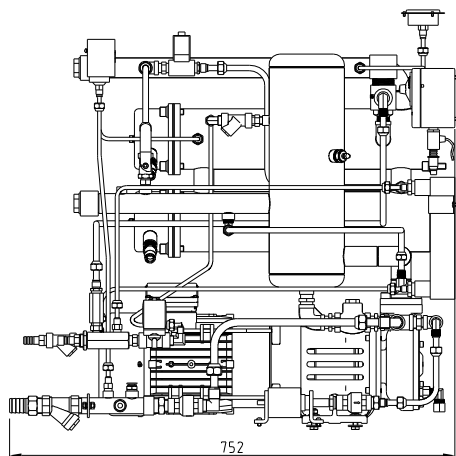

| | | | | | |
|-----|-----------------|--|---------|------|---|
| 46 | YW63030600000 | Cross recessed pan head screw M3x6 | Q235A | 3 | GB/T-823 |
| 45 | YW85015000000 | Pressure gauge | | 1 | 0~15MPa range |
| 44 | S-192 | Low pressure switch controller | H62 | 1 | 1/4"PT×1/4"H |
| 43 | BE90342500050 | Thermocoupler | SUS304 | 1 | 2.5M |
| 42 | STM-2440PW-B-16 | Plate exchange hot air inlet pipe | | 1 | assembly |
| 41 | YE32203000900 | Solenoid valve | | 1 | 3/8" AirTAC 24 VAC |
| 40 | S-50 | Copper connector | H58 | 1 | 3/8"PT×1/4"PT |
| 39 | BH120104.004.10 | Tonflon pipe connector | H58 | 1 | 1/4"H×1/4"PT |
| 38 | YW57030800000 | Y-type water strainer 3/4" | Cu | 1 | |
| 37 | STM-2440PW-B-17 | Exhaust air pipe | | 1 | assembly |
| 36 | YE90002000000 | Pressure switch controller HLP520E | PVC | 1 | 5~20KG auto reply |
| 35 | YE90000800000 | Low pressure switch controller | PVC | 1 | 0~8KG/auto |
| 34 | YW63041200100 | Cross recessed pan head screw M4x12 | Q235A | 4 | GB/T-818 |
| 33 | STM-2440PW-B-11 | High pressure pipe | | 1 | assembly |
| 32 | YW04030800500 | Tonflon connector | H58 | 1 | 3/8"PT×1/4"H L |
| 31 | S-116 | Tonflon pipe male thread connector | H62 | 3 | 3/8"PT×3/8"H |
| 30 | YW50382300500 | Ball valve 3/8" | SUS304 | 1 | One piece withstand pressure 2.3MPaKITZ |
| 29 | S-07 | Copper connector | H58 | 3 | 3/8"PT×3/8"PT |
| 28 | STM-2440PW-B-13 | Cooling water outlet pipe | | 1 | assembly |
| 27 | STM-2440PW-B-08 | Pressure release pipe | | 1 | assembly |
| 26 | STM-2440PW-B-14 | Cooling water inlet pipe | | 1 | assembly |
| 25 | STM-2440PW-B-04 | Exhaust pipe connector assembly | | 1 | assembly |
| 24 | YW60061500100 | Hex bolt M6×16 | 12.9 | 2 | GB/T5783 |
| 23 | STM-2440PW-B-03 | Water refilling connector assembly | | 1 | assembly |
| 22 | STM-2440PW-B-15 | Plate exchange hot air outlet pipe | | 1 | assembly |
| 21 | STM-2440PW-B-09 | Water refilling pipe | | 1 | assembly |
| 20 | STM-2440PW-B-02 | Return water pipe & expansion water tank | | 1 | Welding parts |
| 19 | YW53001200100 | Stainless steel elbow | SUS304 | 2 | 1/2"PT |
| 18 | S-122 | Connector | H58 | 3 | 1/2"PT×1/2"PT |
| 17 | YW59010200300 | Rotary check valve 1/2" | Cu | 1 | KITZ |
| 16 | YW04121200000 | Copper pipe connector | H62 | 1 | 1/2PT×1/2HL type |
| 15 | YW52010200000 | Stainless steel 3-way 1/2 | SUS304 | 1 | |
| 14 | S-92 | Copper connector | H58 | 1 | 3/8"PT×1/2"PT |
| 13 | STM-2440PW-B-12 | Plunger pump refilling pipe | | 2 | assembly |
| 12 | YW52030800000 | 3/8" stainless steel 3-way | SUS304 | 2 | |
| 11 | YW04030800300 | Tonflon connector | H58 | 3 | 3/8"PT×3/8"H L |
| 10 | STM-2440PW-B-19 | Plate exchange parts | | 1 | Welding parts |
| 9 | STM-607PW-B-20 | Plate exchange fixed plate | SPCC2.0 | 1 | |
| 8 | YW09003800500 | Single water level probe | Q235A | 1 | 3" without lead wire resistant pressure 15Mpa |
| 7 | YE6700134.00000 | Hose plug | PVC | 1 | WQEA13.0B |
| 6 | YE66001300000 | Flexible hose | PA66 | 1 | WY-PA6AD13.0B 15M |
| 5 | YE67109000000 | Quick hose connector | PVC | 1 | WQG1-P09B |
| 4 | BH90115000050 | High temp. tester | | 1 | EGO |
| 3 | YW62051000100 | Large cross recessed flat head screw M5×10 | Q235A | 4 | JIS1111 |
| 2 | YW04010200200 | Tonflon pipe connector | H58 | 1 | 1/2"PT×3/8"H L type |
| 1 | YW05141200000 | Safety valve | SUS304 | 1 | 1/2" male thread |
| No. | Material number | Name | Mat. | Num. | Remarks |

| | | | | | | | | | | |
|----|-----|-----|-----|----|----|----|---|------------------|------|----|
| | | | | | 制图 | 版号 | 标题 | 图号 | 比例 | 数量 |
| | | | | | 设计 | 核准 | STM-2440PW | STM-2440PW-B-ALL | 1:1 | 1 |
| | | | | | 校对 | | 内部结构 | | 1:1 | 1 |
| | | | | | 审核 | | | | 表面要求 | |
| 标记 | 更改前 | 更改后 | 更改人 | 日期 | 审核 | 日期 | SHINI 信易电热机械股份有限公司 Shini Plastics Technologies, Inc. | | 物料号 | |

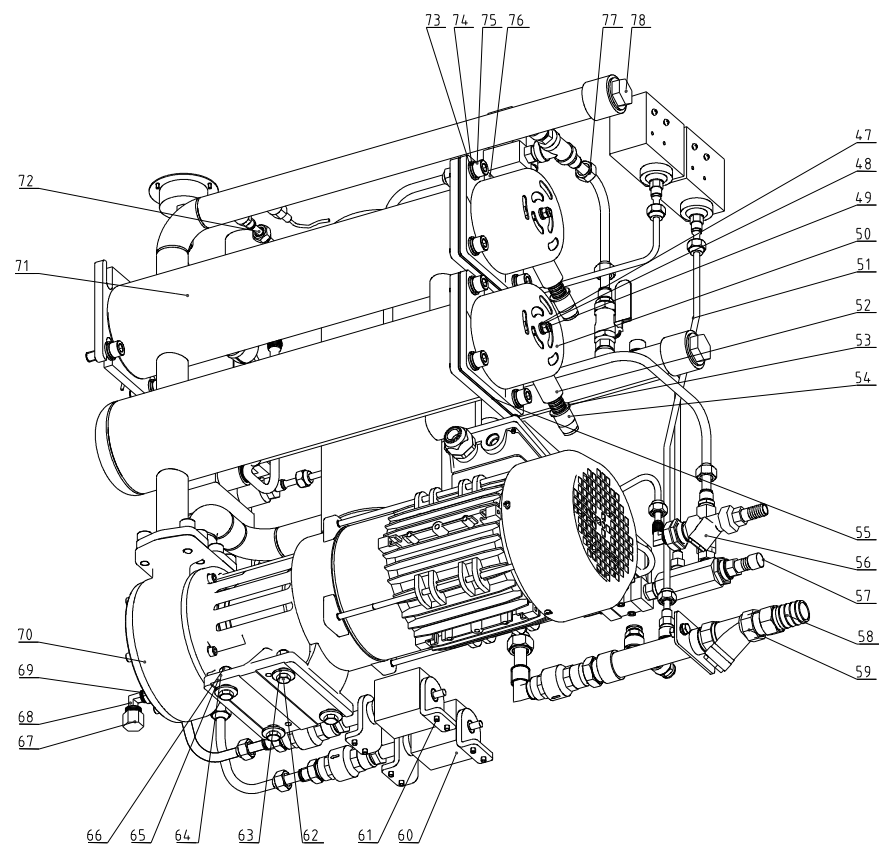

| | | | | | |
|-----|------------------|---------------------------------------|---------|------|-----------------------------|
| 78 | YW5000100100 | Plastic plug 1" PT male thread | PVC | 2 | white |
| 77 | STM-2440PW-B-07 | Hot water bypass pipe | | 1 | assembly |
| 76 | STM-1220PW-F-ALL | Pipe heater welding wiring diagram | | 2 | Welding parts borrow |
| 75 | YW61103000100 | Inner hex column head screw M10x30 | 12.9 | 10 | GB/T70.1 |
| 74 | YW65010000000 | Standard spring washer 10 | 65Mn | 10 | GB/T93 |
| 73 | YW66102000100 | Flat washer A grade 10 | Q235A | 10 | GB/T97.1 (11x20x2) |
| 72 | STM-2440PW-B-06 | Pressure gauge pipe | | 1 | assembly |
| 71 | STM-2440PW-B-01 | Heating tank | | 1 | Welding parts |
| 70 | BM20028000950 | Magnetic driven pump MP-280 | | 1 | 2.8KW 100L/min 80M |
| 69 | STM-907HT-B-17 | Oil discharge long screw | H58 | 1 | borrow |
| 68 | YW040308004.00 | Copper pipe connector | H58 | 1 | 1/4"PTx3/8"H L |
| 67 | S-171 | Tonfon pipe plug | H58 | 1 | 3/8"H plug |
| 66 | YW64080600000 | Hex nut M8 | Q235A | 4 | GB/T6170 |
| 65 | YW66081900000 | Flat washer 8 | Q235A | 4 | 8x19x2.0 |
| 64 | YW65008000100 | Standard spring washer 8 | 65Mn | 4 | GB/T93 |
| 63 | YW66082200100 | Large washer C grade | Q235A | 4 | GB/T96818 4x24x2) |
| 62 | YW60083000200 | Hex bolt M8x30 | 4.8 | 4 | GB/T5783 |
| 61 | YW63051000000 | Cross recessed pan head screw M5x10 | Q235A | 8 | GB/T-818 |
| 60 | STM-607PW-F-ALL | Plunger pump refilling assembly | | 2 | assembly |
| 59 | YW57030400000 | Y-type water strainer 3/4" | Cu | 1 | |
| 58 | S-124 | Copper insert 1/2" PT xφ25 | H62 | 1 | 3/4"PT male thread φ19 hole |
| 57 | YR30010200000 | Copper pipe plug | rubber | 1 | 1/2"PT |
| 56 | STM-607PW-B-21 | Cooling wate inlet connector assembly | | 1 | Welding parts |
| 55 | YR20121200000 | Flexible graphite gasket | ISO-68 | 2 | 120x120x2.0 |
| 54 | YE67015800100 | Hose plug | PVC | 2 | WQEAD15.8B |
| 53 | YE66015800000 | Flexible hose | PA66 | 2 | WY-PA6AD15.8B 1.3M |
| 52 | YE67165800000 | Quick hose connector | PVC | 2 | WQG1-M16B/AD15.8 |
| 51 | STM-2440PW-B-05 | Low pressure pipe | | 1 | assembly |
| 50 | S-190 | Pipe heater cover | SPCC1.0 | 2 | |
| 49 | YW64000600300 | Hex nut M6 | Q235A | 4 | GB/T6170 |
| 48 | YW65006000100 | Standard spring washer 6 | 65Mn | 4 | GB/T93 |
| 47 | YW66061300000 | Flat washer A grade 6 | Q235A | 6 | |
| No. | Material number | Name | Mat | Num. | Remarks |

| | | | | | | | | | |
|----|-----|-----|-----|----|----|------------|---|-----|-----|
| | | | | 制图 | 版号 | 标题 | 图号 | 比例 | 数量 |
| | | | | 设计 | 核准 | STM-2440PW | STM-2440PW-B-ALL | 1:1 | 1 |
| | | | | 校对 | | 内部结构 | | | 材质 |
| | | | | 审核 | | | 表面要求 | | 物料号 |
| 标记 | 更改前 | 更改后 | 更改人 | 日期 | 日期 | | SHINI 信易电热机械股份有限公司 Shini Plastics Technologies, Inc. | | |