



1. 熱嘴局部圖

Cut out for the nozzle

公差標準: DIN ISO 2768-MK

General tolerances DIN ISO 2768-MK

表面粗糙度 $\nabla\nabla\nabla 0.02$

Surfaces: $\nabla\nabla\nabla 0.02$

模板加工尺寸如右圖所示

Template processing dimensions as shown on the right

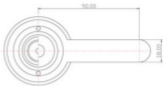

2. 連接線

Connecting

電源230V

Power 230V

感溫線

Thermocouple

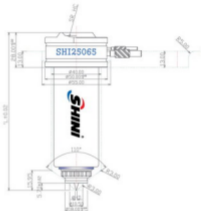

3. 技術規範

Questionnaire

相同的本體類型, 有不同的嘴尖

The same nozzle bodies, have different nozzle sharp

嘴尖的尺寸如圖所示

The dimensions of the cut for nozzle sharp used can be found in the nozzle data sheet

4. 尺寸的選擇

Size selection

L 熱嘴長度

L Nozzle length

HD 噴口的直徑

HD Gate diameter

HC 球頭半徑

HC Ball head radius

5. 編碼原則 Code principle



熱嘴長度與功率的選擇

NOZZLE LENGTH AND POWER SELECTION

MODEL NOZZLE(L)	HEATER NOZZLE(WATT)	T/C (J/K)
SHI25065	SHCH25035200	SHT15100J/K
SHI25085	SHCH25055350	SHT15100J/K
SHI25105	SHCH25075450	SHT15100J/K
SHI25125	SHCH25095600	SHT15150J/K
SHI25145	SHCH25115700	SHT15150J/K
SHI25165	SHCH25135850	SHT15150J/K



1. 熱嘴局部圖

Cut out for the nozzle

公差標準: DIN ISO 2768-MK

General tolerances DIN ISO 2768-MK

表面粗糙度 $\nabla\nabla\nabla 0.02$

Surfaces: $\nabla\nabla\nabla 0.02$

模板加工尺寸如右圖所示

Template processing dimensions as shown on the right

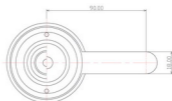

2. 連接線

Connecting

電源230V

Power 230V

感溫線

Thermocouple

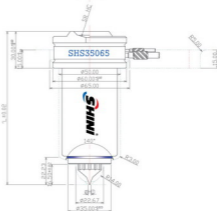

3. 技術規範

Questionnaire

相同的本體類型，有不同的嘴尖

The same nozzle bodies, have different nozzle sharp

嘴尖的尺寸如圖所示

The dimensions of the cut out for the nozzle sharp use can be found in the nozzle data sheet

4. 尺寸的選擇

Size selection

L 熱嘴長度

L Nozzle length

HD 澆口的直徑

HD Gate diameter

HC 球頭半徑

HC Ball head radius

5. 編碼原則 Code principle



熱嘴長度與功率的選擇

NOZZLE LENGTH AND POWER SELECTION

MODEL NOZZLE(L)	HEATER NOZZLE(WATT)	T/C (J/K)
SHS35065	SHCH35027300	SHT15100J/K
SHS35085	SHCH35047450	SHT15100J/K
SHS35105	SHCH35067700	SHT15100J/K
SHS35125	SHCH35087850	SHT15150J/K
SHS35145	SHCH35107950	SHT15150J/K
SHS35165	SHCH35127950	SHT15150J/K