

Robot Selection Guide

■ Swing-arm Robot

Suitable for picking up sprue. Simple product pick-up can be achieved with optional vacuum device.

Model: S S - □□□ - □ - □ - □□□□ - □
① ② ③ ④ ⑤

Selection Process

① Y-axis displacement:

Y-axis displacement can be calculated through the equation below with unit of mm. Select a model that satisfy the required displacement. Please refer to robot selection form for meanings of parameters.

$$Y_{req} = B + C + \text{thickness of the product}$$

② Design and appearance:

Two types of design are available. Empty: European; S: Standard.

③ Options:

M: Middle mold detector; V: Vacuum circuit; MV: Both.

④ Robot-IMM interface:

Empty: Standard; EM12: Euromap 12; EM67: Euromap 67.

⑤ Products to be placed at IMM (___ side)

N: Non-operation side. Empty: Operation side

■ Traverse Robot

Suitable for pick-up function as well as inserting, stacking and other purpose.

Model: S T - - - - - - - -

⑨③
①
②
⑥
⑦
③
⑤
②
④
⑧
⑩

Selection Process

① Y-axis displacement:

Y-axis displacement can be calculated through the equation below with unit of mm. Select a model that satisfy the required displacement. Please refer to robot selection form for meanings of parameters.

$$Y_{req} = B + C + \text{thickness of the product}$$

② Single or double arms:

Empty: Single arm, suitable for 2-plate-mold or hot runner mold; D: Double arms suitable for 3-plate-mold.

③ Number of servo axis and cycle time:

1: Single axis, for CT > 8 sec; 3: Three axes, for CT > 6 sec; 5: Five axes, double arm, for CT > 6 sec; H at the end: ST3 high speed, CT > 4 sec.

④ Telescopic arm:

Selection based on the height of ceiling. Large and medium robots only have telescopic arm. Empty: Normal arm; T: Telescopic arm, reduce overall height.

⑤ Model and payload:

M: Medium, for payload < 20kg; L: Large, for payload < 30kg; Empty: Small models.

⑥ Design and control:

Empty: Europeanised; S: Standard.

⑦ Options:

M: Middle mold detector.

⑧ Robot-IMM interface:

Empty: Standard; EM12: Euromap 12; EM67: Euromap 67.

⑨ Longitudinal robot:

Traverse robot can be modified to Longitudinal by replace T to L.

⑩ Products to be placed at IMM (___ side)

N: Non-operation side. Empty: Operation side

Transitional Plate of Robots Mounting

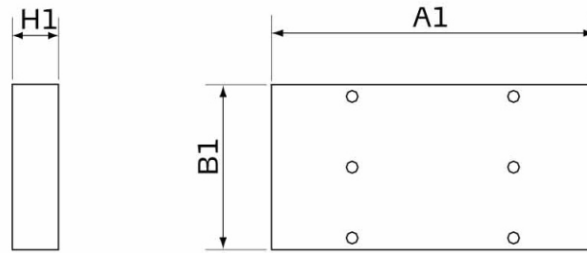

Picture 1

No.	Material Code	Code Name	H1 (mm)	A1 (mm)	B1 (mm)	Name	Type of Robots
1	BH10055001010	AUTO-SS-01	30	350	150	Transitional Base 01	Swing-arm
2	BH70586900010	AUTO-SS-02	30	400	220	Transitional Base 02	Swing-arm

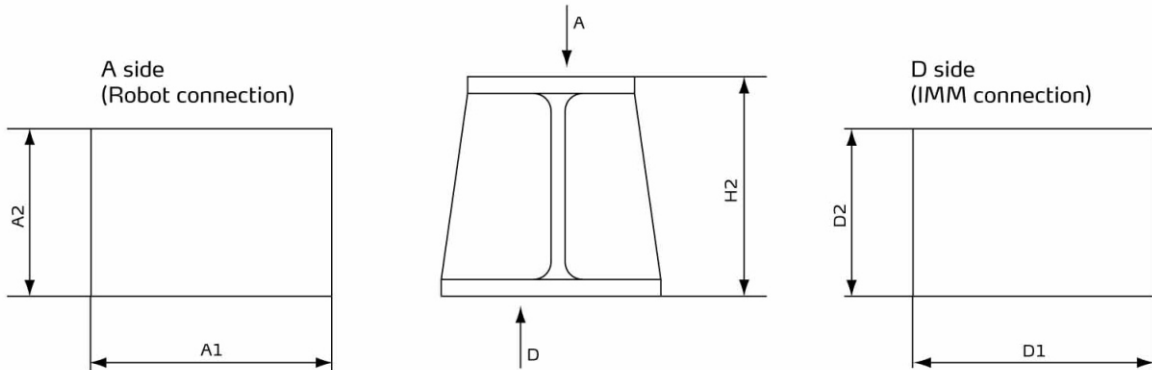

Picture 2

No.	Material Code	Code Name	H2	Robot Connection		IMM Connection		Name	Type of Robots
				A1(mm)	A2(mm)	D1(mm)	D2(mm)		
4	BW30041800010	AUTO-H180-400255-01	180	400	320	400	255	Transitional Base 04	Traverse
5	BW30052200010	AUTO-H220-750265-01	220	400	295	750	265	Transitional Base 05	
6	BW30006220010	AUTO-H220-550280-01	220	400	280	550	280	Transitional Base 06	
7	BW30072500010	AUTO-H250-750280-01	250	400	250	750	280	Transitional Base 07	
8	BW30083550010	AUTO-H300-550300-01	300	400	250	550	300	Transitional Base 08	
9	BW30093750010	AUTO-H300-750320-01	300	400	250	750	320	Transitional Base 09	
10	BW30121600010	AUTO-HT120-160-H110	110	400	260	450	185	Transitional Base 10	
11	BW30901200010	AUTO-HT90-120-H160	160	400	260	450	200	Transitional Base 11	
12	BW30602500210	AUTO-HT60-250-H200	200	400	260	450	200	Transitional Base 12	
13	BW30045000210	AUTO-H300-800500-01	300	550	200	800	270	Transitional Base 13	
14	BW30045000110	AUTO-H450-1250810-01	450	810	300	1250	380	Transitional Base 14	



Robot Selection Form

Dear Customers:

To ensure optical use of our equipment, please fill in the form carefully before purchasing our robot. So that we can choose the most suitable product for you. Thank you!

Customer Info.	Company Name		Final Selection	
	Contact	Mobile Phone		

IMM Info.	IMM Manufacturer		Clamping Force	
	IMM Model		IMM Signal	<input type="checkbox"/> Standard <input type="checkbox"/> EM12 <input type="checkbox"/> EM67
	Direction of Placing	<input type="checkbox"/> Operation Side <input type="checkbox"/> Non-operation Side		

Mold Info.	Mold Type	<input type="checkbox"/> 2-plate <input type="checkbox"/> 3-plate <input type="checkbox"/> Hot Runner		
	Mold Displacement		Cavities Number	
	Min. Cycle Time		Suction Surface Dimension	
	Ejection Position	<input type="checkbox"/> Movable Plate <input type="checkbox"/> Fixed Plate		

Installation Dimension

Type Code	Dimensions
A	
B	
C	
D	
E	
F	
G	
G1	
H	
H1	
I	
J	
K	
L	
M	
N	
O	
P	
Q (Distance between two machines)	
Product Thickness	

Recorder:
Remarks:

Shini Group

Addr: No. 23, Minhe St., Shulin Dist.,
New Taipei, Taiwan

Tel: +886 2 2680 9119

Fax: +886 2 2680 9229

Email: shini@shini.com

Factories:

- Taiwan
- Dongguan
- Pinghu
- Ningbo
- Chongqing
- Pune

2016-04-15-04 Copyrights Reserved.

www.shini.com