



"Standard" Hopper Dryer

SHD-50E



Refer carefully to the manual before operation.

SHD-E Series

■ Coding Principle

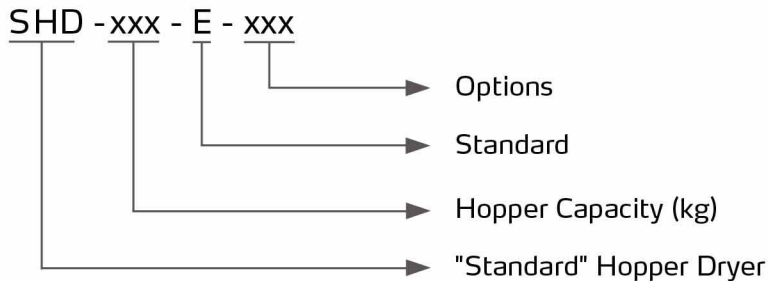

■ Features

- Adopt hot air diffuser to keep plastics dry and temperature stable, thus improve drying efficiency.
- All material contact surfaces are made of stainless steel to eliminate material contamination.
- All models are equipped with external power switch.
- For SHD-25~150, heater pipes are connected by lead sheets and other models are equipped with temperature protector to prevent heater pipe from damaging by blower fault.
- Overheat tripping can automatically cut off power when drying temperature exceeds set deviation value.
- Adopt heat-insulated blower to prolong blower lifespan.
- All models standard equipped with 7-day timer and intermittent operation function.
- All models adopt microcomputer control and RS485 communication port.
- Max. drying temperature is 160°C.
- The series of blowers are equipped with overheat protector.



Hopper Inside

■ Working Principle

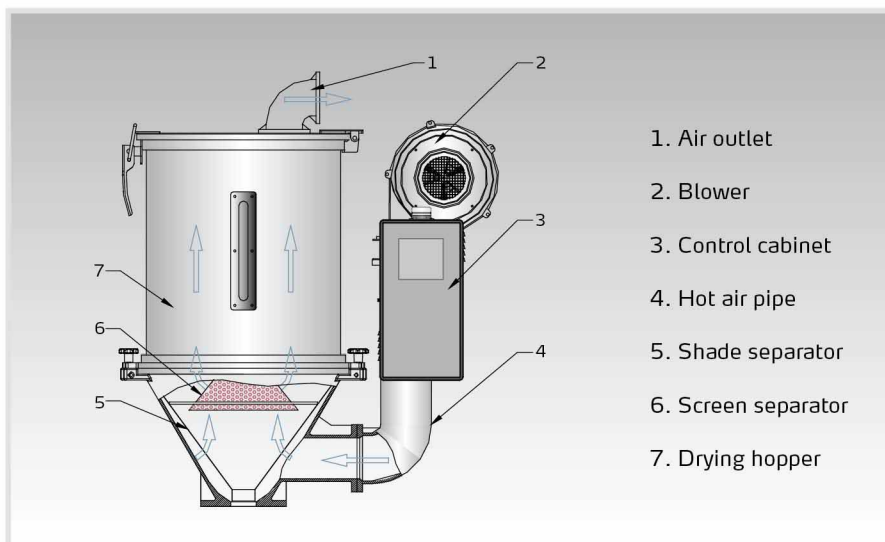

Application

SHD hopper dryers are used for drying hygroscopic plastics, such as PS, PP, and ABS etc., which can reach the highest drying temperature up to 160°C. In addition, multiple accessories are optional to realize different functions, such as recycling hot air and filtering metal impurities in the materials. With the floor stand, it makes floor mount of the machine available.

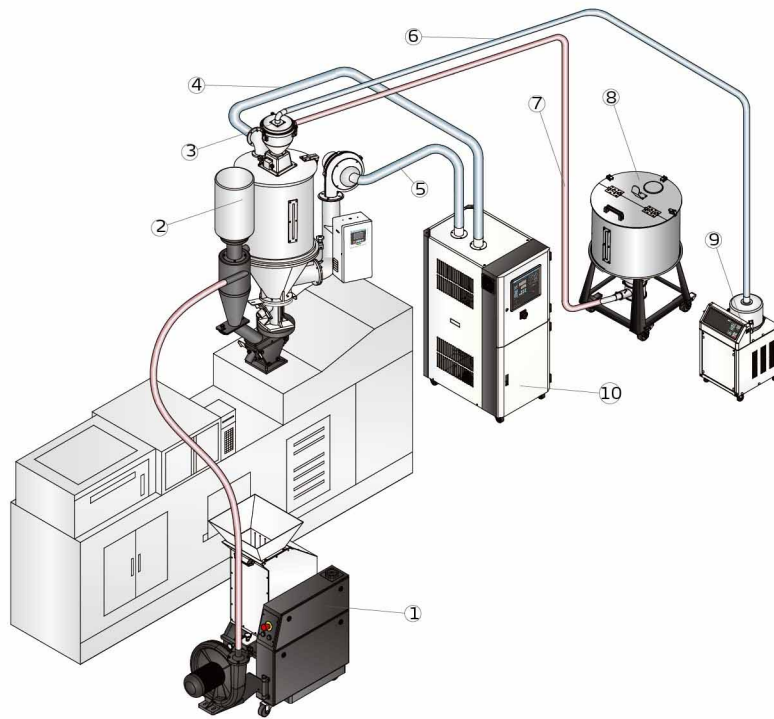

SHD-E Direct Mounting

- 1.Low-speed granulator
- 2.30-sec instant recycle
- 3.Vacuum hopper receiver
- 4.Return air
- 5.Dehumidifying air
- 6.Vacuum pipe
- 7.Material pipe
- 8.Material storage tank
- 9.Auto loader
- 10.Honeycomb dehumidifier
- 11.Proportional valve
- 12.Photosensor hopper receiver

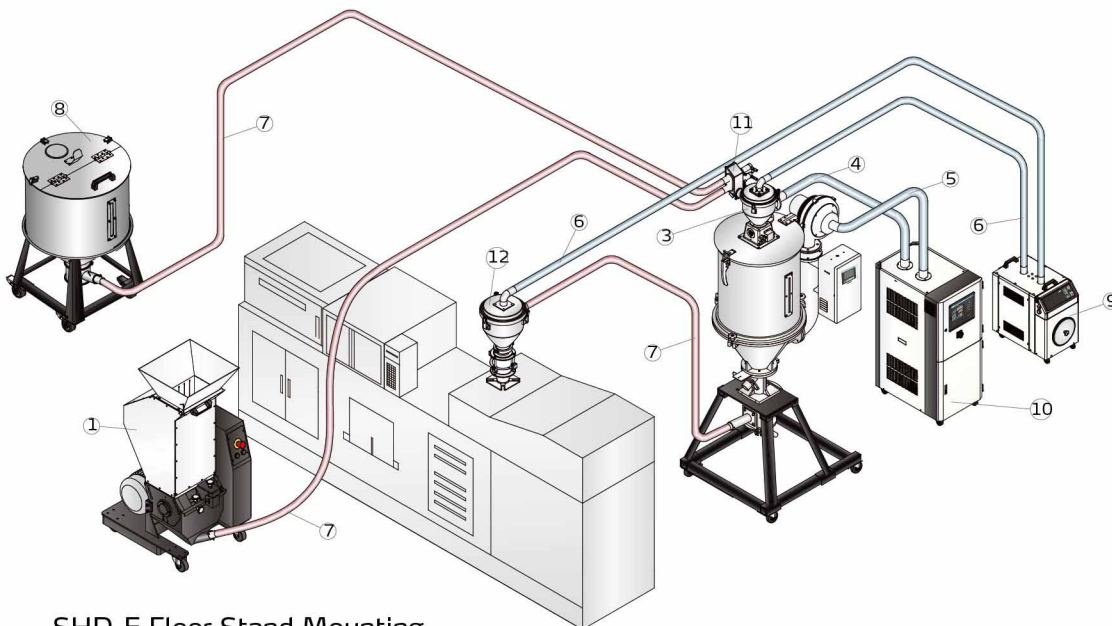

SHD-E Floor Stand Mounting

SHD-E Series

■ Accessory

Magnetic Base

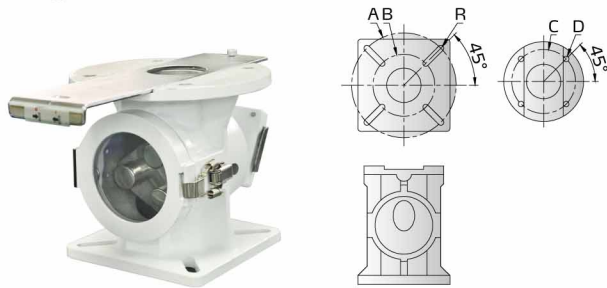

| Model | Applied to | mount size | | | | |
|----------|---------------|------------|------|------|----------|---|
| | | A | B | C | D | R |
| MB-12EB | SHD-12E | - | - | Ø104 | 4×Ø9EQS | - |
| MB-50 | SHD-25E-75E | - | - | Ø140 | 4×Ø9EQS | - |
| MB-100EB | SHD-100E/150E | Ø213 | Ø126 | Ø190 | 4×Ø12EQS | 6 |
| MB-200EB | SHD-200E/300E | - | - | Ø255 | 4×Ø14EQS | - |
| MB-400EB | SHD-400E/500E | - | - | Ø255 | 4×Ø16EQS | - |
| MB-600EB | SHD-600E | - | - | Ø255 | 4×Ø16EQS | - |

Air exhaust Filter

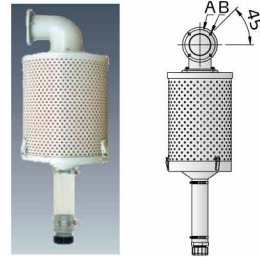

It can effectively filter the dust air discharged from the dryer to avoid air contamination, and the efficiency reaches 99%.

| Model | Applied to | mount size | |
|---------|---------------|------------|-----------|
| | | A | B |
| ADC-1 | SHD-12E | Ø65 | 4×Ø7EQS |
| ADC-2 | SHD-25E-150E | Ø95 | 4×Ø6.5EQS |
| ADC-3EB | SHD-200E-500E | Ø120 | 4×Ø6EQS |
| ADC-3 | SHD-600E | Ø160 | 4×Ø6.5EQS |

Hot Air Recycler

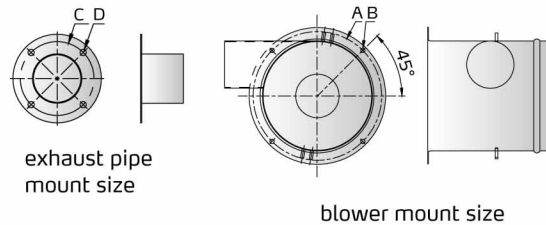

Work with hopper dryer to make the hot air form a semi-closed circulated loop and has features as follows:

- 1) Hot air recycling and circulating avoids indoor temperature rising up.
- 2) Keep air in factory clean and ensure good product quality.
- 3) The energy consumption can be reduced by fast heating speed of the hot air circulation, which saves 40% of the energy.

| Model | Filtering Barrel Dia. (mm) | Inlet Air Pipe Dia. (inch) | Flange of Air Outlet (inch) | Applied to | mount size | | | |
|-----------|----------------------------|----------------------------|-----------------------------|---------------|------------|---------|------|-----------|
| | | | | | A | B | C | D |
| HAR-12 | 157 | | 2 | SHD-12E | Ø165 | 4×Ø7EQS | Ø65 | 4×Ø7EQS |
| HAR-25EB | 157 | | 2.5 | SHD-25E | Ø207 | 4×Ø6EQS | Ø95 | 4×Ø7.5EQS |
| HAR-50 | 177 | | 3 | SHD-50E/75E | Ø207 | 4×Ø7EQS | Ø95 | 4×Ø7.5EQS |
| HAR-100EB | 219 | | 3 | SHD-100E/150E | Ø207 | 4×Ø7EQS | Ø95 | 4×Ø7.5EQS |
| HAR-200EB | 249 | | 4 | SHD-200E/300E | Ø255 | 6×Ø6EQS | Ø120 | 4×Ø8EQS |
| HAR-400EB | 221 | | 4 | SHD-400E/500E | Ø255 | 6×Ø7EQS | Ø120 | 4×Ø8EQS |
| HAR-600EB | 221 | | 4 | SHD-600E | Ø292 | 6×Ø7EQS | Ø160 | 4×Ø8EQS |

Blower Inlet Filter

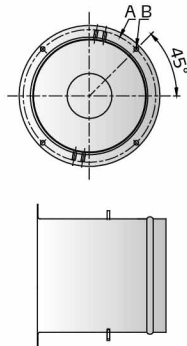

| Model | Filtering Barrel Dia. (mm) | Overall height (mm) | Applied to | mount size | |
|-----------|----------------------------|---------------------|---------------|------------|---------|
| | | | | A | B |
| AIF-12 | 157/6.2" | 195/7.7" | SHD-12E | Ø165 | 4×Ø7EQS |
| AIF-25EB | 157/6.2" | 195/7.7" | SHD-25E | Ø207 | 4×Ø6EQS |
| AIF-50 | 177/7.0" | 201/7.9" | SHD-50E/75E | Ø207 | 4×Ø7EQS |
| AIF-100EB | 219/8.6" | 191/7.5" | SHD-100E/150E | Ø207 | 4×Ø7EQS |
| AIF-200EB | 249/9.8" | 268/10.6" | SHD-200E/300E | Ø255 | 6×Ø6EQS |
| AIF-400EB | 221/9.0" | 380/15.0" | SHD-400E/500E | Ø255 | 6×Ø7EQS |
| AIF-600EB | 221/9.0" | 380/15.0" | SHD-600E | Ø292 | 6×Ø7EQS |

Notes: refill air input of the blower is adjustable.

Hopper Magnet



| Model | Applied to | Aluminum Holder×2(mm) |
|-------|-----------------------------------|-----------------------|
| MR-5 | SHD-12E | (148×80×2.3) |
| MR-7 | SHD-25E\50E\75E | (190×80×2.3) |
| MR-9 | SHD-100E\150E\200E\300E\400E\500E | (240×80×2.3) |
| MR-11 | SHD-600E | (290×80×2.3) |

Material Suction Box/Shut-off Suction Box



| Model | Applied to | SHD-12E-75E | SHD-100E-400E |
|-------|------------|-------------|---------------|
| SBU | | -20-38S | -160-38S |
| SBU | | -20-50S | -160-50S |
| SBU | | -20-38S | -160-38D |
| SBU | | -20-50S | -160-50D |

- Notes: 1) Install pneumatic shut off valve (add "V" at the end of the model code).
 2) Change into stainless steel material (add "S" at the end of the model code).
 3) Stainless steel polishing (add "P" at the end of the model code).
 4) "S" stands for single tube suction box and "D" stands for double tubes suction box.
 5) It needs to work with the floor stand.

SHD-E Series

N-Type Floor Stand

With which machines can be easily moved out of workplace which is suitable for the factories with height limited workshops and also it can make operations more convenient. The N-type floor stand can replace any machine that is applicable to the SHD-E series.

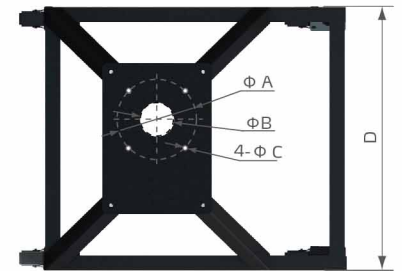

| Model | Applied to | Dimension H×W×D(mm/inch) | A / B / C (mm/inch) |
|---------|---------------|--------------------------------|------------------------------------|
| FSN-50 | SHD-12E-75E | 600×700×640 / 23.6×27.6×25 | 140 / 54 / 9 5.5 / 2.1 / 0.4 |
| FSN-100 | SHD-100E/150E | 615×800×710 / 24.2×31.5×28 | 210 / 90 / 11 8.3 / 3.5 / 0.43 |
| FSN-200 | SHD-200E/300E | 680×1000×840 / 26.8×39.4×33 | 210 / 90 / 11 8.3 / 3.5 / 0.43 |
| FSN-400 | SHD-400E-600E | 700×1200×1010 / 27.6×47.2×39.8 | 260 / 116 / 13 10.2 / 4.6 / 0.5 |

Outline Drawings

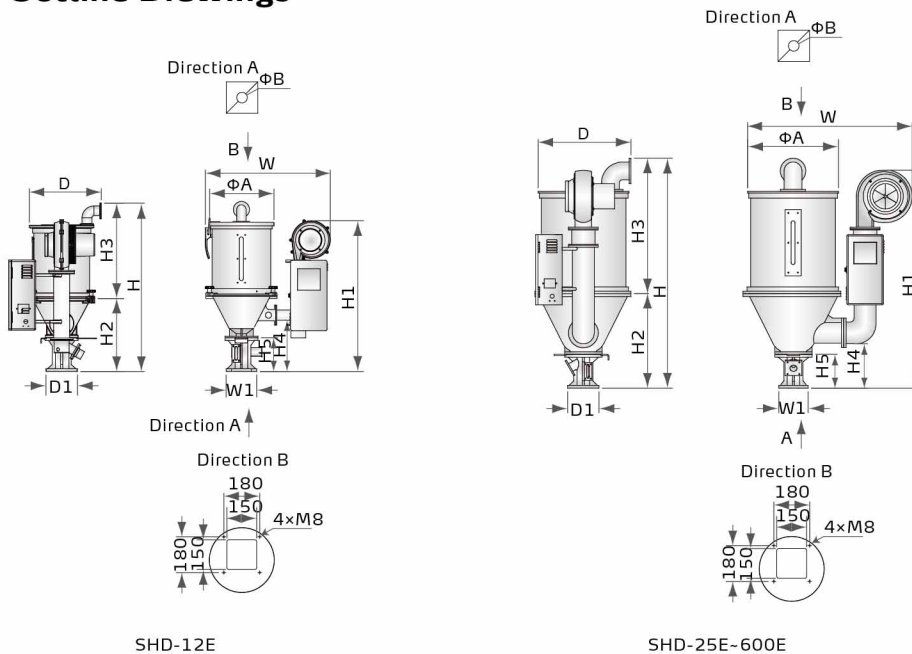



■ Specifications

| Model SHD- | 12E | 25E | 50E | 75E | 100E | 150E | 200E | 300E | 400E | 500E | 600E | |
|----------------------|--------|--------|----------|----------|--------|----------|--------|------|------|------|------|------|
| Drying heater (kW) | 2.2/3* | 3/3.3* | 3.9/4.2* | 4.2/4.8* | 6/6.6* | 6.6/7.2* | 12/15* | 15 | 18 | 19.5 | 21 | |
| Blower (kW) | 50Hz | 0.1 | 0.17 | 0.17 | 0.17 | 0.2 | 0.2 | 0.35 | 0.35 | 0.45 | 0.45 | 1.03 |
| | 60Hz | 0.125 | 0.205 | 0.205 | 0.205 | 0.24 | 0.24 | 0.42 | 0.42 | 0.52 | 0.52 | 1.23 |
| Loading Capacity(kg) | 12 | 25 | 50 | 75 | 100 | 150 | 200 | 300 | 400 | 500 | 600 | |
| H (mm) | 801 | 989 | 1112 | 1247 | 1316 | 1636 | 1852 | 2272 | 1933 | 2383 | 2174 | |
| H1 (mm) | 676 | 878 | 924 | 937 | 1151 | 1151 | 1573 | 1573 | 1609 | 1609 | 2054 | |
| H2 (mm) | 321 | 396 | 452 | 463 | 536 | 536 | 634 | 634 | 713 | 713 | 821 | |
| H3 (mm) | 480 | 593 | 660 | 784 | 780 | 1101 | 1218 | 1638 | 1220 | 1670 | 1354 | |
| H4 (mm) | 165 | 196 | 204 | 213 | 255 | 255 | 287 | 287 | 287 | 287 | 344 | |
| H5 (mm) | 107 | 150 | 150 | 150 | 173 | 173 | 194 | 194 | 205 | 205 | 245 | |
| W (mm) | 646 | 694 | 774 | 848 | 958 | 958 | 1183 | 1183 | 1339 | 1339 | 1510 | |
| D (mm) | 342 | 413 | 508 | 555 | 627 | 627 | 753 | 753 | 893 | 893 | 1033 | |
| D1 (mm) | 108 | 158 | 158 | 158 | 177 | 177 | 230 | 230 | 280 | 280 | 280 | |
| W1 (mm) | 108 | 148 | 148 | 148 | 177 | 177 | 230 | 230 | 280 | 280 | 280 | |
| ΦA (mm) | 327 | 383 | 478 | 535 | 602 | 602 | 745 | 745 | 897 | 897 | 1050 | |
| ΦB (mm) | 42 | 53 | 53 | 53 | 81 | 81 | 110 | 110 | 116 | 116 | 130 | |
| Weight(kg) | 23 | 25 | 37 | 39 | 55 | 56 | 113 | 116 | 132 | 134 | 205 | |

- Notes 1) Above loading capacity is based on particles of 0.65kg/L(5.5lb/gal) bulk density in diameter of 3-5mm (0.1-0.2 inch).
 2) "*"High-temp. model option up to max. 180°C.
 3)Power: 3 Φ , 400VAC, 50HZ.

We reserve the right to change specifications without prior notice.

Shini Group

Addr: No. 23, Minhe St., Shulin Dist.,
New Taipei, Taiwan

Tel: +886 2 2680 9119

Fax: +886 2 2680 9229

Email: shini@shini.com

Factories:

- Taiwan
- Dongguan
- Pinghu
- Ningbo
- Chongqing
- Pune

2021-09-30-04 Copyrights Reserved.

www.shini.com