



1. 熱嘴局部圖

Cut out for the nozzle

公差標準: DIN ISO 2768-MK

General tolerances: DIN ISO 2768-MK

表面粗糙度 $\sqrt{\sqrt{0.02}}$

Surfaces: $\sqrt{\sqrt{0.02}}$

模板加工尺寸如右圖所示

Template processing dimensions as shown on the right

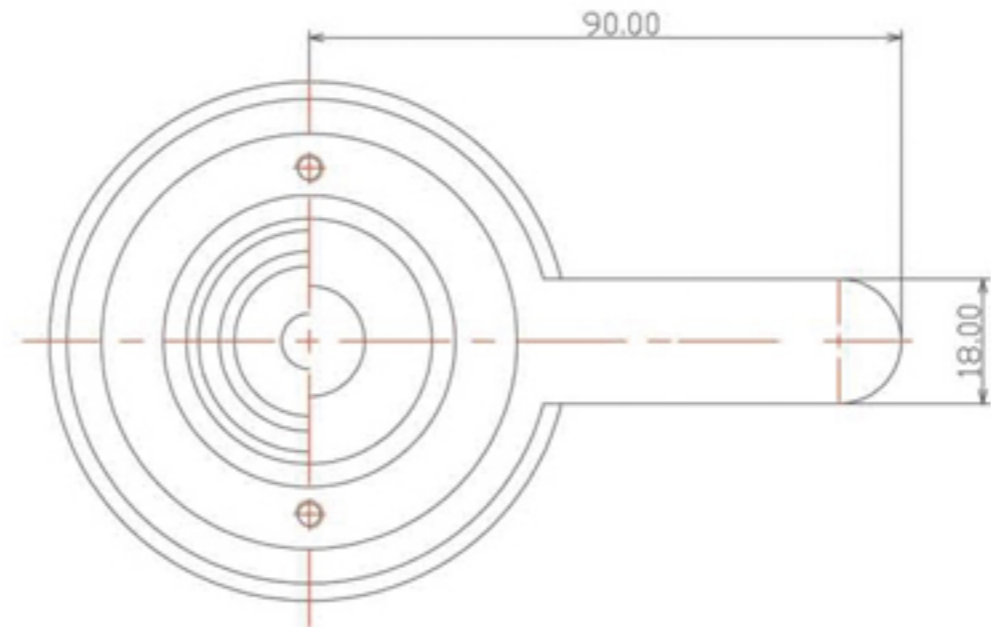

2. 連接線/控制器

Connecting/Controller

電源230V

Power 230V

感溫線

Thermocouple

溫控箱

Temp-controller

3. 技術規範

Questionnaire

不同的產品要求, 有不同的嘴尖

Different part requirements, have different nozzle sharp

嘴尖的尺寸如圖所示

Nozzle sharp dimensions as shown on the right

4. 尺寸的選擇

Size selection

L 熱嘴長度

L Nozzle length

HD 澆口的直徑範圍: $\varnothing 1.0 \sim \varnothing 3.0$

HD Gate diameter range: $\varnothing 1.0 \sim \varnothing 3.0$

HC 球頭半徑

HC Ball head radius: R10, R15, R19, R21

5. 編碼原則 Code principle

S H S 45 075

— 嘴身長度 Nozzle length

— 嘴身大小 Nozzle size

— 表示尖嘴 Nozzle sharp

— 熱流道 Hot Runner

— 信易 SHINI

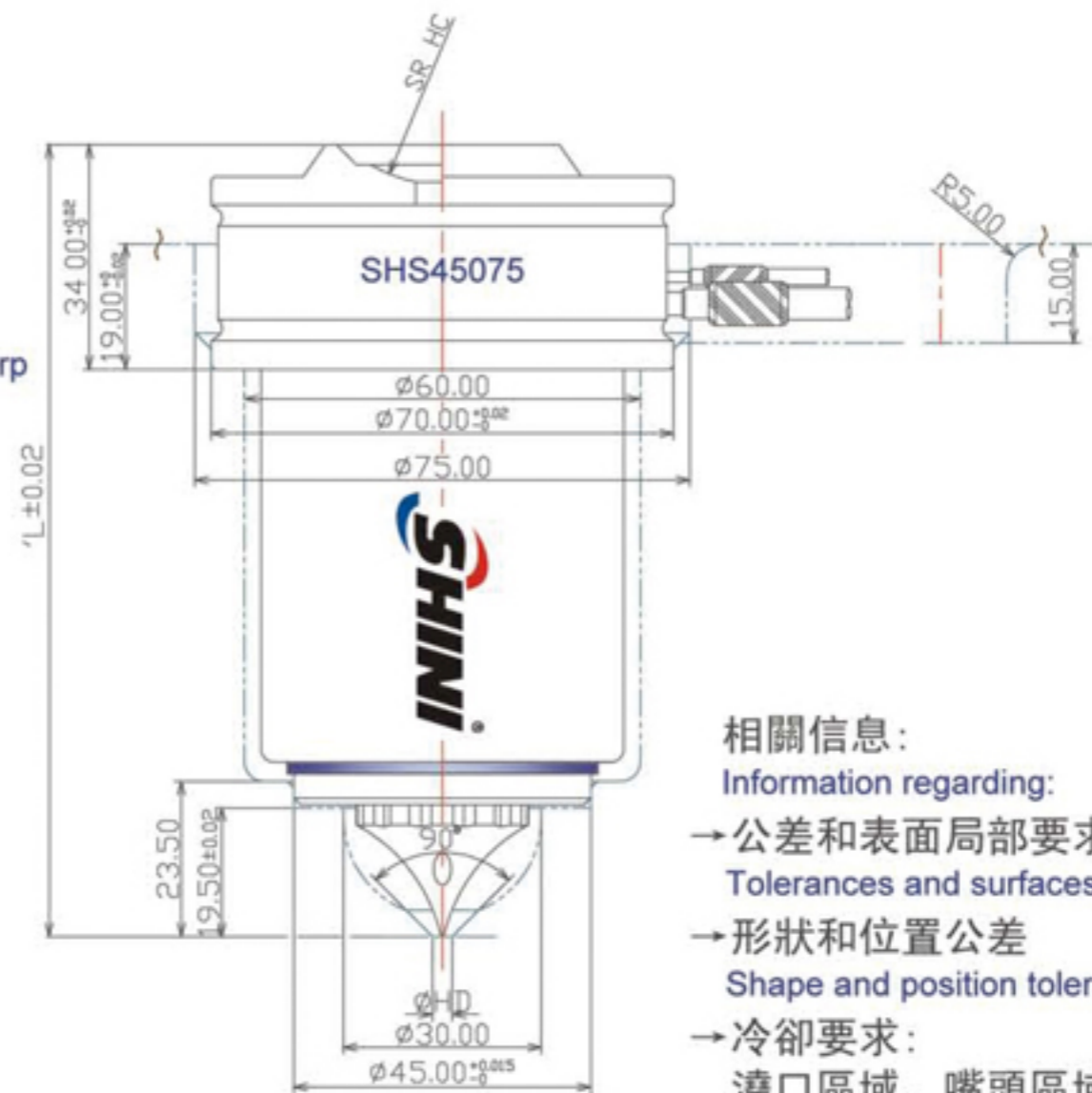

相關信息:

Information regarding:

→ 公差和表面局部要求
Tolerances and surfaces

→ 形狀和位置公差
Shape and position tolerance

→ 冷卻要求:
澆口區域、嘴頭區域
Cooling required: Gate bush and nozzle sharp

→ 封膠處的要求
The front of nozzle sharp must be against plastic

6. 熱嘴尺寸與功率的選擇 Nozzle size and power selection

熱嘴尺寸 Nozzle size(L)	熱嘴膨脹量(單位:mm) Nozzle expansion(Unit:mm)			加熱器功率 Heater(Watt)	感溫線型號 T/C(J/K)
	200℃	250℃	300℃		
SHS45075	0.070	0.088	0.105	SHCH45050450	SHT15100J/K
SHS45095	0.118	0.148	0.177	SHCH45070700	SHT15100J/K
SHS45115	0.166	0.208	0.249	SHCH45090850	SHT15100J/K
SHS45135	0.214	0.268	0.321	SHCH45110950	SHT15100J/K
SHS45155	0.262	0.328	0.393	SHCH45130950	SHT15100J/K
SHS45175	0.310	0.388	0.465	SHCH45130950	SHT15100J/K

All rights reserved.Errors excepted.For a specific application,please consult SHINI.

For design and application information, see the SHINI Hot Runner Guide.



1. 熱嘴局部圖

Cut out for the nozzle

公差標準: DIN ISO 2768-MK

General tolerances: DIN ISO 2768-MK

表面粗糙度 $\nabla\nabla\nabla 0.02$

Surfaces: $\nabla\nabla\nabla 0.02$

模板加工尺寸如右圖所示

Template processing dimensions as shown on the right

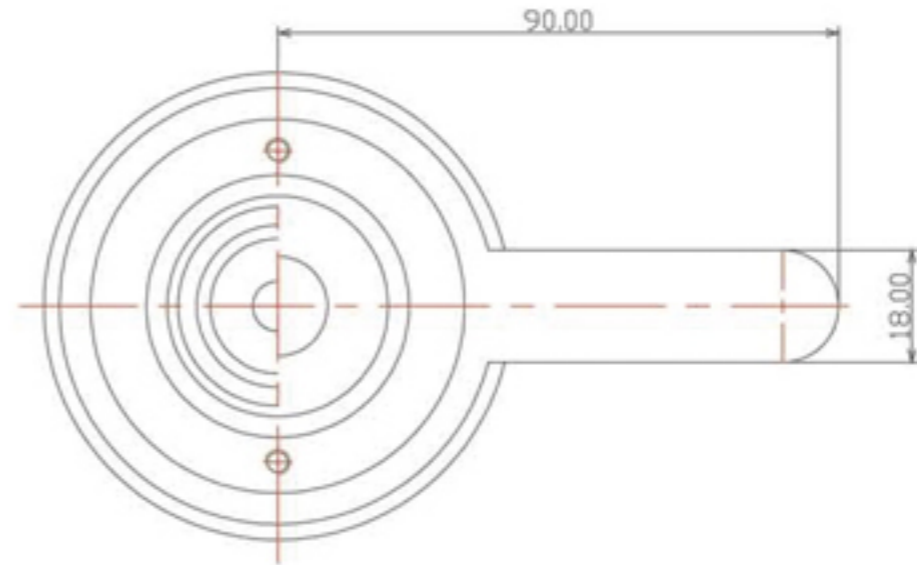

2. 連接線/控制器

Connecting/Controller

電源230V

Power 230V

感溫線

Thermocouple

溫控箱

Temp-controller

3. 技術規範

Questionnaire

不同的產品要求, 有不同的嘴尖

Different part requirements, have different nozzle sharp

嘴尖的尺寸如圖所示

Nozzle sharp dimensions as shown on the right

4. 尺寸的選擇

Size selection

L 熱嘴長度

L Nozzle length

HD 澆口的直徑範圍: $\varnothing 1.5 \sim \varnothing 4.5$

HD Gate diameter range: $\varnothing 1.5 \sim \varnothing 4.5$

HC 球頭半徑

HC Ball head radius: R10, R15, R19, R21

5. 編碼原則 Code principle

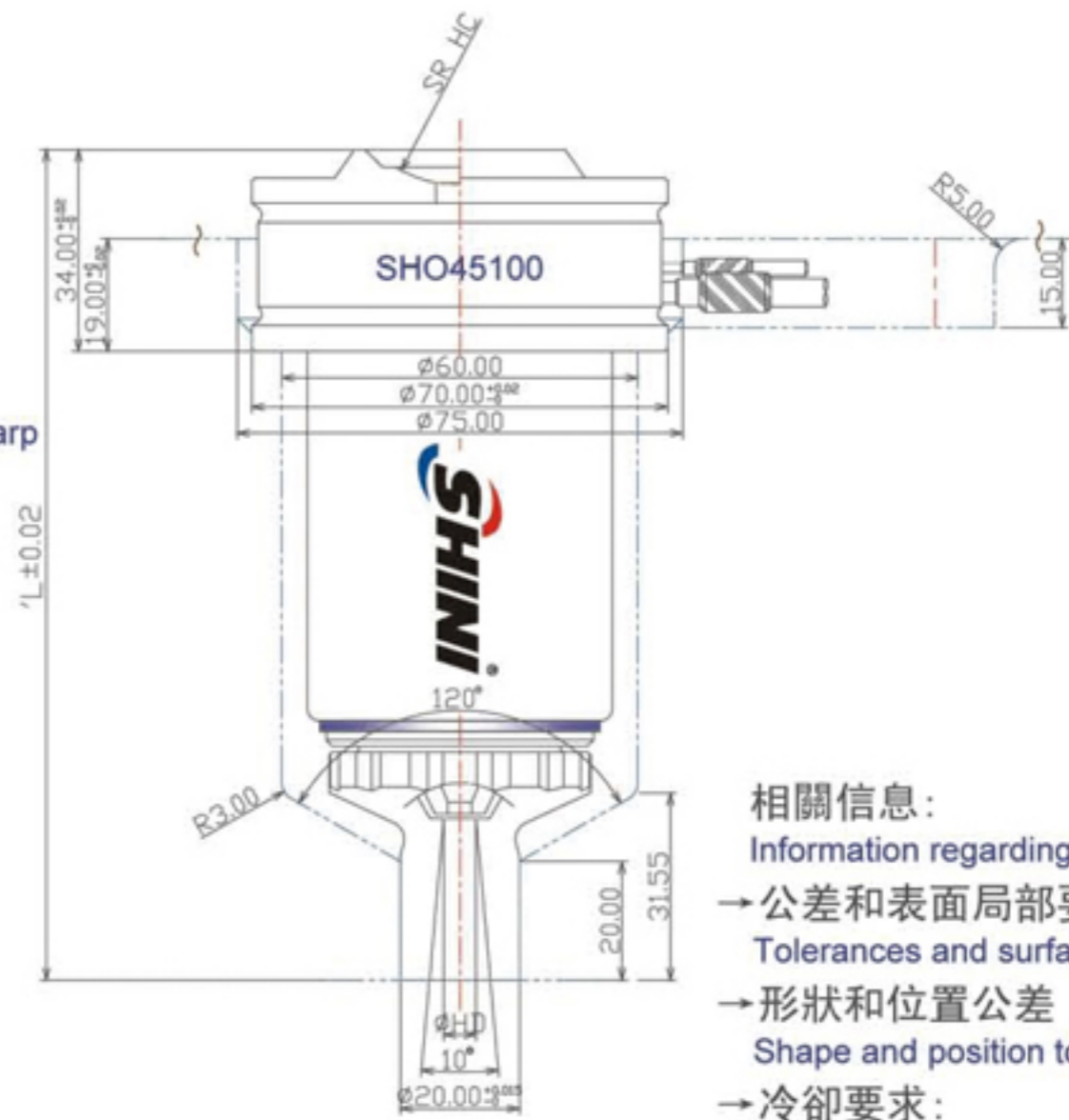

相關信息:

Information regarding:

→ 公差和表面局部要求
Tolerances and surfaces

→ 形狀和位置公差
Shape and position tolerance

→ 冷卻要求:
澆口區域、嘴頭區域
Cooling required: Gate bush and nozzle sharp

→ 封膠處的要求
The front of nozzle sharp must be against plastic

6. 熱嘴尺寸與功率的選擇 Nozzle size and power selection

熱嘴尺寸 Nozzle size(L)	熱嘴膨脹量(單位:mm) Nozzle expansion(Unit:mm)			加熱器功率 Heater(Watt)	感溫線型號 T/C(J/K)
	200℃	250℃	300℃		
SHO45100	0.089	0.111	0.133	SHCH45035400	SHT15100J/K
SHO45120	0.137	0.171	0.205	SHCH45055500	SHT15100J/K
SHO45140	0.185	0.231	0.277	SHCH45075650	SHT15100J/K
SHO45160	0.233	0.291	0.349	SHCH45095850	SHT15100J/K
SHO45180	0.281	0.351	0.421	SHCH45115950	SHT15150J/K
SHO45200	0.329	0.411	0.493	SHCH45135950	SHT15150J/K