

## 1. Assembly Drawing

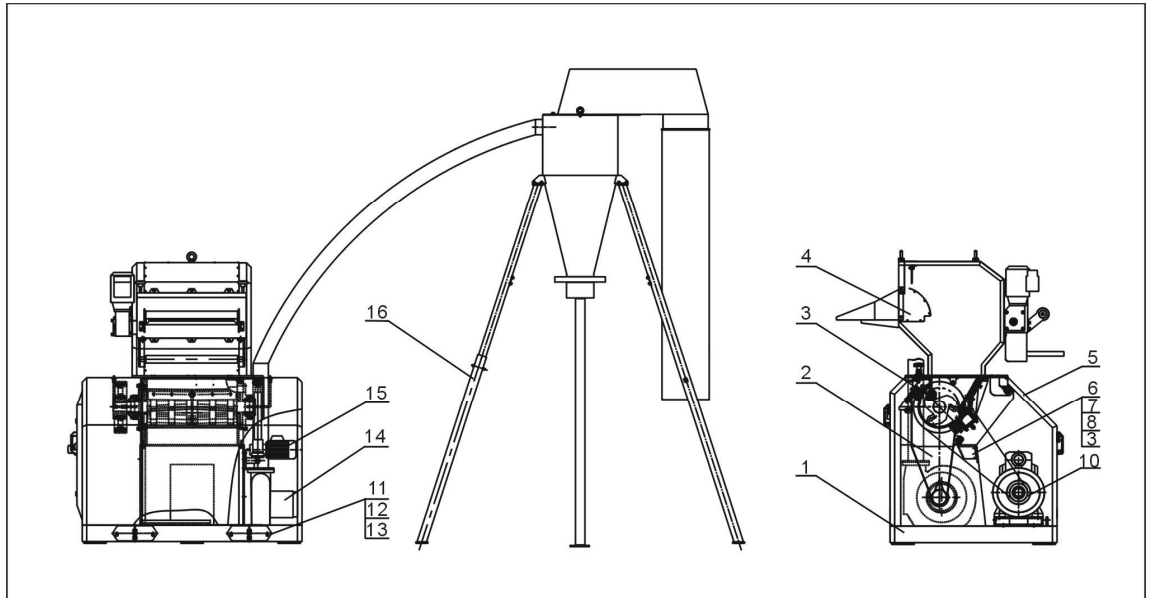

Note: Please refer to material list 2 about the parts code.

## 2. Parts List

No.	Name	SGF-2660		SGF-2690	
		Part No.	Quantity	Part No.	Quantity
1	Rack assembly	-	1	-	1
2	Screen bracket assembly	-	1	-	1
3	Cutting chamber assembly	-	1	-	1
4	Feed box assembly	-	1	-	1
5	Shield assembly	-	1	-	1
6	Screen bracket confine board	-	1	-	1
7	Hexagonal head bolt M6x20	YW60062000100	4	YW60062000100	4
8	Hexagonal nut M6	YW64000600000	4	YW64000600000	4
9	Flat gasket 6	YW66061200000	4	YW66061200000	4
10	Drive assembly	-	1	-	1
11	Suspending span cover	-	1	-	1
12	Inner hexagon column screw M8x20	YW61082000000	4	YW61082000000	4
13	Flat gasket 8	YW66081600000	4	YW66081600000	4
14	Automatically feeding assembly	-	1	-	1
15	Electronic handspike assembly	-	1	-	1
16	Cyclone separator	-	1	-	1

Please confirm the version of manual before placing the purchase order to guarantee that the item number of the spare part is in accordance with the real object.

### 3. Cutting Chamber

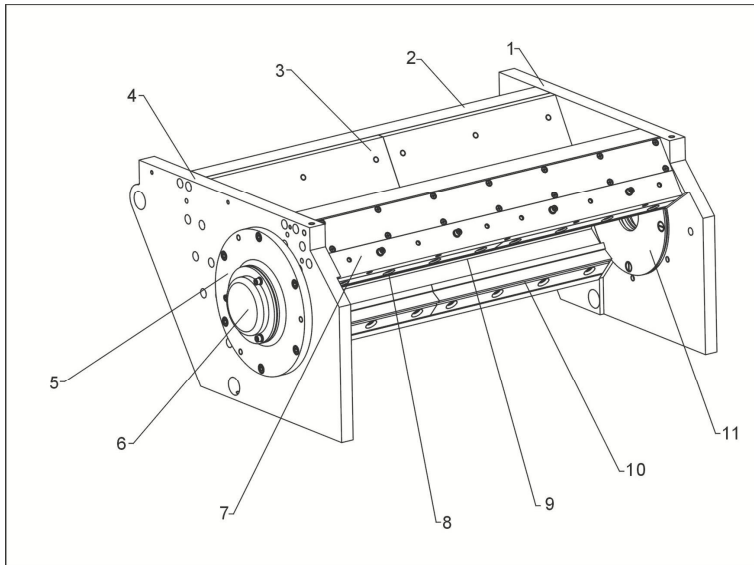

Note: Please refer to material list 4 about the parts code.

### 4. Cutting Chamber Parts List

No.	Name	SGF-2660		SGF-2690	
		Part No.	Quantity	Part No.	Quantity
1	Right block	-	1	-	1
2	Back block	-	1	-	1
3	Material fending press plate	-	2	-	2
4	Left block	-	1	-	1
5	Bearing block	-	2	-	2
6	Bearing cover	-	2	-	2
7	Front block	-	1	-	1
8	Front pressing block	-	2	-	2
9	Fixed blade	-	6	-	6
10	Back pressing block	-	2	-	2
11	Material fender	-	2	-	2

## 5. Blade Rest

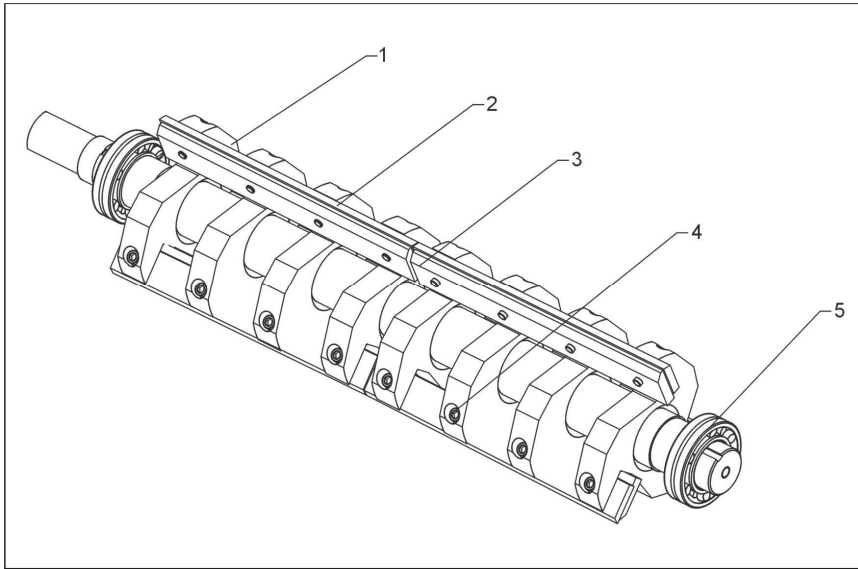

Note: Please refer to material list 6 about the parts code.

## 6. Blade Rest Parts List

No.	Name	SGF-2660		SGF-2690	
		Part No.	Quantity	Part No.	Quantity
1	Blade rest	-	6	-	8
2	Rotating blade	-	6	-	6
3	Pressing plate of rotating blade	-	6	-	6
4	Inner hexagon column screw M12x50	YW61102500000	18	YW61102500000	24
5	Self-aligning roller bearing 22214 TN1/W33	-	2	-	2

## 7. Transmission Parts

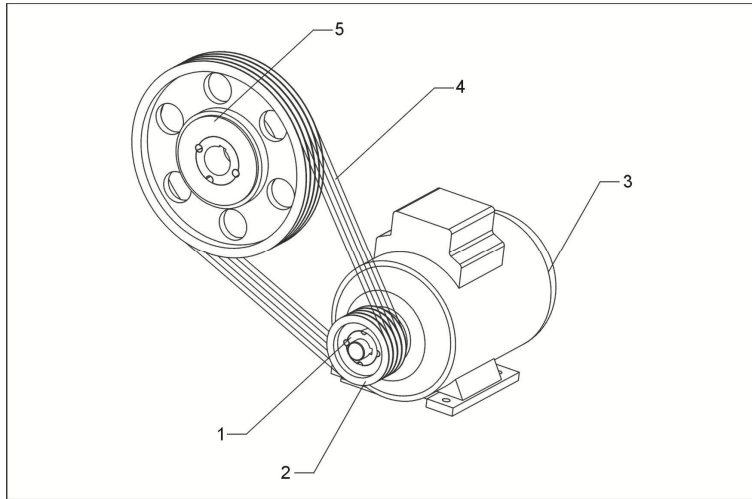

Note: Please refer to material list 8 about the parts code.

## 8. Transmission Parts List

No.	Name	SGF-2660		SGF-2690	
		Part No.	Quantity	Part No.	Quantity
1	Taper sleeve	-	1	-	1
2	Motor belt pulley	-	1	-	1
3	motor	-	1	-	1
4	Triangle belt	-	1	-	1
5	Big belt pulley	-	1	-	1

## 9. Screen and Its Frame

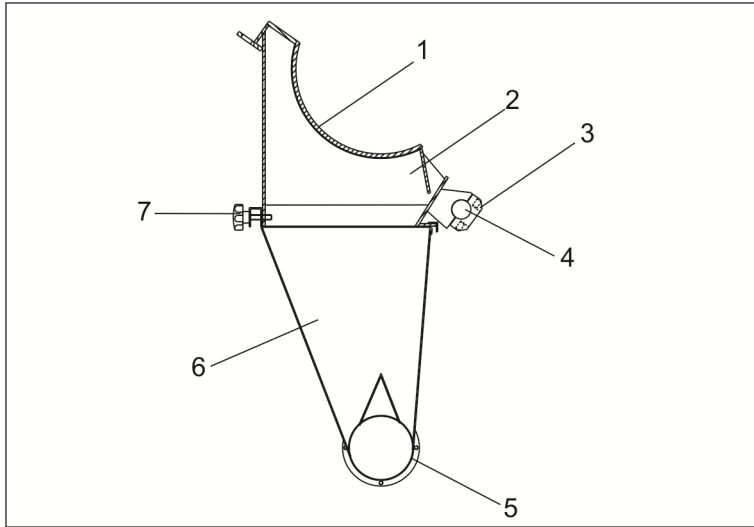

Note: Please refer to material list 10 about the parts code.

## 10. Screen and Its Bracket Parts List

No.	Name	SGF-2660		SGF-2690	
		Part No.	Quantity	Part No.	Quantity
1	Screen	-	1	-	1
2	Assembly of screen bracket	-	1	-	1
3	Screen bracket shaft cover	-	2	-	3
4	Screen bracket shaft	-	1	-	1
5	Air inlet flange	-	1	-	1
6	Storage box	-	1	-	1
7	Star knob	YR40083500000	2	YR40083500000	2

## 11. Feeding device

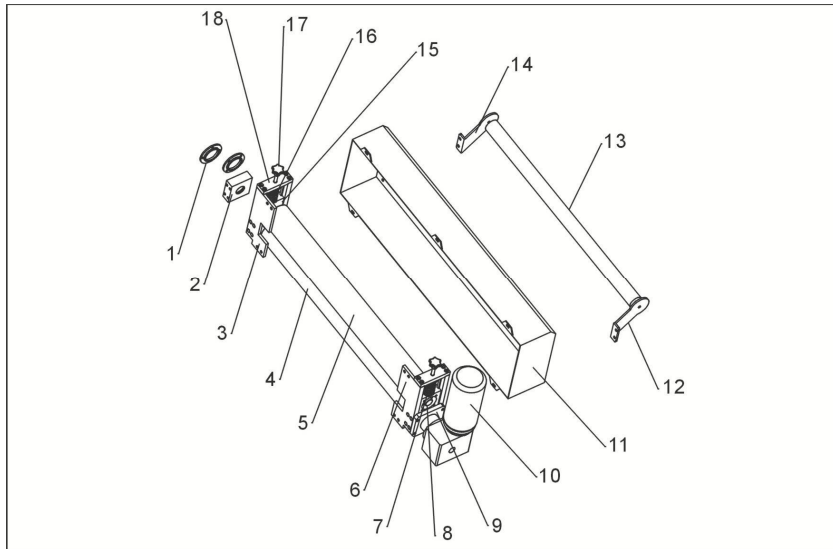

Note: Please refer to material list 12 about the parts code.

## 12. Feeding Device Parts List

No.	Name	SGF-2660		SGF2690	
		Part No.	Quantity	Part No.	Quantity
1	Bearing cover	-	3	-	3
2	Fixed bearing block	-	2	-	2
3	Left mounting plate	-	1	-	1
4	Driving feed roller	-	1	-	1
5	Passive feed roller	YW09269000100	1	YW09269000100	1
6	Right mounting plate	-	1	-	1
7	Pressure spring	-	2	-	2
8	Deep groove ball bearing 6206	YW11620600200	4	YW11620600200	4
9	Gearmotor connection plate	-	1	-	1
10	Gearmotor	-	1	-	1
11	Feeding device cover	-	1	-	1
12	Right mounting plate of running roller	-	1	-	1
13	Running roller	YW09269000000	1	YW09269000000	1
14	Left mounting plate of running roller	-	1	-	1
15	Left mounting plate of frame	-	2	-	2
16	Pressure spring block	-	2	-	2
17	Star knob M12x70	BH11127000010	2	BH11127000010	2
18	Frame top board	-	2	-	2